

**OWNER'S CERTIFICATE**

THE SUBDIVISION OF LAND SHOWN ON THIS PLAT AND KNOWN AS FORD'S COLONY @ WILLIAMSBURG, SECTION XII, IS WITH THE FREE CONSENT AND IN ACCORDANCE WITH THE DESIRE OF THE UNDERSIGNED OWNERS, PROPRIETORS, AND/OR TRUSTEES.

*D. Mulhale*  
DREW R. MULHALE FOR REALTEC, INCORPORATED

4/15/03  
DATE

**CERTIFICATE OF NOTARIZATION**

STATE OF VA. CITY/COUNTY OF James City  
TO WIT: I, Pamela B. Callis  
A NOTARY PUBLIC IN AND FOR THE CITY/COUNTY AND STATE AFORESAID, DO HEREBY CERTIFY THAT THE PERSON WHOSE NAME IS SIGNED TO THE FOREGOING WRITING HAS ACKNOWLEDGED THE SAME BEFORE ME IN MY CITY/COUNTY AND STATE AFORESAID.  
GIVEN UNDER MY HAND THIS 15 DAY OF April, 2003.  
MY COMMISSION EXPIRES 0/31/06  
Pamela B. Callis  
SIGNATURE

**CERTIFICATION OF SOURCE OF TITLE**

THE LAND EMBRACED IN THIS SUBDIVISION IS IN THE NAME OF REALTEC INCORPORATED, AND IS SUCCESSOR BY MERGER TO FORD'S COLONY @ WILLIAMSBURG BY DEED DATED DECEMBER 19, 1986 AND DULY RECORDED IN THE CLERK'S OFFICE OF THE CIRCUIT COURT OF JAMES CITY COUNTY IN DEED BOOK 325, PAGE 394.

**ENGINEER OR SURVEYOR'S CERTIFICATE**

I HEREBY CERTIFY THAT TO THE BEST OF MY KNOWLEDGE AND BELIEF, THIS PLAT COMPLIES WITH ALL OF THE REQUIREMENTS OF THE BOARD OF SUPERVISORS AND ORDINANCES OF THE COUNTY OF JAMES CITY, VIRGINIA, REGARDING THE PLATTING OF SUBDIVISIONS WITHIN THE COUNTY.

*G. T. Wilson, Jr.*  
G. T. WILSON, JR. C.L.S.

12/30/02  
DATE

**CERTIFICATE OF APPROVAL**

THIS SUBDIVISION IS APPROVED BY THE UNDERSIGNED IN ACCORDANCE WITH EXISTING SUBDIVISION REGULATIONS AND MAY BE ADMITTED TO RECORD.

*[Signature]*  
SUBDIVISION AGENT OF  
JAMES CITY COUNTY

4/15/03  
DATE

STATE OF VIRGINIA  
COUNTY OF JAMES CITY

IN THE CLERK'S OFFICE OF THE CIRCUIT COURT OF THE COUNTY OF JAMES CITY, THIS 16 DAY OF April, 2003 THE MAP SHOWN HEREON WAS PRESENTED AND ADMITTED TO THE RECORD AS THE LAW DIRECTS. @ 12:29 PM

TESTE: Betsy B. Woolridge  
*[Signature]*  
CLERK  
BY Blaine S. Berkley Dep. Clerk  
PLAT BOOK 90, PAGE 23-25

**INDEX OF SHEETS**

1. COVER SHEET
2. LOTS 2-17, 33-38, 42-66, GENERAL NOTES, AREA TABULATIONS
3. LOTS 18-32, 41, 67-72, CURVE TABLES

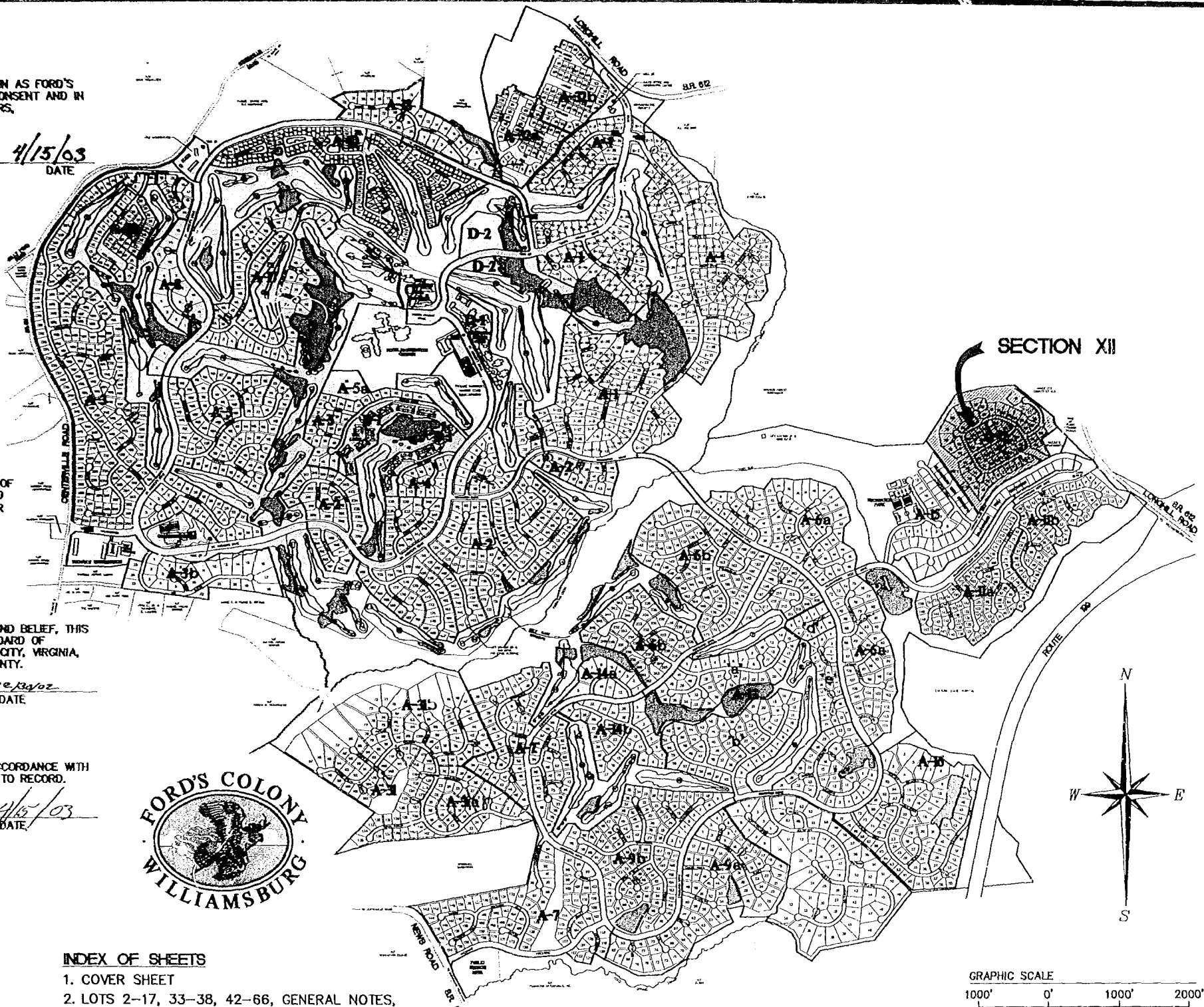
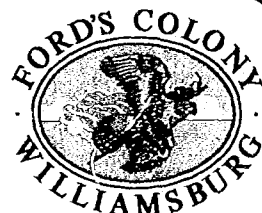

SECTION XII

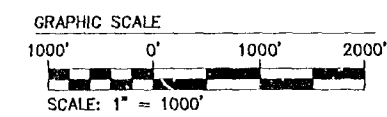
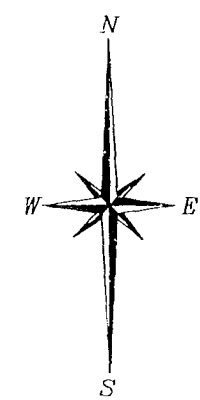

City of Williamsburg & County of James City  
Circuit Court: This PLAT was recorded on 16 April 2003 at 12:29 A.M. P.M. PB 90 PG. 23-25  
DOCUMENT # 030011451  
BETSY B. WOOLRIDGE, CLERK

| No. | DATE    | REVISION / COMMENT / NOTE               | BY  |
|-----|---------|---|-----|
| 4   | 4/15/03 | REVISION TO FUTURE DEVELOPMENT          | CBR |
| 3   | 4/10/03 | REVISED PER JCC ENVIRONMENTAL REQUEST   | CBR |
| 2   | 3/3/03  | REVISION PER JCC COMMENTS DATED 2/27/03 | CBR |
| 1   | 2/19/03 | REVISION PER JCC COMMENTS DATED 1/24/03 | CBR |

| Designed CBR | Drawn LBA |
|--------------|-----------|
| Scale        | Date      |
| 1"=1000'     | 12/30/02  |
| Project No.  |           |
| 5652-12      |           |
| Drawing No.  |           |
| 1 OF 3       |           |

5C 5212p01.dwg  
04.15.03-14:01  
LBA

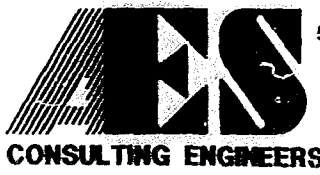

5248 Olde Towne Road, Suite 1  
Williamsburg, Virginia 23188  
(757) 253-0040  
Fax (757) 220-8994

PLAT OF SUBDIVISION  
SECTION XII  
LOTS 2-38 AND 41-72  
**FORD'S COLONY**  
@ **WILLIAMSBURG**  
POWhatan DISTRICT JAMES CITY COUNTY VIRGINIA

