

030544

89 PAGE 83

JAMES CITY COUNTY TP 33-3-01-27
NOW OR FORMERLY
ARTCRAFT - STRATFORD, L.C.
D.B. 649 P. 470

JAMES CITY COUNTY TP 33-3-01-28
NOW OR FORMERLY
GARY E. & CATHY L. NESTER
D.B. 509 P. 735

JAMES CITY COUNTY TP 33-3-01-23
NOW OR FORMERLY
GARY E. & CATHY L. NESTER
D.B. 619 P. 683

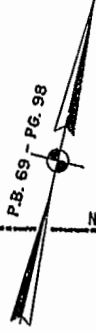

N77°32'26"E 479.30' N76°09'49"E 276.18' N76°09'00"E 189.90' N76°09'05"E 322.06'

MATCH LINE
SEE SHEET 4

MATCH LINE
SEE SHEET 2

ADDITIONAL LAND

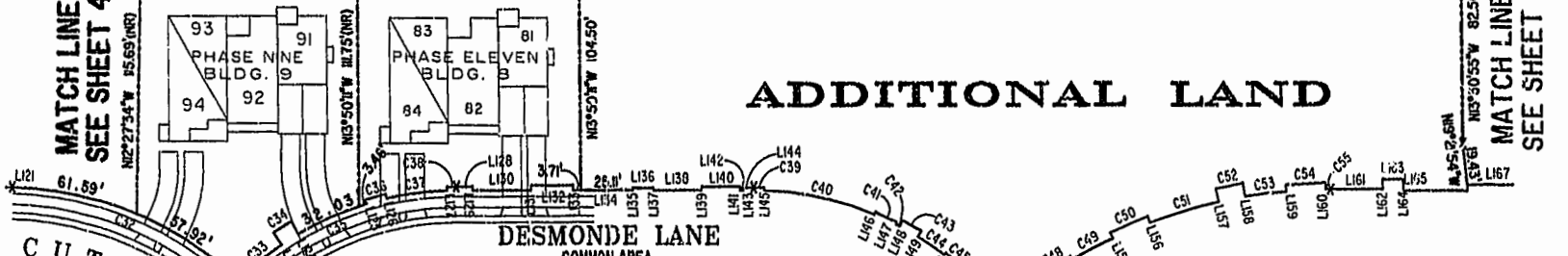

DESMONDE LANE
COMMON AREA

PHASE
TWELVE
BLDG. 19
SEE DETAIL ON SHEET 1

ADDITIONAL LAND

ADDITIONAL LAND

SEE SHEET 2
RAVEN TERRACE

MATCH LINE
SEE SHEET 4

MATCH LINE

City of Williamsburg & County of James City
Circuit Court: This PLAT was recorded on
MARCH 12, 2003
at 1:32 PM P.B. 89 PG. 81-85
DOCUMENT # 030544
BETSY B. WOOLRIDGE, CLERK
Betsy B. Woolridge Clerk

TP 281-10-00-B
NOW OR FORMERLY
752 L.L.C.
INST. #980305

TP 282-08-00-001
NOW OR FORMERLY
752 L.L.C.
INST. #980305

TP 281-10-00-B
NOW OR FORMERLY
752 L.L.C.
INST. #980305

TP 282-08-00-001
NOW OR FORMERLY
752 L.L.C.
INST. #980305

GRAPHIC SCALE: 1" = 50'

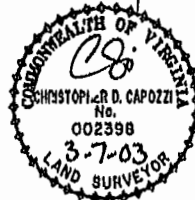
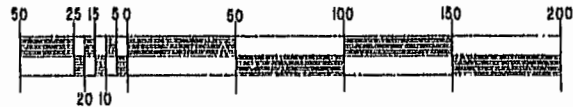

EXHIBIT "A"
CLAIBORNE
(A CONDOMINIUM COMMUNITY)
PHASE TWELVE

Hassell & Polkes, P.C. Engineers Surveyors Planners Chesapeake, VA 23320 (757) 547-9531		SIZE C	CONTRACT NO 752 L.L.C.	FILE NAME SVP\PLATS\CLAIBORNE\PH12-BLDG-19.DWG	REV.
SCALE: 1" = 50'		DATE: 02/13/03	SHEET 3 of 5		

A-1520

A-1520