

JAMES CITY COUNTY TP 33-3-01-29
NOW OR FORMERLY
GARY E. & CATHY L. NESTER
D.B.619 P.683

JAMES CITY COUNTY TP 33-3-01-24
NOW OR FORMERLY
GOLDEN KNIGHTS, INC.
D.B.568 P.316

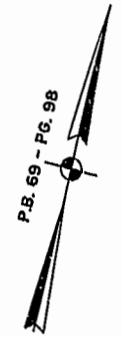

MATCH LINE
SEE SHEET 3

ADDITIONAL LAND

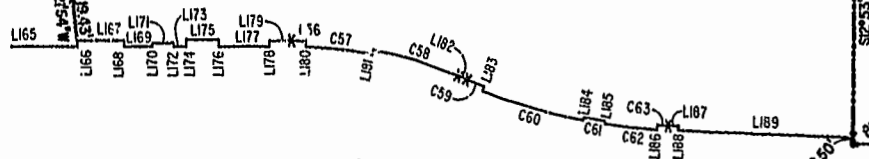

MATCH LINE

SEE SHEET 3

RAVEN TERRACE
VAR. WIDTH UTILITY & INGRESS/EGRESS ESMT.
COMMON AREA

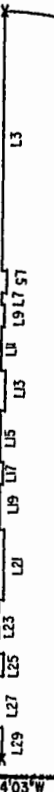

ADDITIONAL LAND

CLAIBORNE DRIVE
VAR. WIDTH UTILITY & INGRESS/EGRESS ESMT.
COMMON AREA

CHELSEA GCA REALTY PARTNERSHIP, L.P.
TP 202-04-00-001
NOW OR FORMERLY
D.B.105 P.467

DETAIL
N.T.S.

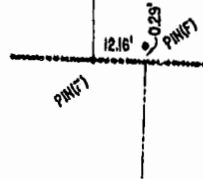

TP 252-01-00-010

TP 252-01-00-009
NOW OR FORMERLY
MARK II INVESTMENTS LTD.
D.B.130 P.671

TP 252-01-00-008

N76°27'47"E 321.22'

S78°27'47"W 408.02'
321.16'

COMMON AREA - PHASE ONE

308.40'
S78°27'39"W 320.56'

TP 202-05-00-001
NOW OR FORMERLY
CHELSEA GCA REALTY PARTNERSHIP, L.P.
D.B.113 P.693

U.S. RTE. 60
RICHMOND ROAD
P.B. 69 - PG. 98

S80°09'04"W 249.17' FLD
S77°14'03"W 150.89'

TP 202-08-00-001
NOW OR FORMERLY
752 L.L.C.
INST. #900305

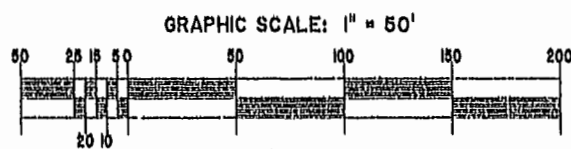

City of Williamsburg & County of James City
Circuit Court: This PLAT was recorded on
12 Dec 2002
at 11:24 AM/PM; PB 88 PG 87-91
DOCUMENT # 022260
BETSY B. WOOLFRIDGE, CLERK
Betsy Woolfidge Dep. Clerk

EXHIBIT "A"
CLAIBORNE
(A CONDOMINIUM COMMUNITY)
PHASE ELEVEN

Hassell & Folkes, P.C. Engineers Surveyors Planners Chesapeake, VA 23320 (757)547-9531	SCALE: 1" = 60'	DATE: 11/27/02	SHEET 2 of 8
---	-----------------	----------------	--------------