

SECTION 8
SCALE: 1" = 8'

AREA TABULATION - BASEMENT

BASEMENT STORAGE	372.40 SQ. FT.±
COMMON ELEMENT (C.E.) - WALLS, CHIMNEY & UTILITY ROOMS	2026.00 SQ. FT.±
CRAWL SPACE	5107.15 SQ. FT.±
TOTAL AREA BASEMENT	7605.55 SQ. FT.±

WE HEREBY CERTIFY THAT WE HAVE SURVEYED ALL OF THE UNITS OR PORTIONS WHEREOF AND DO FURTHER CERTIFY THAT THESE PLANS ARE ACCURATE AND THEY COMPLY WITH SECTION 55-79.58(B) OF THE CODE OF VIRGINIA, AS AMENDED. ALL STRUCTURES ARE COMPLETE.

AES CONSULTING ENGINEERS
BY: *G. T. Wilson, Jr.*
G. T. WILSON, JR., C.E.S.

(C.E.) = COMMON ELEMENT

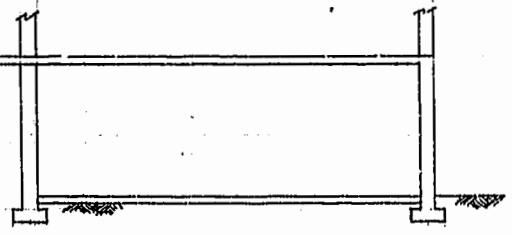
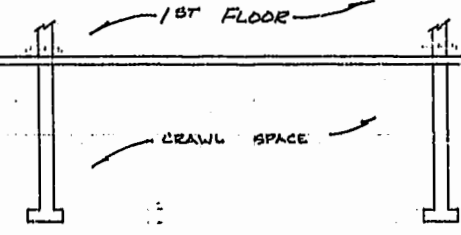
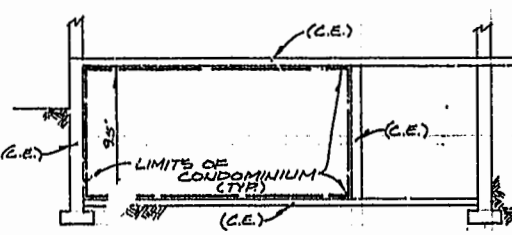

SECTION 7
SCALE: 1" = 8'

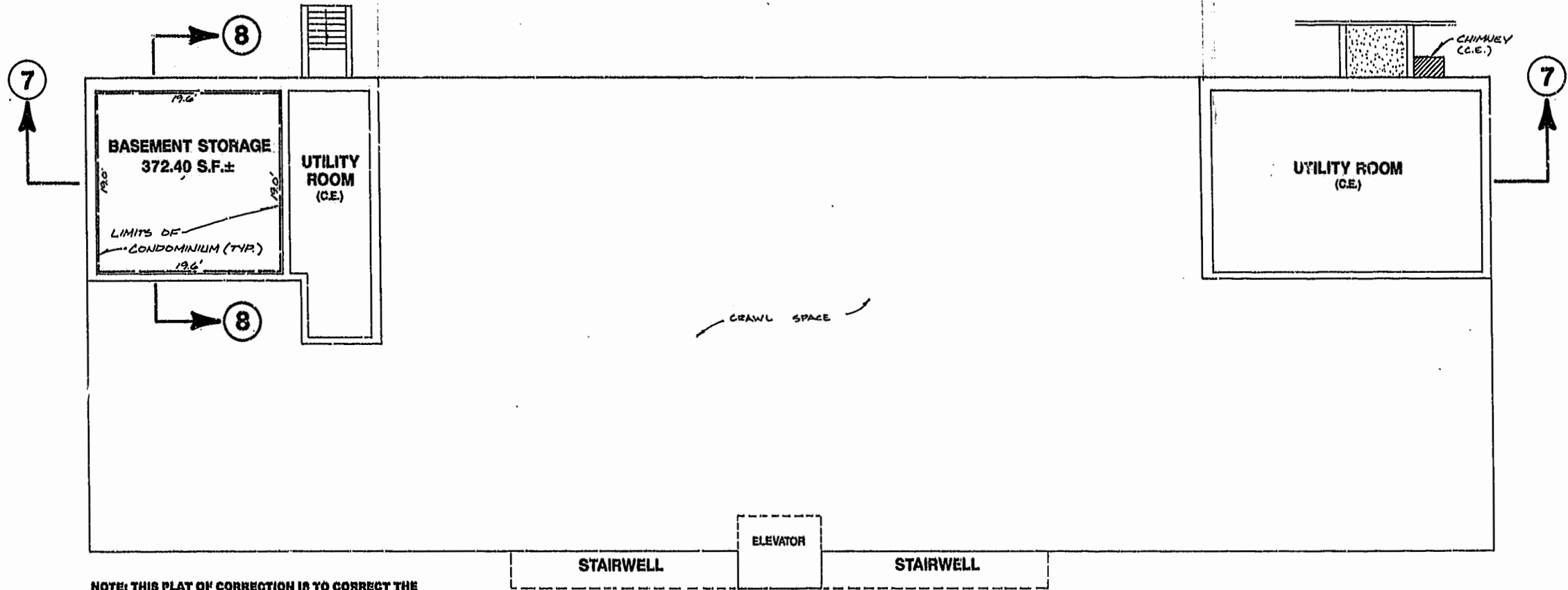

NOTE: THIS PLAT OF CORRECTION IS TO CORRECT THE AREA OF SUITE 1-B. THIS IS THE ONLY CORRECTION MADE TO THE PLAT AS RECORDED IN PLAT BOOK 58, PAGE 19-22.

PLAN VIEW - BASEMENT
SCALE: 1" = 8'

#022004

88 PAGE 34

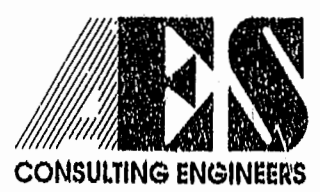

5248 Olde Towne Road, Suite 1
Williamsburg, Virginia 23188
(804) 253-0040
Fax (804) 220-8994

PLAT OF CORRECTION
EXHIBIT B
WILLIAMSBURG PROFESSIONAL CENTRE CONDOMINIUMS
OWNER/ DEVELOPER: ALVIN P. ANDERSON, TRUSTEE
CITY OF WILLIAMSBURG VIRGINIA

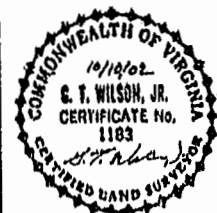

City of Williamsburg & County of James City	
Circuit Court:	This PLAT was recorded on
	8 Nov 2002
at 10:23 AM	AM/PMT. PB. 88 PG. 36-39
DOCUMENT #	022004
PETSY B. WOOLRIDGE, CLERK	
	<i>G. T. Wilson, Jr.</i> Prop. Clerk
No.	DATE
	REVISION / COMMENT / NOTE
	BY

Designed AES	Drawn RWE
Scale NOTED	Date 10/10/02
Project No. 7240	
Drawing No. 4 OF 4	