

#021688

87 PAGE 68

NOTES:

1. THE TOTAL AREA OF SITE IS 644,256 SQ.FT. (14.790 AC.) OF WHICH 395,287 SQ.FT. (9.074 AC.) IS ADDITIONAL LAND.
2. THE AREA OF THE SUBMITTED LAND IS 249,969 SQ.FT. (5.716 AC.)
3. THE COMMON AREA IS TO BE THE RESPONSIBILITY OF THE CONDOMINIUM ASSOCIATION AND HAS A TOTAL AREA OF 4.436 AC.

BUILDING NUMBER	UNIT NUMBER	UNIT TYPE*	STREET ADDRESS
12	12-121	D	121 CUTSPRING ARCH
12	12-122	C(OPTION)	122 CUTSPRING ARCH
12	12-123	A3	123 CUTSPRING ARCH
12	12-124	E3	124 CUTSPRING ARCH

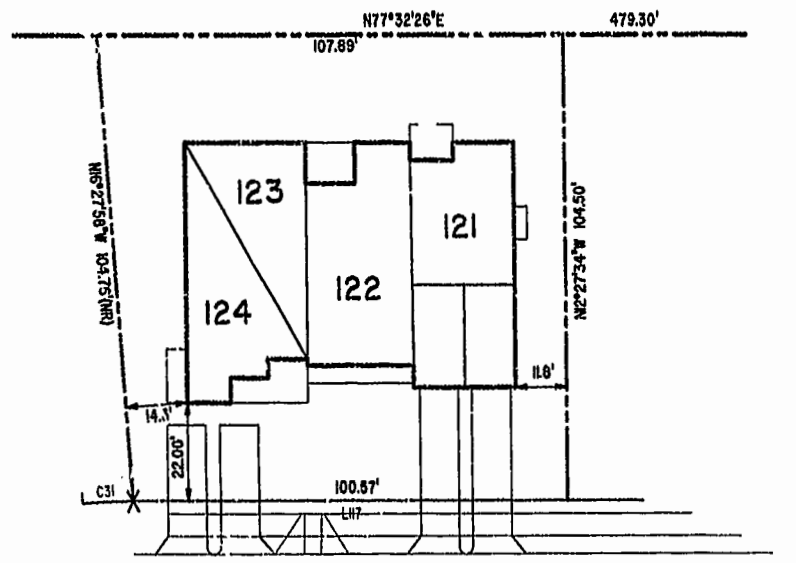
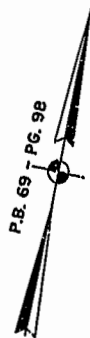
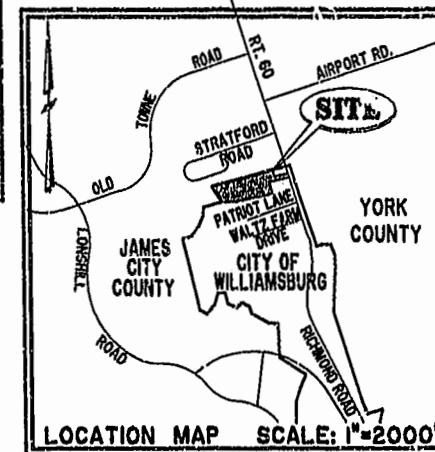

VAR. WIDTH UTILITY & INGRESS/EGRESS ESMT.

CUTSPRING ARCH
COMMON AREA

**PHASE FIVE
BLDG. 12**

AREA = 10,892 SQ. FT. = 0.250 AC.

SCALE: 1" = 25'

City of Williamsburg & County of James City
Circuit Court: This PLAT was recorded on
September 17, 2002
at 10:25 AM, PH 877 PCLB-72
DOCUMENT # 021688
BETSY B. WOOLRIDGE, CLERK
C. Allen Fall, Dep. Clerk

I CHRISTOPHER D. CAPOZZI, A CERTIFIED LAND SURVEYOR, DO HEREBY CERTIFY THAT THIS PLAT IS ACCURATE, AND THAT IT COMPLIES WITH THE PROVISIONS OF SECTION 55 - 79.59A OF THE CODE OF VIRGINIA. I FURTHER HEREBY CERTIFY THAT ALL UNITS OR PORTIONS THEREOF DEPICTED HEREON HAVE BEEN SUBSTANTIALLY COMPLETED.

THE UNDERSIGNED CERTIFIED LAND SURVEYOR CERTIFIES THAT HE HAS READ SECTION 55 - 79.59B OF THE CODE OF VIRGINIA, AND FINDS THESE PLANS TO BE ACCURATE AND IN COMPLIANCE WITH THE CODE. I FURTHER CERTIFY THAT ALL UNITS OR PORTIONS THEREOF DEPICTED HEREON HAVE BEEN SUBSTANTIALLY COMPLETED.

9-9-02
DATE

LAND SURVEYOR No. 002398

				DRAWN BY: HJS DATE: 08/21/02		EXHIBIT "A" CLAIBORNE (A CONDOMINIUM COMMUNITY) PHASE FIVE CITY OF WILLIAMSBURG, VIRGINIA	
		GOMP BY: HBA DATE: 08/31/01		CHECKED BY: HBA DATE: 08/26/02			
SIZE: C	CONTRACT NO: 90132	DISK/BOX: 114F/16	FILENAME: PH-5-BLDG-12.DWG	REV.			
SCALE: N/A		DATE: 08/21/02		SHEET 1 of 5			

A-1520

A-1520