

#021288

86 PAGE 97

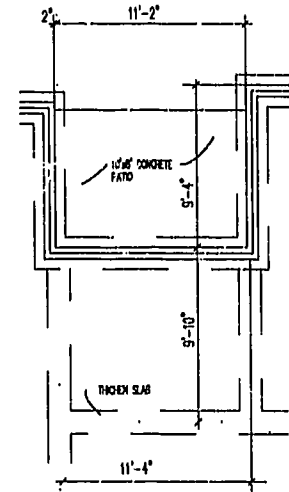
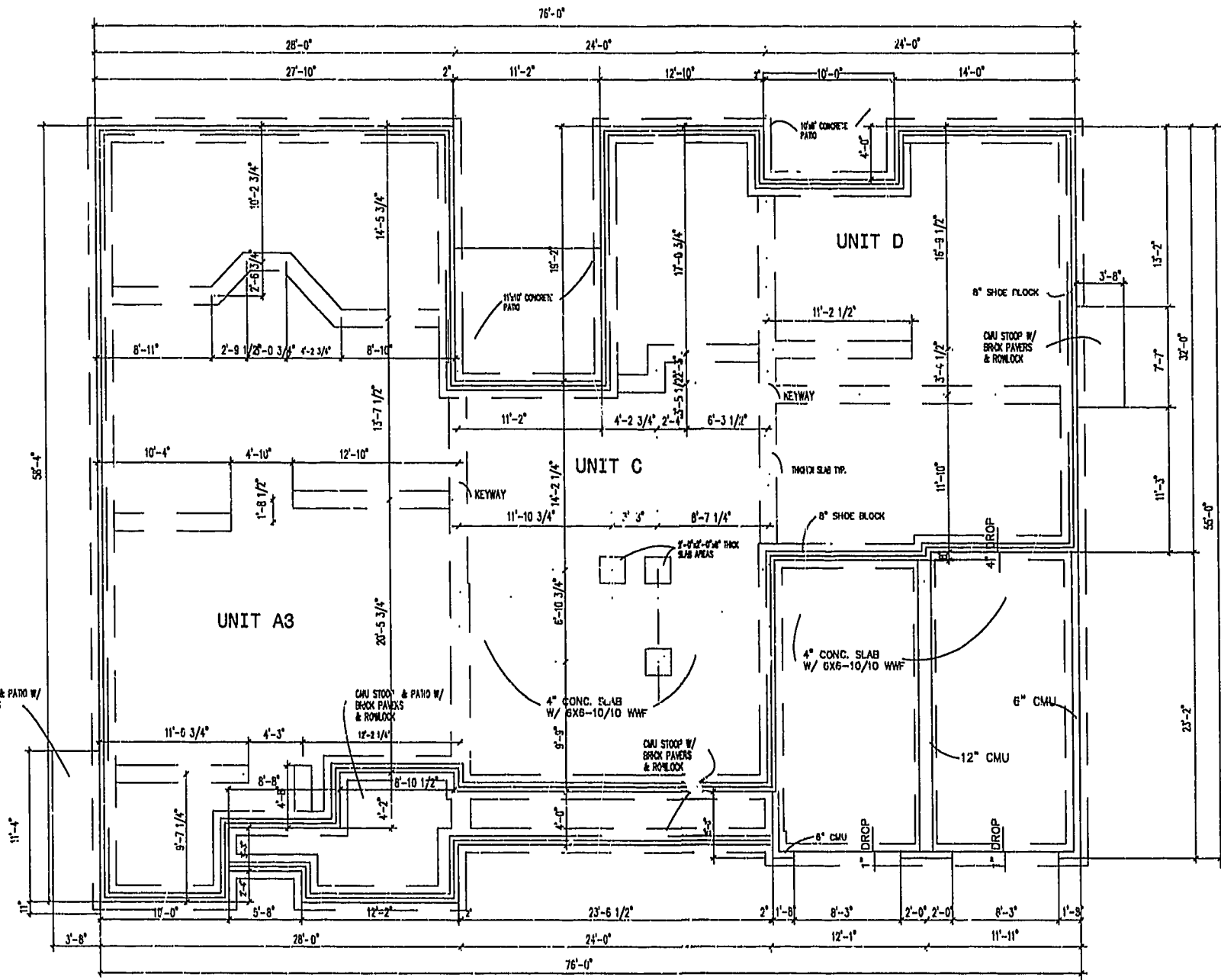

FOUNDATION PLAN  
NOT TO SCALE

City of Williamsburg & County of James City  
Circuit Court: This PLAT was recorded on  
22 July 2002  
at 10:27 AM AM/PM: PG. 16 PG. 22-10  
DOCUMENT # 021288  
BETSY B. WOOLRIDGE, CLERK  
*Betsy Woolridge* Dep. Clerk

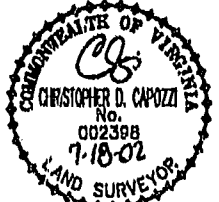

NOTE: ARCHITECTURAL PLANS PREPARED BY BEN ADDERHOLDT - ARCHITECT.

EXHIBIT "A"  
CLAIBORNE  
(A CONDOMINIUM COMMUNITY)  
PHASE TWO

Hassell & Folkes, P.C. Engineers Surveyors Planners Chesapeake, VA 23320 (757) 547-9531	SIZE: C	CONTRACT NO: 114C/16	DISK/BOX: 114C/16	FILENAME: PH-2-BLDG-13.DWG	REV.
CITY OF WILLIAMSBURG, VIRGINIA			SCALE: AS SHOWN	DATE: 07/10/02	SHEET 8 of 12

A-1520

A-1520