

NOW OR FORMERLY
COLLEGE OF WILLIAM & MARY

IRONBOUND

(APPROX. R/W)

ROAD

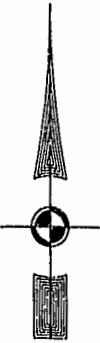

T.P. 372-(0A)-00-028
NOW OR FORMERLY
JEROME & EVELYN RANDOLPH
(D.B. 30, PG. 470)
ZONE: RM-2

T.P. 372-(0A)-00-030
NOW OR FORMERLY
JEROME & EVELYN RANDOLPH
(D.B. 37, PG. 379)
ZONE: RM-2

T.P. 372-(05)-00-001
NOW OR FORMERLY
CHESAPEAKE MEDIA, INC.
(D.B. 74, PG. 121)
(M.B. 42, PG. 25)
ZONE: B-2 CONDITIONAL

MATCH LINE
SEE SHEET 3

40' R/W
ROLAND STREET

MATCH LINE
SEE SHEET 3

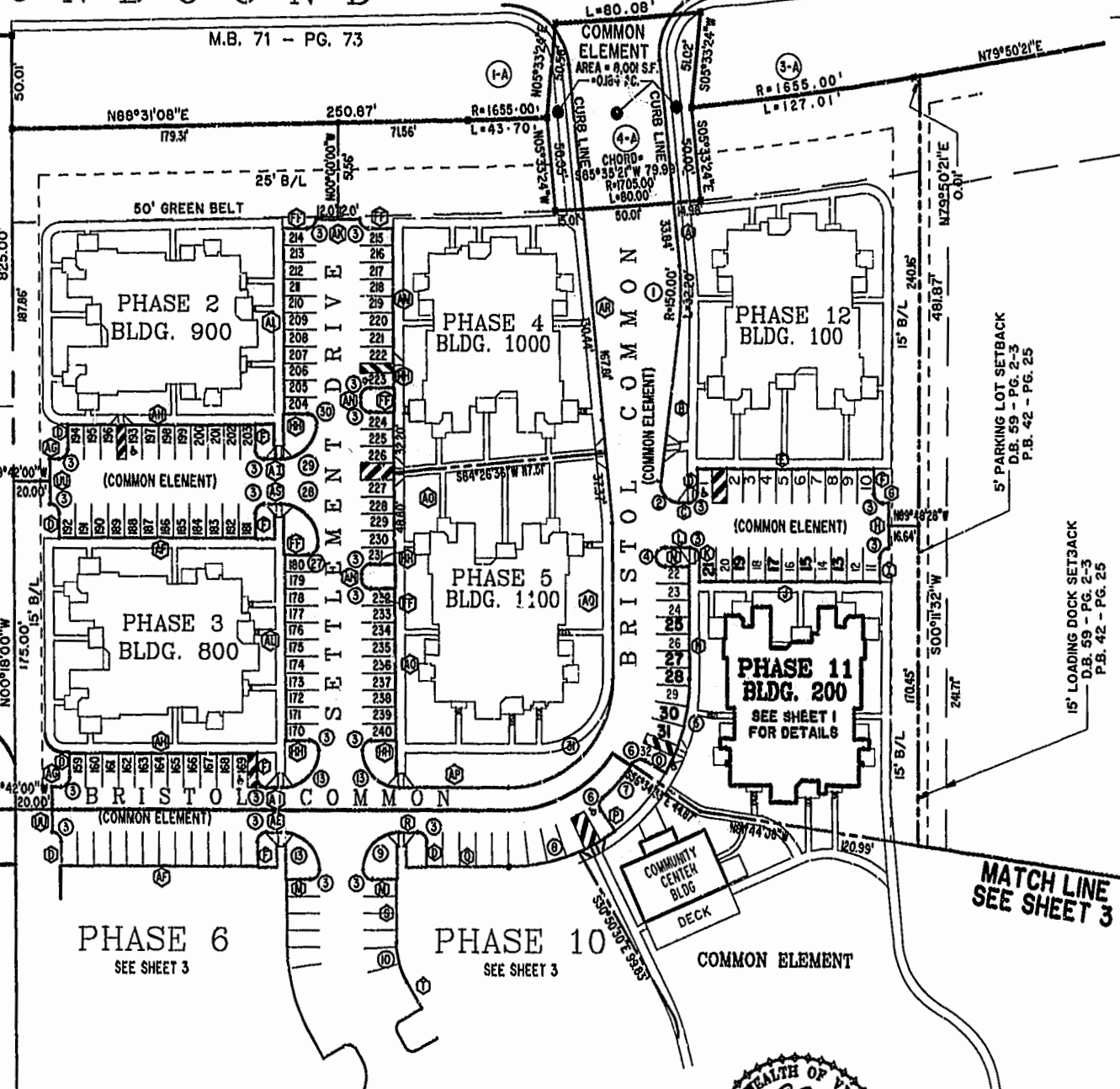

City of Williamsburg & County of James City
Circuit Court: This PLAT was recorded on
November 21, 2011
at 10:31 AM, PG. 3 PG. 28-70
DOCUMENT # 011807
BETSY B. WOOLRIDGE, CLF,AK
Betsy Woolridge, Dep. Clerk

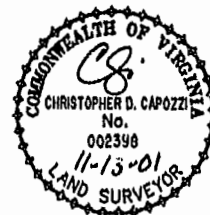

BRISTOL COMMONS
A CONDOMINIUM COMMUNITY
PHASE ELEVEN
FOR
KEY GROUP, LLC
CITY OF WILLIAMSBURG, VIRGINIA

Hassell & Polkes, P.C. Engineers Surveyors Planners Chesapeake, VA 23320 (757) 547-9531	SIZE: C CONTRACT NO: 03062	DISK/BOX: 123M/15	FILENAME: BRISTOL11.DWG	REV.
SCALE: 1"=50'	DATE: 11/05/01	SHEET 2 of 4		