

"GREENSPRINGS PLANTATION"
46-1-01-0-0001
(DB 322, PG 254)



EXIST. 20' JAMES CITY COUNTY SERVICE
AUTHORITY SAN. SEWER EASEMENT AS
SHOWN IN AS-BUILT LOCATION. D.B. 141 - PG. 388

EXIST. 20' DRAINAGE EASEMENT
M.B. 65 - PG. 2

MATCH LINE - SEE SHEET 5
N 76°02'42" E
286.07'
144.03'

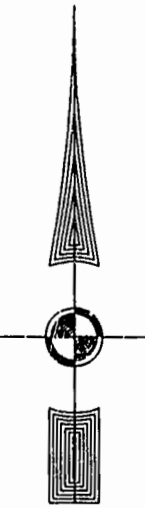
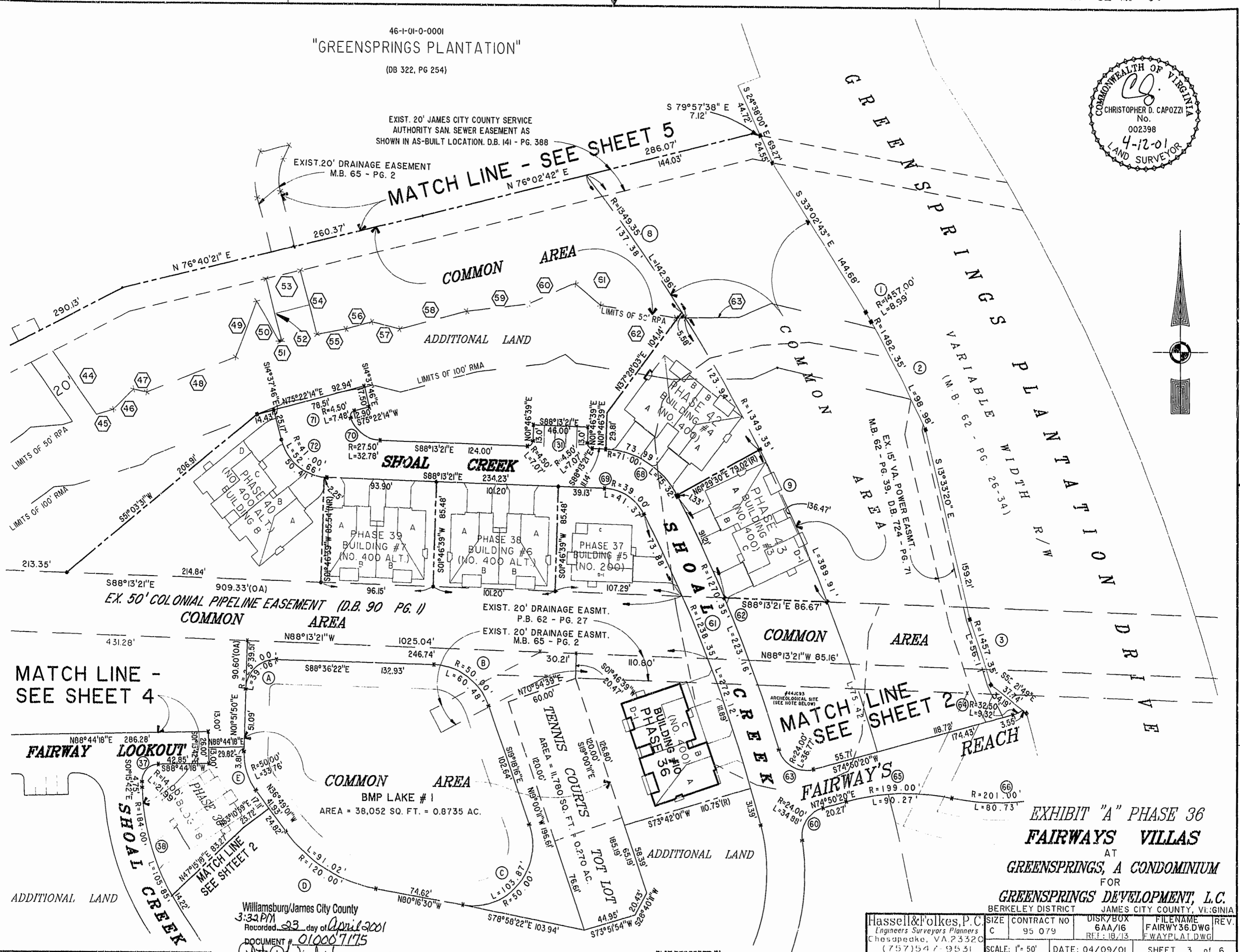

EX. 50' COLONIAL PIPELINE EASEMENT (D.B. 90 PG. 1)
COMMON AREA

MATCH LINE -
SEE SHEET 4

MATCH LINE
SEE SHEET 2

COMMON AREA
BMP LAKE # 1
AREA = 38,052 SQ. FT. = 0.8735 AC.

EXHIBIT "A" PHASE 36
FAIRWAYS VILLAS
AT
GREENSPRINGS, A CONDOMINIUM
FOR
GREENSPRINGS DEVELOPMENT, L.C.
BERKELEY DISTRICT JAMES CITY COUNTY, VIRGINIA

Williamsburg/James City County
3:32 PM
Recorded 23 day of April 2001
DOCUMENT # 010007175
Hetsy D. Woolridge Clerk
HETSY D. WOOLRIDGE, CLERK OF CIRCUIT COURT

Hassell & Folkes, P.C. Engineers Surveyors Planners Chesapeake, VA 23320 (757) 547-9531	SIZE CONTRACT NO C 95 079	DISK/BOX 6AA/16 REF: 19/13	FILENAME FAIRWY36.DWG FWAYPLA1.DWG	REV. SCALE: 1" = 50' DATE: 04/09/01 SHEET 3 of 6
--	------------------------------	----------------------------------	--	---