

COLLEGE OF WILLIAM & MARY

IRONBOUND

ROAD



T.P. 372--(0A)--00-028
NOW OR FORMERLY
JEROME & EVELYN RANDOLPH
(D.B. 30, PG. 470)
ZONE: RM-2

T.P. 372--(0A)--00-030
NOW OR FORMERLY
JEROME & EVELYN RANDOLPH
(D.B. 37, PG. 379)
ZONE: RM-2

T.P. 372--(05)--00-001
NOW OR FORMERLY
CHESAPEAKE MEDIA, INC.
(D.B. 74, PG. 121)
(M.B. 42, PG. 25)
ZONE: B-2 CONDITIONAL

MATCH LINE
SEE SHEET 3
40' R/W
ROLAND STREET

MATCH LINE
SEE SHEET 3

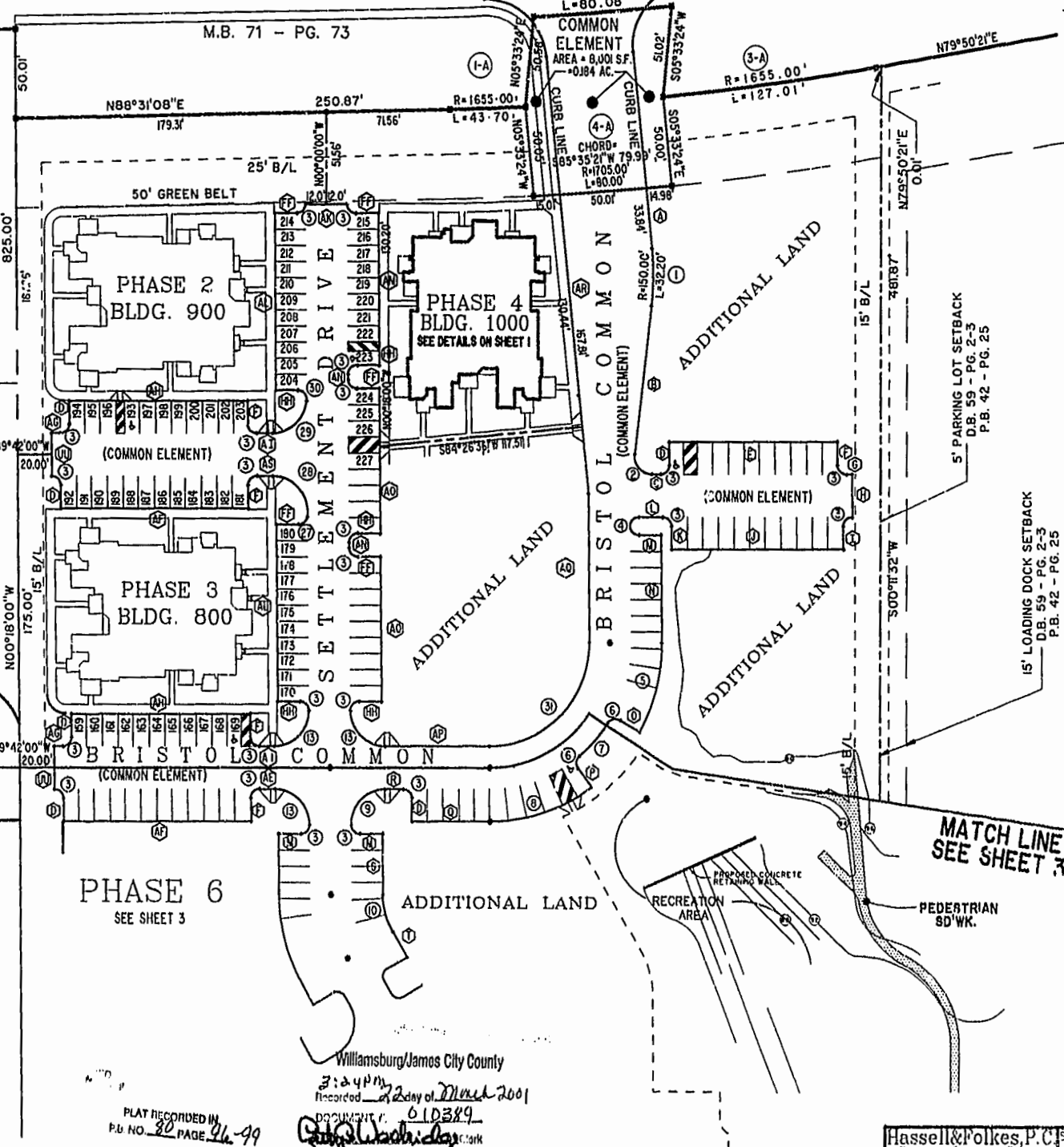

Williamsburg/James City County
Recorded 22 day of *March* 2001
DOCUMENT # 010329
RETSY B. WOOLLIJDE, CLERK OF CIRCUIT COURT

BRISTOL COMMONS
A CONDOMINIUM COMMUNITY
PHASE FOUR
FOR
KEY GROUP, LLC
CITY OF WILLIAMSBURG, VIRGINIA

Hassell & Polkes, P.C. Engineers Surveyors Planners Chesapeake, VA 23320 (757) 547-9531	CONTRACT NO. 98062	DISK/BOX 123F/1G	FILENAME BRISTOL4.DWG	REV.
SCALE: 1"=50'		DATE: 03/08/01		SHEET 2 of 4