

EXHIBIT B-5  
 SUPPLEMENTAL CONDOMINIUM PLAN  
 OF  
 WYNDHAM PLANTATION  
 CONDOMINIUM

WILLIAMSBURG, VIRGINIA  
 SCALE: 1"=10' JANUARY 23, 2001  
 JOHN E. SIRINE AND ASSOCIATES, LTD.  
 SURVEYORS • ENGINEERS • PLANNERS  
 VIRGINIA BEACH, VIRGINIA  
 (757) 486-4910

FIRST FLOOR - BUILDING 16

SCALE: 1"=10'

NOTES:

- BUILDING DIMENSIONS SHOWN HEREON ARE INTERIOR DIMENSIONS. THESE DIMENSIONS ARE IN FEET AND WERE TAKEN FROM PLANS SUPPLIED ENTITLED "WYNDHAM PLANTATION AT WILLIAMSBURG, FLOOR PLANS" BY PROGRESSIVE DESIGNS DATED 11/19/98.
- INTERIOR UNIT CONFIGURATIONS AND PARTITIONS AS DEPICTED HEREON ARE FOR THE PURPOSE OF ILLUSTRATION ONLY AND MAY NOT REPRESENT THE INTERIOR OF A UNIT AS ACTUALLY CONSTRUCTED.

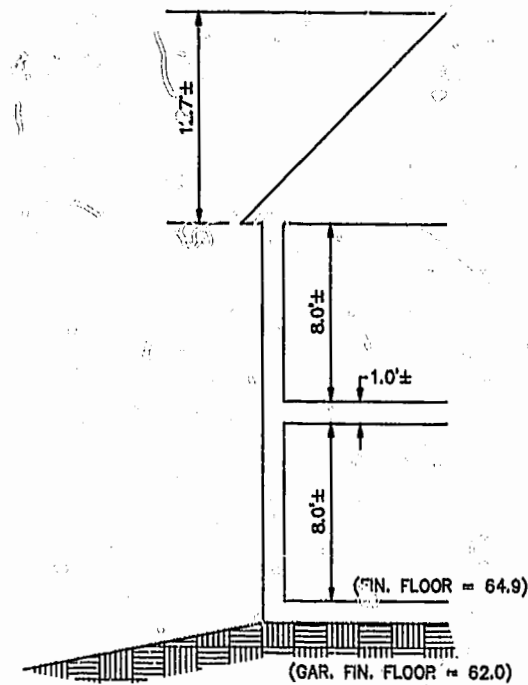
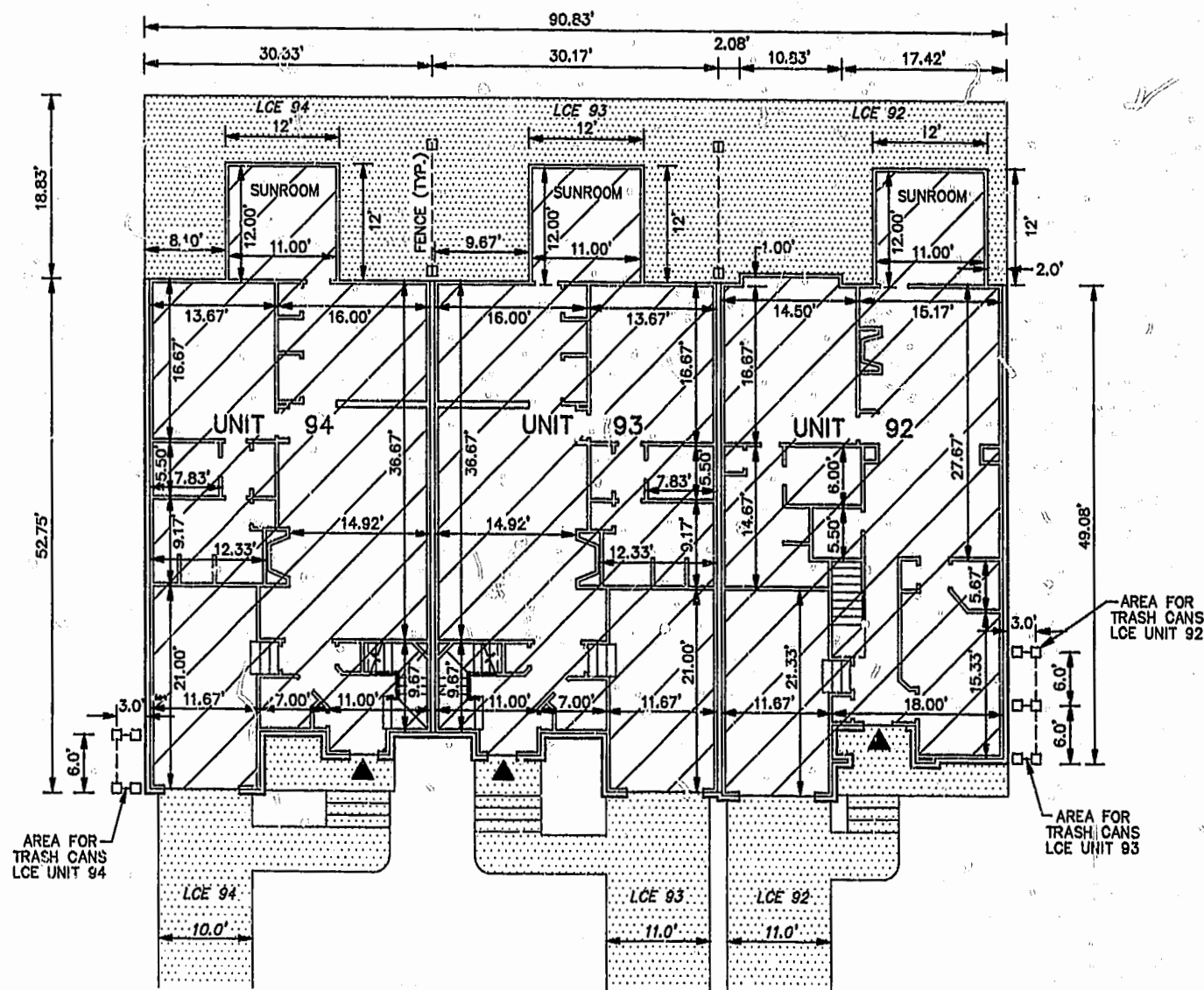

SCALE: 1"=5'

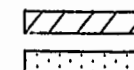

UNIT AREA  
 LIMITED COMMON  
 ELEMENT TO THE  
 UNIT INDICATED (LCE)  
 ▲ INDICATES FRONT  
 ENTRANCE TO UNIT

PHASE	UNIT No.	UNIT ADDRESS	UNIT AREA
6	92	412 ZELKOVA ROAD	1,997 S.F.
6	93	418 ZELKOVA ROAD	2,101 S.F.
6	94	420 ZELKOVA ROAD	2,101 S.F.

THE UNDERSIGNED CERTIFIES THAT THESE PLANS ARE ACCURATE AND COMPLY WITH THE PROVISIONS OF CODE OF VIRGINIA, SECTION 55-79.58.B AND THAT ALL UNITS OR PORTIONS THEREOF DEPICTED HEREON AND ALL COMMON ELEMENTS HAVE BEEN SUBSTANTIALLY COMPLETED.

Williamsburg/James City County SIGNED: Jeffrey D. Williams  
 11:20 AM  
 Recorded 25 day of January 2001  
 DOCUMENT # 010886  
Debra L. Williams, Clerk  
By Claudia A. Smith, D. Clerk  
 JEFFREY D. WILLIAMS, L.S.

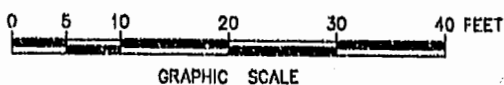
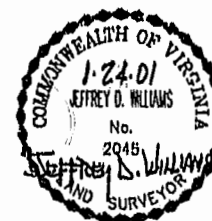

PLAT RECORDED IN  
 P.L. NO. 80 PAGE 6-11