

NOTE:  
ALL BUILDING DIMENSIONS AND DETAILS SHOWN  
ARE PER PLANS BY CMSS ARCHITECTS, P.C.

- CE** COMMON ELEMENT
- LCE** LIMITED COMMON ELEMENT
- A.F.F.** ABOVE FINISH FLOOR

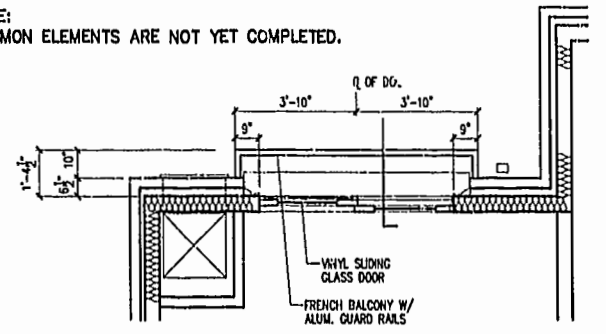
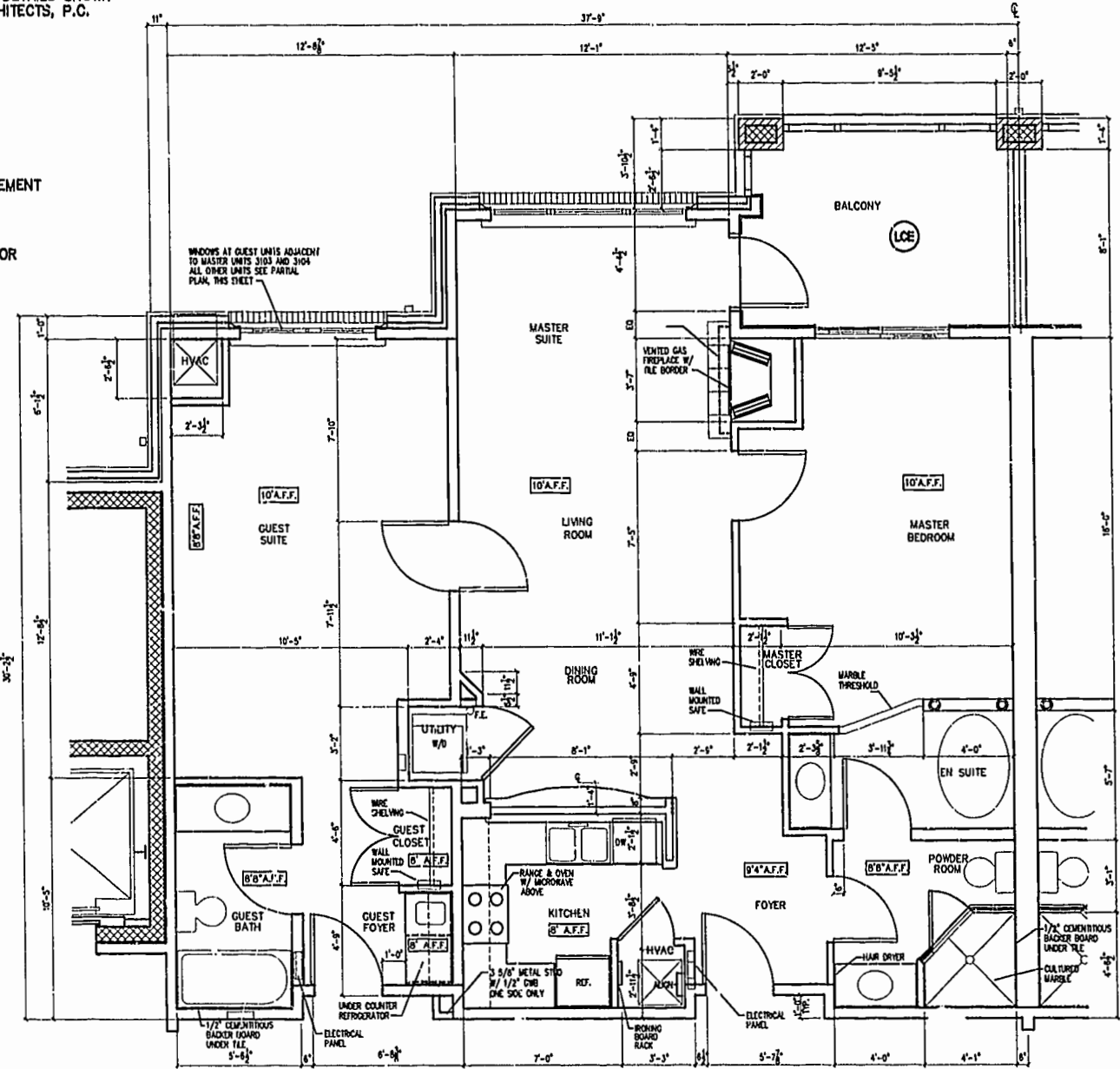

PARTIAL FLOOR PLAN - GUEST PLAN

NOTE: TYP. AT ALL UNITS EXCEPT  
WINDOWS AT GUEST UNITS ADJACENT  
TO MASTER UNITS 3103 AND 3104

FIRST FLOOR UNIT PLAN

UNIT NO.	ORIENTATION
3103	MIRRORED
3104	SAME
3105	SAME
3106	MIRRORED
3111	MIRRORED
3112	SAME
3115	MIRRORED
3116	SAME
3117	SAME
3118	MIRRORED



CERTIFICATION FOR PLANS

"THE UNDERSIGNED, A LICENSED LAND SURVEYOR, DOES HEREBY CERTIFY THAT THESE PLANS (AS SUBMITTED BY CMSS ARCHITECTS, P.C., REVISION DATE MARCH 15, 2000) DEPICT IMPROVEMENTS TO BE CONSTRUCTED (BUT WHICH ARE NOT YET COMPLETED) AND, IF THE IMPROVEMENTS ARE CONSTRUCTED IN ACCORDANCE WITH THESE PLANS, THESE PLANS CONFORM TO THE REQUIREMENTS OF VA. CODE ANN. SUBSECTIONS 55-79.58 B AND F IN SO FAR AS THEY RELATE TO CHARACTERISTICS OF THE CONDOMINIUM TO BE DEPICTED ON SUCH PLANS. UNITS AND COMMON ELEMENTS DEPICTED HEREON ARE NOT YET COMPLETED; IT BEING UNDERSTOOD THAT SUCH UNITS ARE BEING SUBJECTED TO A TIME-SHARE INSTRUMENT PURSUANT TO VA. CODE ANN. SECTION 55-367 AND THUS VA. CODE ANN. SUBSECTION 55-79.58 D APPLIES."

*A.D. Sebert*  
A. D. SEBERT, L.S.      7/11/00  
DATE

TYPICAL FIRST FLOOR UNIT PLAN  
(NOT TO SCALE)

- NOTES: \*
- THE LOWER (HORIZONTAL) BOUNDARY OF EACH UNIT IN BUILDING 3000 SHOWN ON THE PLAT AS LOCATED ON PHASE IX IS THE HORIZONTAL PLANE OF THE UPPER SURFACE OF THE FLOOR SLAB OR CONCRETE FLOOR TOPPING OF THE UNIT.
  - THE UPPER (HORIZONTAL) BOUNDARY OF EACH OF THE UNITS IN BUILDING 3000 SHOWN ON THE PLAT AS LOCATED ON PHASE IX IS THE HORIZONTAL PLANE(S) OF THE LOWER SURFACE OF THE FLOOR JOISTS (OR, IN THE CASE OF THIRD FLOOR UNITS, THE LOWER SURFACE OF THE BOTTOM CHORD OF THE ROOF TRUSSES) CONSTITUTING A PART OF THE CEILING OF THE UNIT.
- \* SEE ELEVENTH AMENDMENT TO DECLARATION OF CONDOMINIUM OF MANOR CLUB AT FORD'S COLONY, A CONDOMINIUM (PHASE IX CONDOMINIUM DECLARATION) FOR A MORE DETAILED DESCRIPTION.

08.17.00-13:33 MFC09P05.DWG

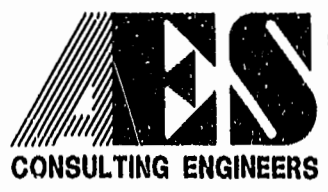

5248 Olde Towne Road, Suite 1  
Williamsburg, Virginia 23188  
(757) 253-0040  
Fax (757) 220-8994

**EXHIBIT A-3**

**PLAT OF CONDOMINIUM  
MANOR CLUB  
AT FORD'S COLONY  
PHASE IX**

OWNER/DEVELOPER: MARRIOTT OWNERSHIP RESORTS, INC.  
POWHATAN DISTRICT      JAMES CITY COUNTY      VIRGINIA

PLAT RECORDED IN  
P.L. NO. 79, PAGE 92-101

Williamsburg James City County	
Designed ADS	Drawn JFS
Scale NOTED	Date 7/11/00
Project No. 7739-11	
Drawing No. 5 OF 10	
No.	DATE
REVISION / COMMENT / NOTE	
BY	