

FIRST FLOOR BUILDING 23

Book 79 PAGE 87

SCALE: 1" = 10'

**EXHIBIT B-4
SUPPLEMENTAL CONDOMINIUM PLANS
OF
WYNDHAM PLANTATION
CONDOMINIUM**

WILLIAMSBURG, VIRGINIA

DATE: JANUARY 9, 2001 SCALE: 1"=10'

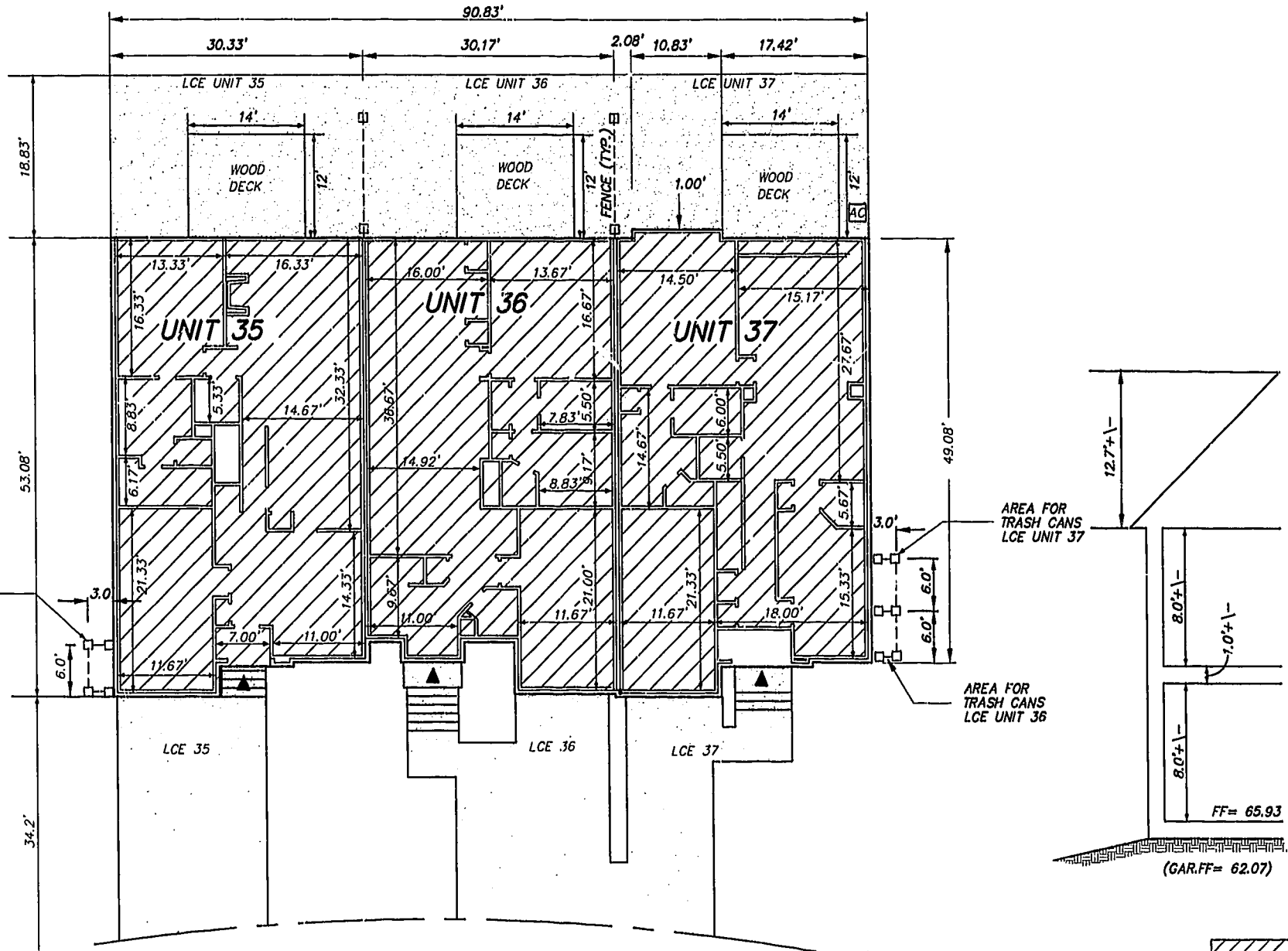

- NOTES:**
- 1) BUILDING DIMENSIONS SHOWN HEREON ARE INTERIOR DIMENSIONS. THESE DIMENSIONS ARE IN FEET AND WERE TAKEN FROM PLANS SUPPLIED ENTITLED "WYNDHAM PLANTATION AT WILLIAMSBURG, FLOOR PLANS" BY PROGRESSIVE DESIGNS DATED 11/19/98
 - 2) INTERIOR UNIT CONFIGURATIONS AND PARTITIONS AS DEPICTED HEREON ARE FOR THE PURPOSE OF ILLUSTRATION ONLY AND MAY NOT REPRESENT THE INTERIOR OF A UNIT AS ACTUALLY CONSTRUCTED.

PLAT RECORDED IN
P.B. NO. 79 PAGE 87
Williamsburg James City County
Recorded the day of January 2001
DOCUMENT # 010038 1206
[Signature]

PHASE	UNIT No.	UNIT ADDRESS	UNIT AREA
5	35	425 ZELKOVA DRIVE	1,799 S.F.
5	36	429 ZELKOVA DRIVE	1,957 S.F.
5	37	433 ZELKOVA DRIVE	1,853 S.F.

I HEREBY CERTIFY THAT THIS PLAN IS ACCURATE AND THAT IT COMPLIES WITH SECTION 55-79.58(B) OF THE VIRGINIA CONDOMINIUM ACT AS AMENDED AND THAT ALL UNITS OR PORTION THEREOF DEPICTED HEREON HAVE BEEN SUBSTANTIALLY COMPLETED EXCEPT AS OTHERWISE NOTED.

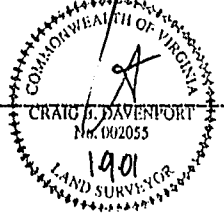

SIGNED: _____ DATE: 1.9.01

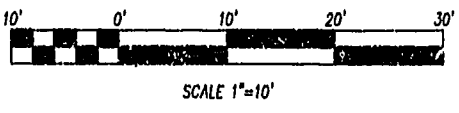

Rickmond Engineering, Inc.
1643 Merrimac Trail
Williamsburg VA 23185
Voice: (757) 229-1776
Fax No. (757) 229-4683
Engineering
Surveying
Land Planning
www.rickmond.com