

(FIRST FLOOR)

(SECOND FLOOR)

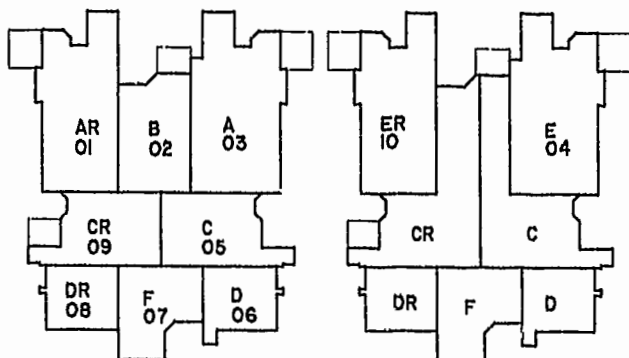

TYPICAL CONDOMINIUM LAYOUT

T.P. 372-(04)-00-00-A2
 NOW OR FORMERLY
CITY OF WILLIAMSBURG
 (D.B. 121, PG. 321)
 (M.B. 36, PG. 77)

PLAT RECORDED IN
 P.B. NO. 79 PAGE 62-65

Williamsburg/James City County
 10:27 AM
 14 day of Dec. 2000
 DOCUMENT # AD 1346
 Christopher D. Capozzi, Clerk



BRISTOL COMMONS
 A CONDOMINIUM COMMUNITY
 PHASE THREE
 FOR
KEY GROUP, LLC
 CITY OF WILLIAMSBURG, VIRGINIA

Hassell & Polkes, P.C. Engineers Surveyors Planners Chesapeake, VA 23320 (757) 547-9531	SIZE	CONTRACT NO	DISK/BOX	FILENAME	REV.
	C	98062	123C/15	BRISTOL3.DWG	
SCALE: 1" = 50'		DATE: 11/16/00		SHEET 3 of 4	