

NOW OR FORMERLY
COLLEGE OF WILLIAM & MARY

IRONBOUND

M.B. 71 - PG. 73

(APPROX. R/W)

ROAD



T.P. 372-(0A)-00-028
NOW OR FORMERLY
JEROME & EVELYN RANDOLPH
(D.B. 30, PG. 470)
ZONE: RM-2

T.P. 372-(0A)-00-030
NOW OR FORMERLY
JEROME & EVELYN RANDOLPH
(D.B. 37, PG. 379)
ZONE: RM-2

T.P. 372-(05)-00-001
NOW OR FORMERLY
CHESAPEAKE MEDIA, INC.
(D.B. 74, PG. 121)
(M.B. 42, PG. 25)
ZONE: B-2 CONDITIONAL

MATCH LINE
SEE SHEET 3

MATCH LINE
SEE SHEET 3

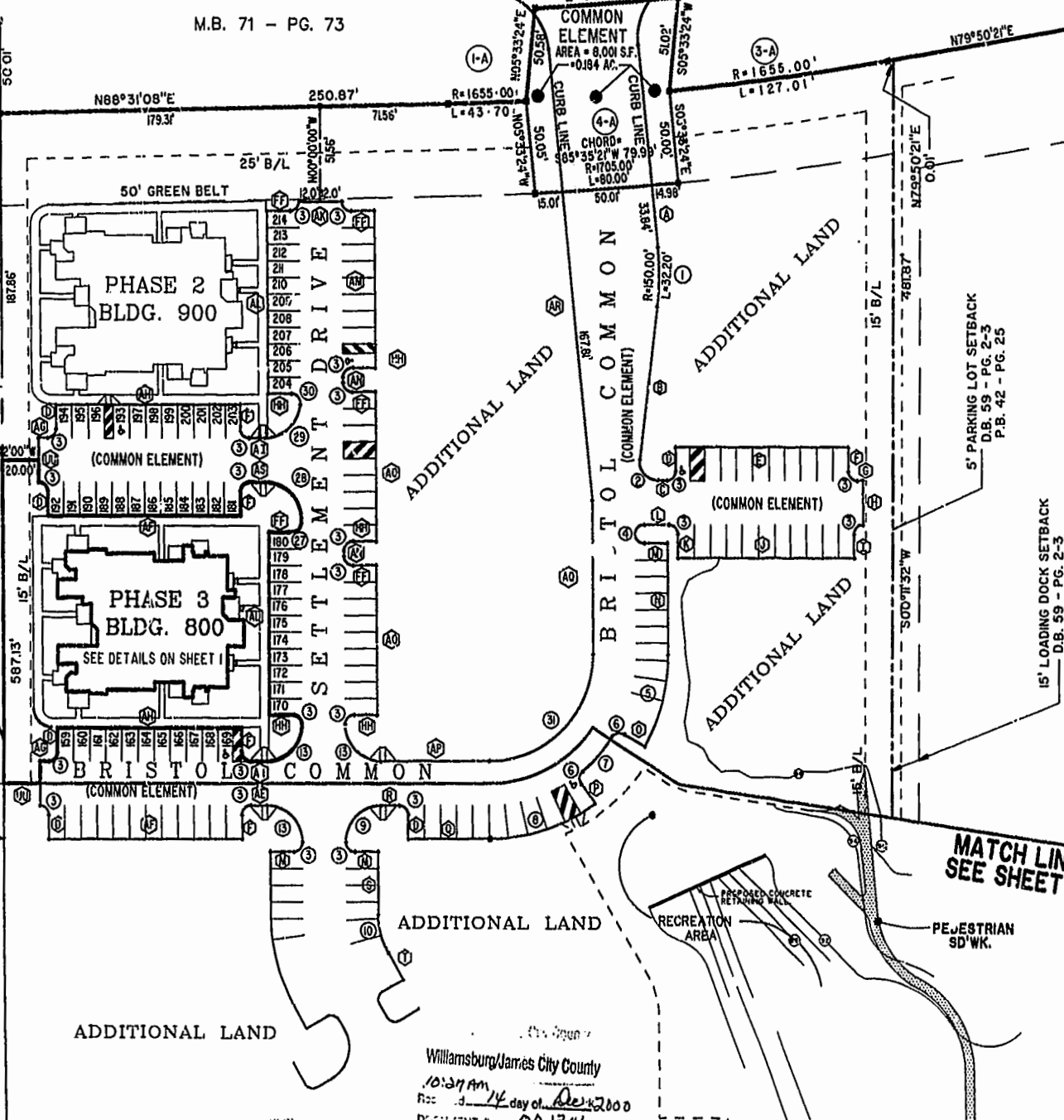

ROLAND STREET
40' R/W

ADDITIONAL LAND

ADDITIONAL LAND

RECREATION AREA

PEDESTRIAN SD'WK.

Williamsburg/James City County
10:37 AM
Rec. 14 day of Dec 2000
DOCUMENT # 001346
Clyde W. Bridges, Clerk

PLAT RECORDED IN
P.B. NO. 99 PAGE 62-65

BRISTOL COMMONS
A CONDOMINIUM COMMUNITY
PHASE THREE
FOR
KEY GROUP, LLC
CITY OF WILLIAMSBURG, VIRGINIA

Hassell & Folkes, P.C. Engineers Surveyors Planners Chesapeake, VA 23320 (757)547-9531	SIZE C	CONTRACT NO. 98062	DISK/BOX 123C/15	FILENAME BRISTOL3.DWG	REV.
SCALE: 1"=50'		DATE: 11/16/00		SHEET 2 of 4	