

BUILDING NUMBER	UNIT NUMBER	STREET ADDRESS
9	901	901 WESTGATE CIRCLE
9	902	902 WESTGATE CIRCLE
9	903	903 WESTGATE CIRCLE
9	904	904 WESTGATE CIRCLE

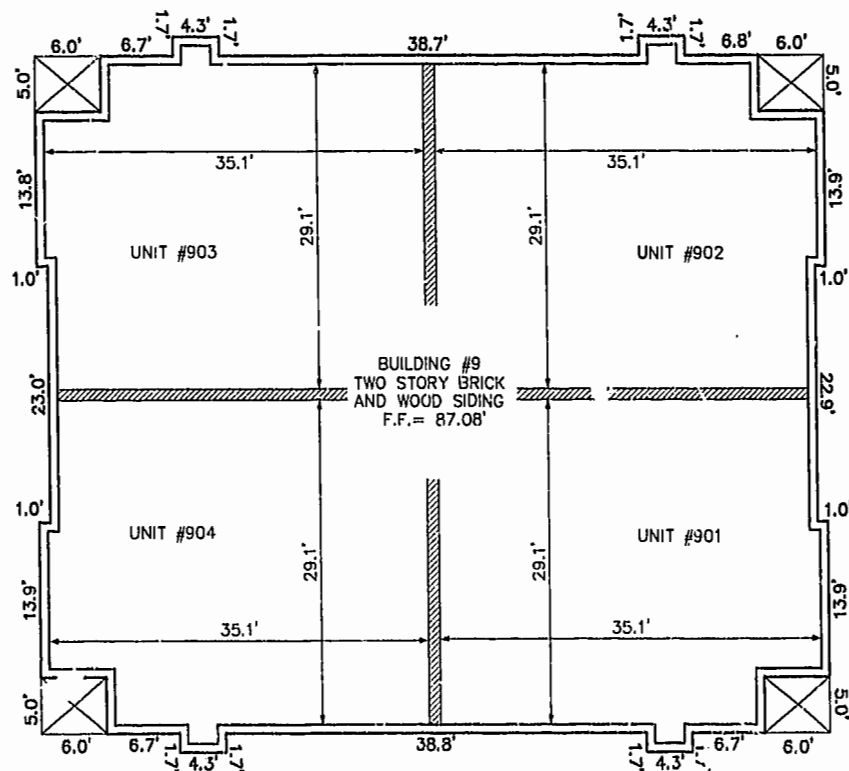

FRONT OF BUILDING
FIRST FLOOR

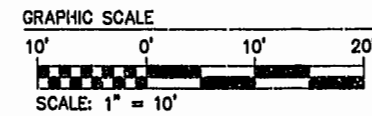
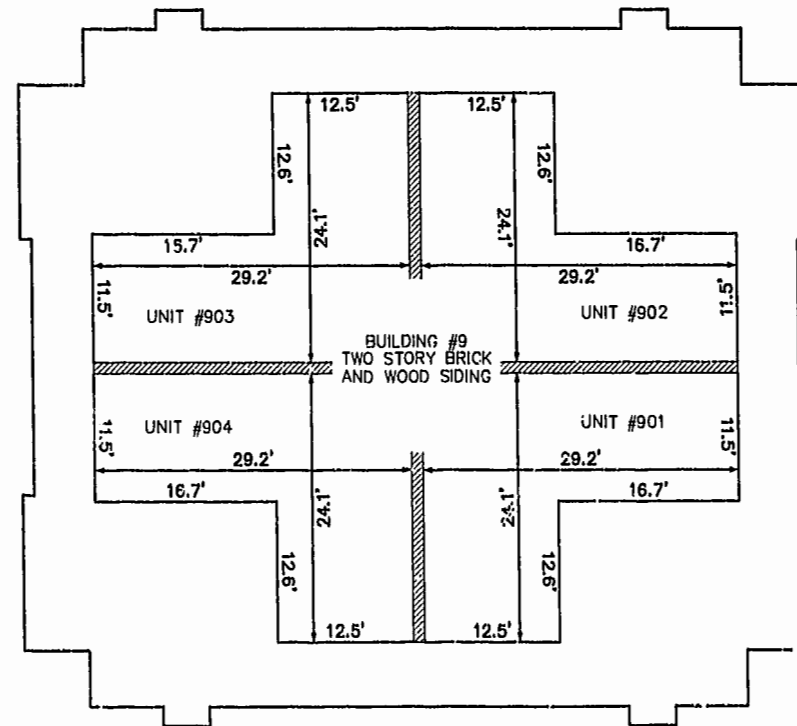

FRONT OF BUILDING
SECOND FLOOR

Williamsburg/James City County

Recorded 11:12 AM 29 day of Aug 2000

DOCUMENT # 000929

Betsy Woolridge Clerk

BETSY B. WOOLRIDGE, CLERK OF CIRCUIT COURT

PLAT RECORDED IN
P.D. NO. 78 PAGE 40-45

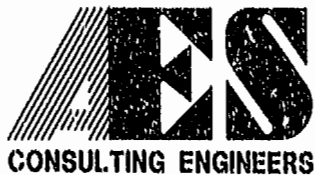

5248 Olde Towne Road, Suite 1
Williamsburg, Virginia 23188
(757) 253-0040
Fax (757) 220-8994

PLAT OF CONDOMINIUM
WESTGATE AT WILLIAMSBURG,
A CONDOMINIUM
PHASE EIGHT
OWNED BY: 752 L.L.C.,
A VIRGINIA LIMITED LIABILITY COMPANY
CITY OF WILLIAMSBURG VIRGINIA



No.	DATE	REVISION / COMMENT / NOTE	BY

Designed GTW/ADS	Drawn JFS
Scale 1" = 10'	Date 8/28/00
Project No. 8395-6	
Drawing No. 4 OF 6	

08.28.00-13:23 8395PH84.DWG