

46-1-01-0-0001
"GREENSPRINGS PLANTATION"
(DB 322, PG 254)

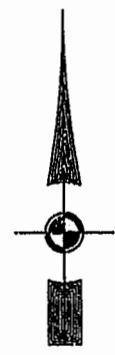

EXIST. 20' JAMES CITY COUNTY SERVICE
AUTHORITY SAN. SEWER EASEMENT AS
SHOWN IN AS-BUILT LOCATION. D.B. 141 - PG. 388

EXIST. 20' DRAINAGE EASMT.
M.B. 65 - PG. 2

EXIST. 20' DRAINAGE EASEMENT
M.B. 65 - PG. 2

N 76°40'21" E
20' SANITARY SEWER EASEMENT

COMMON
AREA
LIMITS OF 50' RPA
LIMITS OF 100' RPA

EX. 50' COLONIAL PIPELINE EASEMENT (D.B. 90 PG. 1)
COMMON
AREA

ADDITIONAL LAND

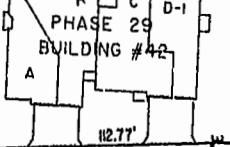

COMMON AREA
BMP LAKE # 1
AREA = 38,052 SQ. FT. =
0.8735 AC.
SEE SHEET 3 FOR DETAIL

MATCH LINE
SEE SHEET 4

SEE SHEETS 4 FOR
LOCATION AND DETAILS
OF PHASE 22, BLDG. #43

EXHIBIT "A" PHASE 23
FAIRWAYS VILLAS
AT
GREENSPRINGS, A CONDOMINIUM
FOR
GREENSPRINGS DEVELOPMENT, L.C.
BERKELEY DISTRICT JAMES CITY COUNTY, VIRGINIA



Hassell & Polkes, P.C. Engineers Surveyors Planners Chesapeake, VA 23320 (757)547-9531	SIZE CONTRACT NO C 95-079	DISK/BOX 6W/16 REF: 10/13	FILE NAME FAIRWAY23.DWG FWAYPLAT.DWG	REV.
SCALE: 1" = 50'	DATE: 07/12/00	SHEET 5 of 6		



Recorded by James City County
3:54 PM
DOCUMENT # 002013472
Clerk
DESIY B. WOOLRIDGE, CLERK OF CIRCUIT COURT

PLAT RECORDED BY
P.D. NO. 78 PAGE 24-29

MATCH LINE - SEE SHEET 3

MATCH LINE
SEE SHEET 4

COMMON
AREA

ADDITIONAL LAND

N 42°06'15" E
151.62'

N 63°29'08" E
42.20'

N 63°00'24" E
290.15'

N 76°40'21" E
260.37'

34.96'

134.31'

732.83'

42.20'

163.82'

S88°13'21"E
909.33'

1025.04'

20'

173.51'

286.28'

L=126.05'

N88°44'18"E

N88°44'18"E

MATCH LINE
SEE SHEET 4

SEE SHEETS 4 FOR
LOCATION AND DETAILS
OF PHASE 22, BLDG. #43

EXHIBIT "A" PHASE 23
FAIRWAYS VILLAS
AT
GREENSPRINGS, A CONDOMINIUM
FOR
GREENSPRINGS DEVELOPMENT, L.C.
BERKELEY DISTRICT JAMES CITY COUNTY, VIRGINIA

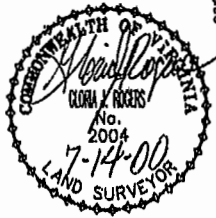

Hassell & Polkes, P.C. Engineers Surveyors Planners Chesapeake, VA 23320 (757)547-9531	SIZE CONTRACT NO C 95-079	DISK/BOX 6W/16 REF: 10/13	FILE NAME FAIRWAY23.DWG FWAYPLAT.DWG	REV.
SCALE: 1" = 50'	DATE: 07/12/00	SHEET 5 of 6		

Recorded by James City County
3:54 PM
DOCUMENT # 002013472
Clerk
DESIY B. WOOLRIDGE, CLERK OF CIRCUIT COURT

PLAT RECORDED BY
P.D. NO. 78 PAGE 24-29

MATCH LINE - SEE SHEET 3

MATCH LINE
SEE SHEET 4

COMMON
AREA

ADDITIONAL LAND

N 42°06'15" E
151.62'

N 63°29'08" E
42.20'

N 63°00'24" E
290.15'

N 76°40'21" E
260.37'

34.96'

134.31'

732.83'

42.20'

163.82'

S88°13'21"E
909.33'

1025.04'

20'

173.51'

286.28'

L=126.05'

N88°44'18"E

N88°44'18"E

MATCH LINE
SEE SHEET 4

SEE SHEETS 4 FOR
LOCATION AND DETAILS
OF PHASE 22, BLDG. #43

EXHIBIT "A" PHASE 23
FAIRWAYS VILLAS
AT
GREENSPRINGS, A CONDOMINIUM
FOR
GREENSPRINGS DEVELOPMENT, L.C.
BERKELEY DISTRICT JAMES CITY COUNTY, VIRGINIA

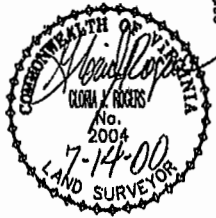

Hassell & Polkes, P.C. Engineers Surveyors Planners Chesapeake, VA 23320 (757)547-9531	SIZE CONTRACT NO C 95-079	DISK/BOX 6W/16 REF: 10/13	FILE NAME FAIRWAY23.DWG FWAYPLAT.DWG	REV.
SCALE: 1" = 50'	DATE: 07/12/00	SHEET 5 of 6		