

FILE RECORDED BY  
02-09-2000 11:00 AM 96-101

Williamsburg, Virginia City Clerk  
Recorded 24 day of March 2000  
DOCUMENT # 00005901 2:02 PM  
Patricia Woodridge Clerk

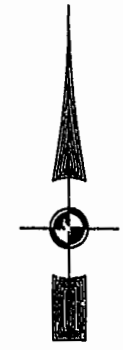

46-1-01-0-0001  
"GREENSPRINGS PLANTATION"  
(DB 322, PG 254)

EXIST. 20' JAMES CITY COUNTY SERVICE  
AUTHORITY SAN. SEWER EASEMENT AS  
SHOWN IN AS-BUILT LOCATION. D.B. 141 - PG. 388

EXIST. 20' DRAINAGE EASMT.  
M.B. 65 - PG. 2

EXIST. 20' DRAINAGE EASEMENT  
M.B. 65 - PG. 2

N 76°40'21" E  
20' SANITARY SEWER EASEMENT

COMMON AREA  
LIMITS OF 50' RMA  
LIMITS OF 100' RMA

EX. 50' COLONIAL PIPELINE EASEMENT (D.B. 90 PG. 1)  
COMMON AREA

MATCH LINE  
SEE SHEET 4

COMMON AREA

ADDITIONAL LAND

ADDITIONAL LAND

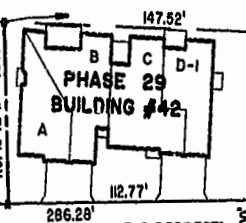

COMMON AREA  
BMP LAKE # 1  
AREA = 38,052 SQ. FT. =  
0.8735 AC.  
SEE SHEET 5 FOR DETAIL

EXHIBIT "A" PHASE 29  
FAIRWAYS VILLAS  
AT  
GREENSPRINGS, A CONDOMINIUM  
FOR  
GREENSPRINGS DEVELOPMENT, L.C.  
BERKELEY DISTRICT JAMES CITY COUNTY, VIRGINIA



Hassell & Polkes, P.C. Engineers Surveyors Planners Chesapeake, VA 23320 (757) 547-9531	SIZE CONTRACT NO C 95-079	DISK/BOX 65/16 REF: 10/13	FILENAME FAIRWAY29.DWG FWAYPLAT.DWG
SCALE: 1" = 80'	DATE: 01/27/00	SHEET 5 of 6	

MATCH LINE - SEE SHEET 3