

NOTE:
ALL BUILDING DIMENSIONS AND DETAILS SHOWN
ARE PER PLANS BY CMSS ARCHITECTS, P.C.

NOTE:
COMMON ELEMENTS ARE NOT YET COMPLETED.

- CE** COMMON ELEMENT
- LCE** LIMITED COMMON ELEMENT
- A.F.F.** ABOVE FINISH FLOOR

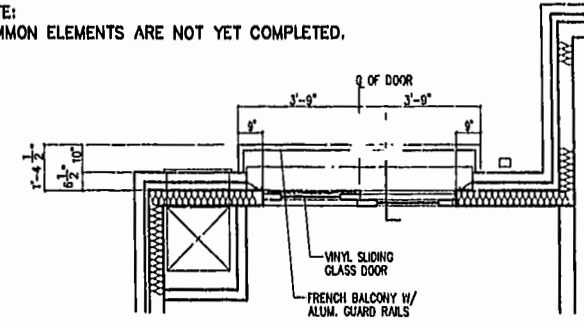
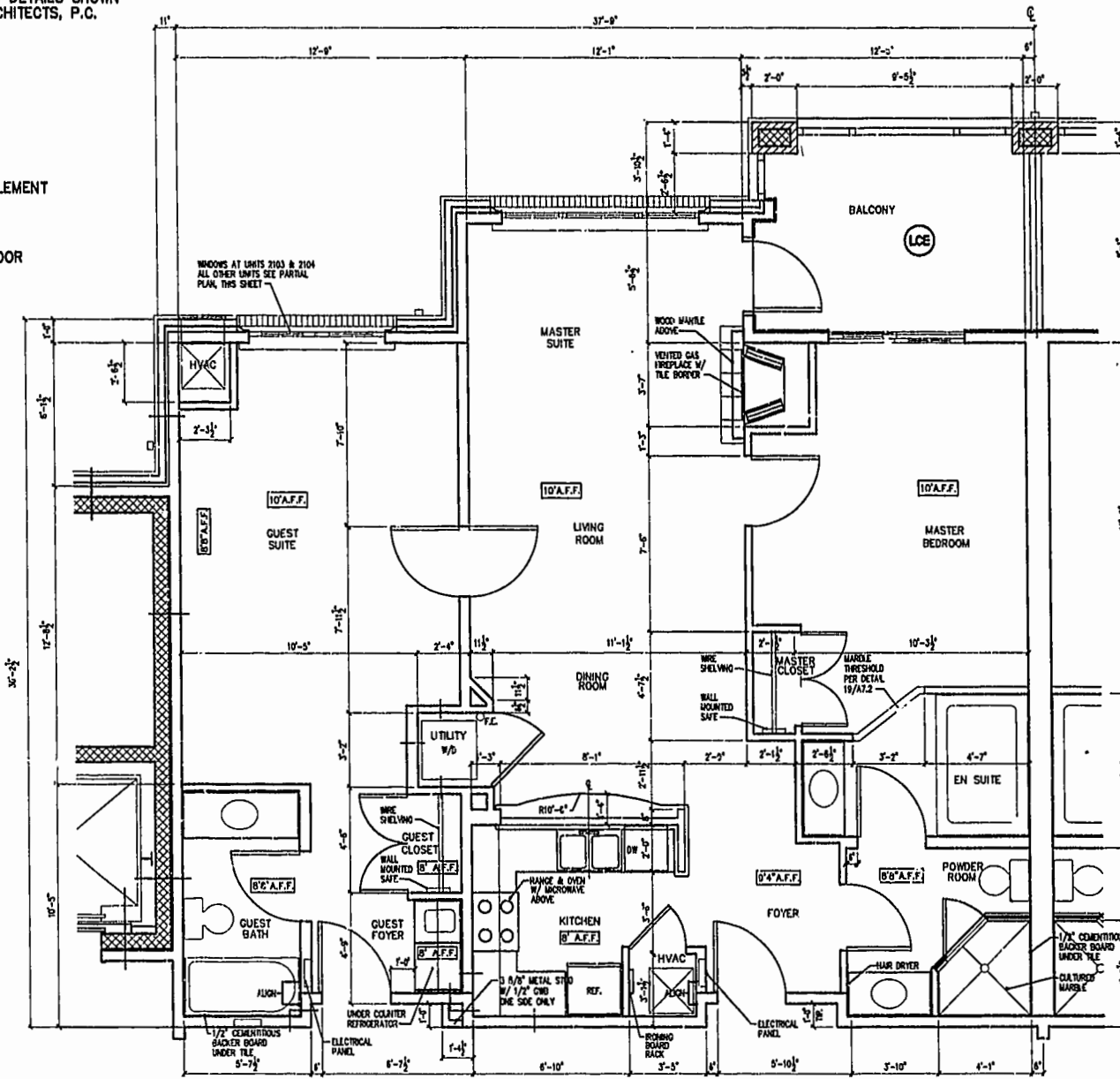

PARTIAL FLOOR PLAN - GUEST PLAN

NOTE: TYP. AT ALL UNITS
EXCEPT FOR 2103 & 2104

FIRST FLOOR UNIT PLAN

UNIT NO.	ORIENTATION
2103	MIRRORED
2104	SAME
2105	SAME
2106	MIRRORED
2111	MIRRORED
2112	SAME
2113	SAME
2114	MIRRORED



CERTIFICATION FOR PLANS

"THE UNDERSIGNED, A LICENSED LAND SURVEYOR, DOES HEREBY CERTIFY THAT THESE PLANS (AS SUBMITTED BY CMSS ARCHITECTS, P.C., REVISION DATE MAY 5, 1999) DEPICT IMPROVEMENTS TO BE CONSTRUCTED (BUT WHICH ARE NOT YET COMPLETED) AND, IF THE IMPROVEMENTS ARE CONSTRUCTED IN ACCORDANCE WITH THESE PLANS, THESE PLANS CONFORM TO THE REQUIREMENTS OF VA. CODE ANN. SUBSECTIONS 55-79.58 B AND F IN SO FAR AS THEY RELATE TO CHARACTERISTICS OF THE CONDOMINIUM TO BE DEPICTED ON SUCH PLANS. UNITS AND COMMON ELEMENTS DEPICTED HEREON ARE NOT YET COMPLETED; IT BEING UNDERSTOOD THAT SUCH UNITS ARE BEING SUBJECTED TO A TIME-SHARE INSTRUMENT PURSUANT TO VA. CODE ANN. SECTION 55-387 AND THUS VA. CODE ANN. SUBSECTION 55-79.58 D APPLIES."

A. D. Sebert
A. D. SEBERT, L.S. 10/20/99
DATE

TYPICAL FIRST FLOOR UNIT PLAN
(NOT TO SCALE)

- NOTES:
- THE LOWER (HORIZONTAL) BOUNDARY OF EACH UNIT IN BUILDING 2000 SHOWN ON THE PLAT AS LOCATED ON PHASE VIII IS THE HORIZONTAL PLANE OF THE UPPER SURFACE OF THE FLOOR SLAB OR CONCRETE FLOOR TOPPING OF THE UNIT.
 - THE UPPER (HORIZONTAL) BOUNDARY OF EACH OF THE UNITS IN BUILDING 2000 SHOWN ON THE PLAT AS LOCATED ON PHASE VII IS THE HORIZONTAL PLANE(S) OF THE LOWER SURFACE OF THE FLOOR JOISTS (OR, IN THE CASE OF THIRD FLOOR UNITS, THE LOWER SURFACE OF THE BOTTOM CHORD OF THE ROOF TRUSSES) CONSTITUTING A PART OF THE CEILING OF THE UNIT.
- * SEE NINTH AMENDMENT TO DECLARATION OF CONDOMINIUM OF MANOR CLUB AT FORD'S COLONY, A CONDOMINIUM (PHASE VIII CONDOMINIUM AGREEMENT) FOR A MORE DETAILED DESCRIPTION.

JFS 1.1.16.99-10:17 7739MCP5.DWG

EXHIBIT A-3

PLAT OF CONDOMINIUM
MANOR CLUB
AT FORD'S COLONY
PHASE VIII

OWNER/DEVELOPER: MARRIOTT OWNERSHIP RESORTS, INC.
POWATAN DISTRICT JAMES CITY COUNTY VIRGINIA

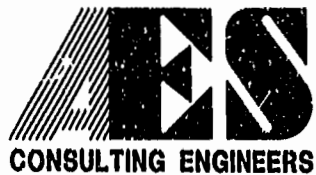

5248 Olde Towne Road, Suite 1
Williamsburg, Virginia 23188
(757) 253-0040
Fax (757) 220-8994

PLAT RECORDED IN	RECORDED	FILED
P.B. NO. 16	PAGE 17	NOV 10 1999
CLERK		
No.	DATE	REVISION / COMMENT / NOTE

Designed	Drawn
ADS	JFS
Scale	Date
NOTED	10/20/99
Project No.	
7739-11	
Drawing No.	
5 OF 10	