

PLAT OF SUBDIVISION WATERFORD AT POWHATAN SECONDARY PHASE FIFTEEN BERKELEY DISTRICT JAMES CITY COUNTY, VIRGINIA

DATE: 10/21/98 SHEET 2 OF 3 SCALE: 1"=100'
PROJECT NO: 97-008 DRAWN BY: CADD

SLEDD & ASSOCIATES, P.C.
ENGINEERS PLANNERS SURVEYORS
11832 ROCK LANDING DRIVE, SUITE 203
NEWPORT NEWS, VIRGINIA 23608
(757) 873-3388

00°32'24"
 JAMES CITY COUNTY
 GEODETIC GROUND CONTROL
 PLAT BOOK 66, PAGE 70

NOW OR FORMERLY
POWHATAN ENTERPRISES, INC.

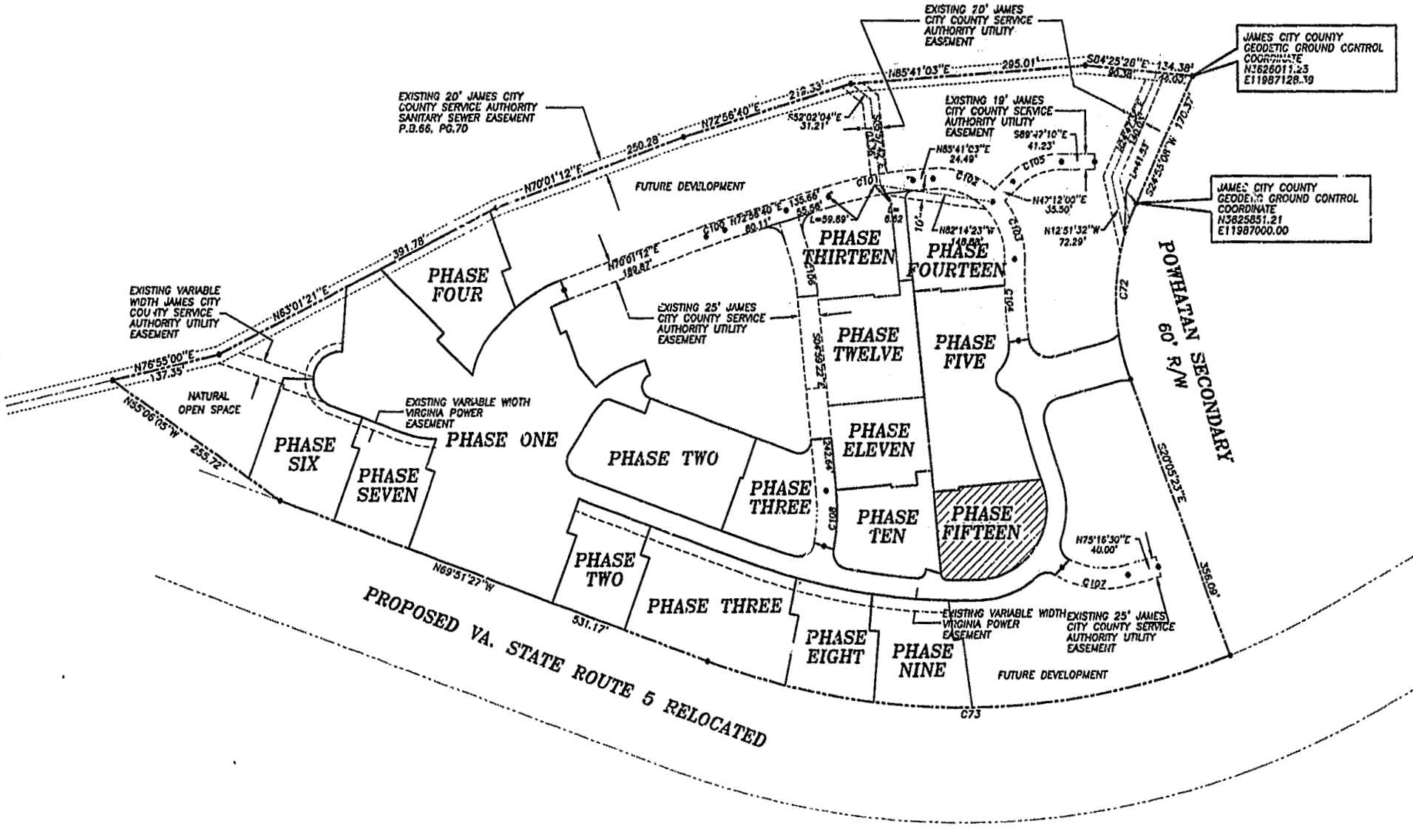

JAMES CITY COUNTY
GEODETIC GROUND CONTROL
COORDINATE
N3626011.23
E11987128.39

JAMES CITY COUNTY
GEODETIC GROUND CONTROL
COORDINATE
N3825851.21
E11987000.00

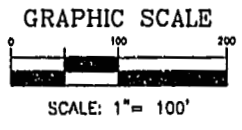
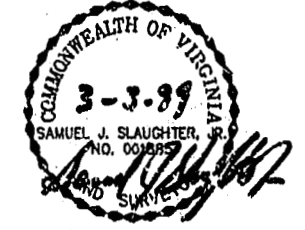

Recorded 30th day of December 99
DOCUMENT 990022009
(Signature)

PLAT RECORDED IN
P.B. NO. 76 PAGE 749

CURVE DATA

Station	Chord	Angle	Delta	Radius