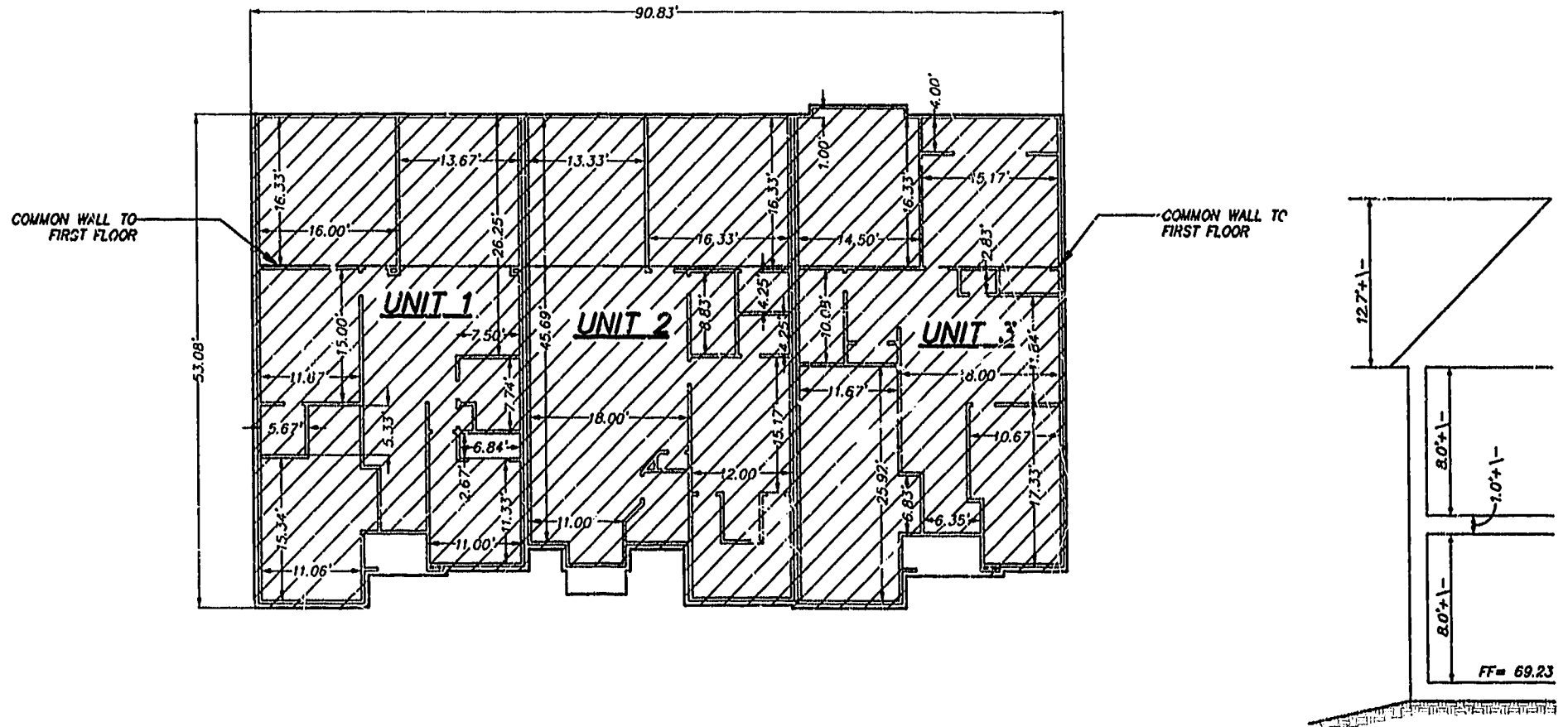

**EXHIBIT B  
CONDOMINIUM PLATS AND PLANS FOR  
WYNDHAM PLANTATION  
CONDOMINIUM**

**SECOND FLOOR BUILDING 20**

SCALE: 1" = 10'

WILLIAMSBURG, VIRGINIA  
DATE: SEPTEMBER 27, 1999 SCALE: 1"=10'



**NOTES:**

- 1) BUILDING DIMENSIONS SHOWN HEREON ARE INTERIOR DIMENSIONS. THESE DIMENSIONS ARE IN FEET AND WERE TAKEN FROM PLANS SUPPLIED ENTITLED "WYNDHAM PLANTATION AT WILLIAMSBURG, FLOOR PLANS" BY PROGRESSIVE DESIGNS DATED 11/19/98
- 2) INTERIOR UNIT CONFIGURATIONS AND PARTITIONS AS DEPICTED HEREON ARE FOR THE PURPOSE OF ILLUSTRATION ONLY AND MAY NOT REPRESENT THE INTERIOR OF A UNIT AS ACTUALLY CONSTRUCTED.

PHASE	UNIT No.	UNIT ADDRESS	UNIT AREA
2	1	465 ZELKOVA DRIVE	1,853 S.F.
2	2	469 ZELKOVA DRIVE	1,957 S.F.
2	3	473 ZELKOVA DRIVE	1,799 S.F.

I HEREBY CERTIFY THAT THIS PLAN IS ACCURATE AND THAT IT COMPLIES WITH SECTION 55-79.58(B) OF THE VIRGINIA CONDOMINIUM ACT AS AMENDED AND THAT ALL UNITS OR PORTIONS THEREOF DEPICTED HEREON HAVE BEEN SUBSTANTIALLY COMPLETED EXCEPT AS OTHERWISE NOTED.

SIGNED: \_\_\_\_\_



DATE: 9/27/99

1:31 PM  
 29 day of Oct. 1999  
 DOCUMENT # 261382  
 Helen S. Wood, Clerk  
 by Claudia A. Bickelby, Dy. Clerk

PLAT RECORDED IN  
 BOOK 75 PAGE 15-20

**Rickmond Engineering, Inc.**

1643 Merrimac Trail  
 Williamsburg VA 23185  
 Voice: (757) 229-1776  
 Fax No. (757) 229-4683

Engineering  
 Surveying  
 Land Planning  
 www.rickmond.com