

BUILDING NUMBER	UNIT NUMBER	UNIT TYPE	STREET ADDRESS
30	30-384	F	384 FAIRWAY LOOKOUT
30	30-386	G	386 FAIRWAY LOOKOUT
30	30-388	H	388 FAIRWAY LOOKOUT
30	30-390	E	390 FAIRWAY LOOKOUT

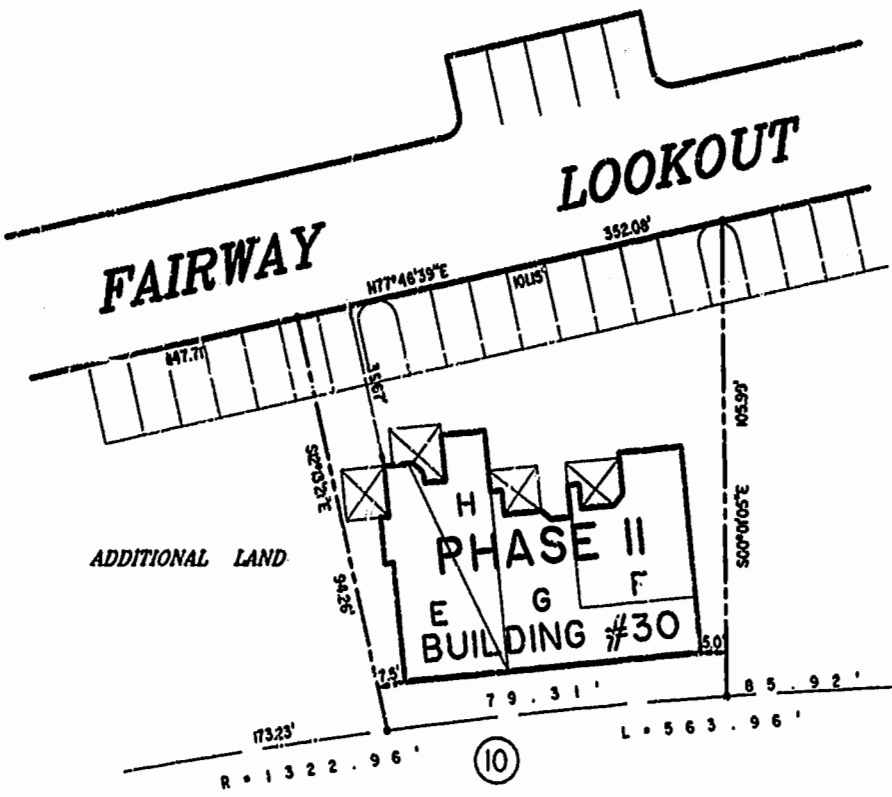
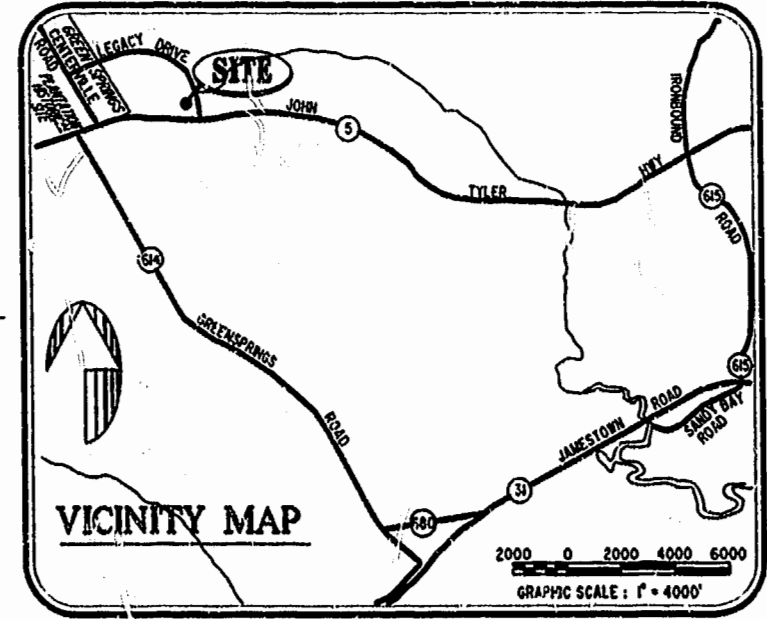

- NOTES:**
1. THE TOTAL AREA OF SITE IS 1,222,568 SQ.FT. (28.07 AC.) OF WHICH 328,779 SQ.FT. (7.548 AC.) IS ADDITIONAL LAND.
  2. THE AREA OF THE SUBMITTED LAND IS 893,789 SQ.FT. (20.519 AC.)
  3. THE COMMON AREA IS TO BE THE RESPONSIBILITY OF THE CONDOMINIUM ASSOCIATION AND HAS A TOTAL AREA OF 16.43 AC.

I GLORIA J. ROGERS, A CERTIFIED LAND SURVEYOR, DO HEREBY CERTIFY THAT THIS PLAT IS ACCURATE, AND THAT IT COMPLIES WITH THE PROVISIONS OF SECTION 55 - 79.58A OF THE CODE OF VIRGINIA. I FURTHER HEREBY CERTIFY THAT ALL UNITS OR PORTIONS THEREOF DEPICTED HEREON HAVE BEEN SUBSTANTIALLY COMPLETED.

THE UNDERSIGNED CERTIFIED LAND SURVEYOR CERTIFIES THAT HE HAS READ SECTION 55 - 79.58B OF THE CODE OF VIRGINIA, AND FINDS THIS PLAT TO BE ACCURATE AND IN COMPLIANCE WITH THE CODE. I FURTHER CERTIFY THAT ALL UNITS OR PORTIONS THEREOF DEPICTED HEREON HAVE BEEN SUBSTANTIALLY COMPLETED.

DATE 10-12-99  
 \_\_\_\_\_  
 LAND SURVEYOR No. 2004

**PHASE 11**

AREA = 8,919 SQ. FT. = 0.205 AC.

3:53 PM  
 Recorded 14 Oct 1999  
 DOCUMENT # 990215589  
 Date 10/19/99

PLAT RECORDED  
 P.B. NO. 75 PAGE 1-6



**Hassell & Folkes, P.C.**  
 Engineers Surveyors Planners  
 325 Volvo Parkway  
 Chesapeake, VA 23320  
 (757) 547-9531

DRAWN BY:	DATE
HJS	07/15/99
COMP BY:	DATE
HF	
CHECKED BY:	DATE
HBA	07/19/99

**EXHIBIT "A" PHASE 11**  
**FAIRWAYS VILLAS**  
 AT  
**GREENSPRINGS, A CONDOMINIUM**  
 FOR  
**GREENSPRINGS DEVELOPMENT, L.C.**  
 BERKELEY DISTRICT JAMES CITY COUNTY, VIRGINIA

SIZE	DISK/BOX	FILENAME	REV.
C	95-079	6N/16 REF: 16/13	FAIRWAY.DWG FWAYPLAT.DWG

SCALE: 1" = 25'    DATE: 07/15/99    SHEET 1 of 6