

PLAT OF SUBDIVISION
WATERFORD
AT
POWHATAN SECONDARY
PHASE FOURTEEN
BERKELEY DISTRICT
JAMES CITY COUNTY, VIRGINIA

DATE: 10/21/98 SHEET 2 OF 3 SCALE: 1"=100'
PROJECT NO: 97-008 DRAWN BY: CADD

SA SLEDD & ASSOCIATES, P.C.
ENGINEERS PLANNERS SURVEYORS
11832 ROCK LANDING DRIVE, SUITE 203
NEWPORT NEWS, VIRGINIA 23606
(757) 873-3388

00°32'24"
JAMES CITY COUNTY
GROUND CONTROL
MEMORANDUM
PLAT BOOK: 66, PAGE 70

NOW OR FORMERLY
POWHATAN ENTERPRISES, INC.

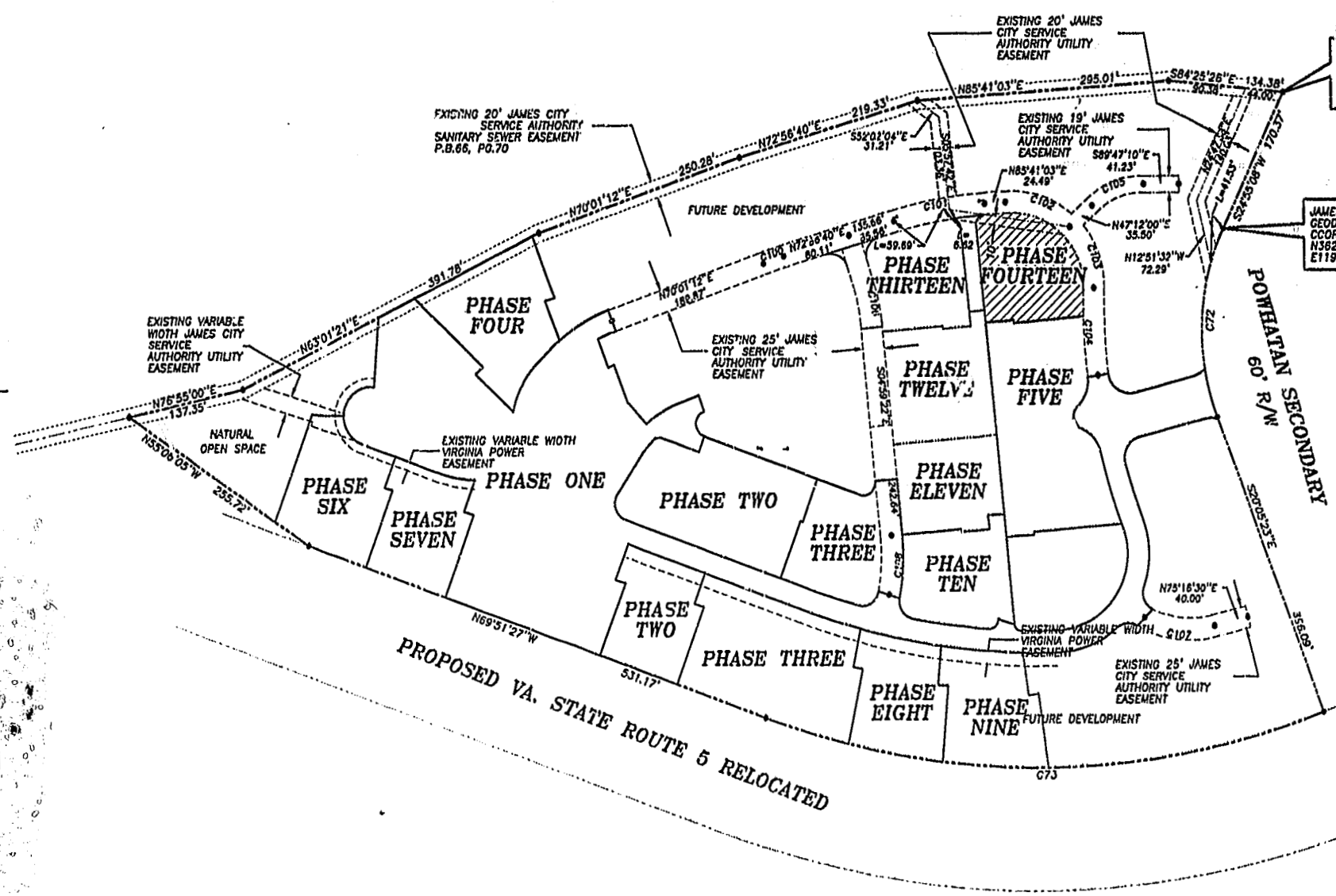

JAMES CITY COUNTY
GEODETIC GROUND CONTROL
COORDINATE
N1325011.25
E11987128.39

JAMES CITY COUNTY
GEODETIC GROUND CONTROL
COORDINATE
N3825851.21
E11987000.00

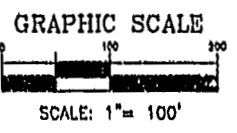

PLAT RECORDED IN
P.B. NO. 74 PAGE 1-3

Recorded 26 day of JULY 1999
DOCUMENT # 9700 07825 1045
James S. Slaughter

CURVE DATA