

NOTE:  
**BOLD DIMENSIONS** BASED ON ACTUAL FIELD MEASUREMENTS.  
 OTHER DATA TAKEN FROM PLANS PER NICHOLS CARTER GRANT ARCHITECTS.

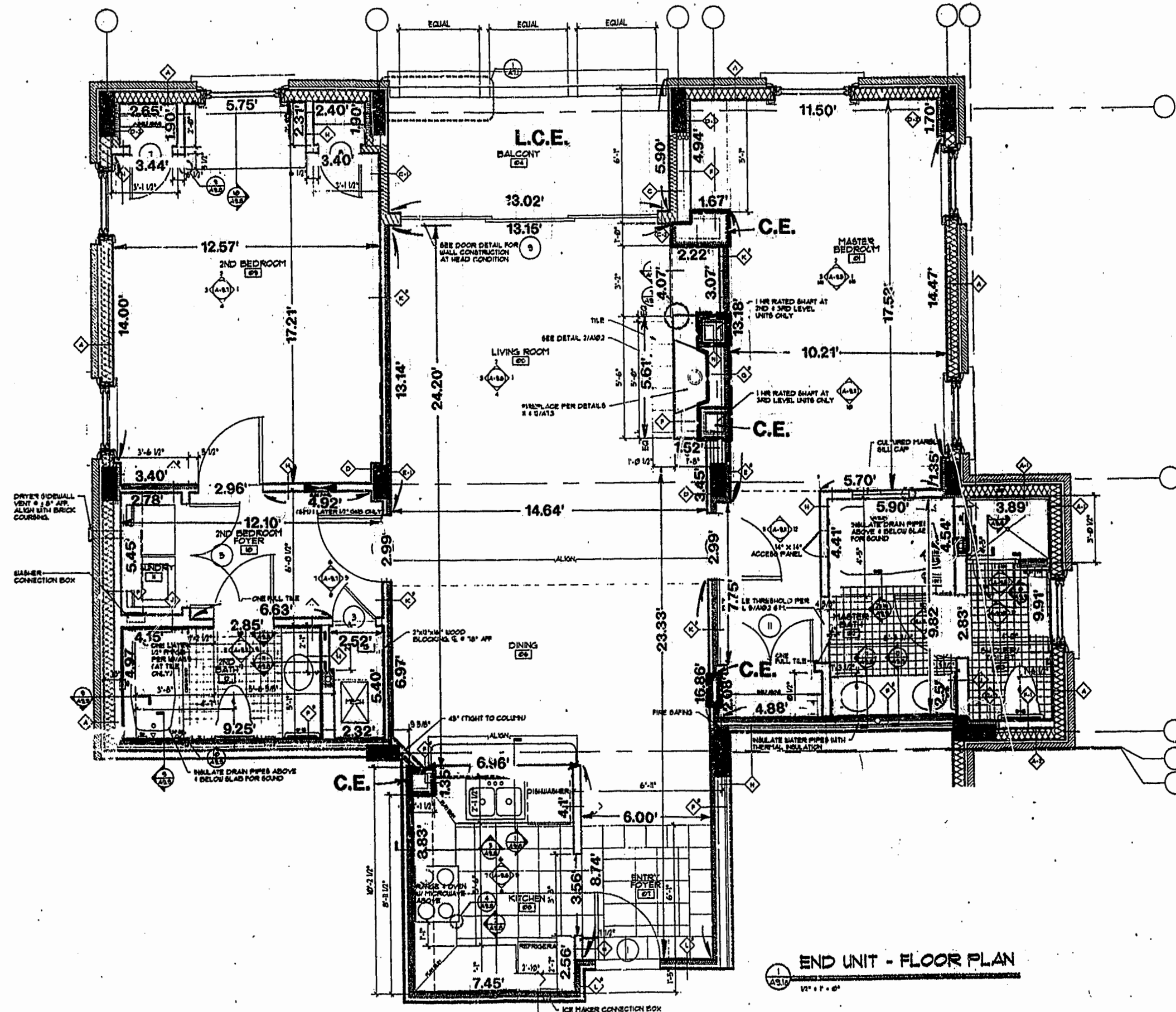

END UNIT - FLOOR PLAN

END UNIT FLOOR PLAN

| UNIT NO. | ORIENTATION |
|----------|-------------|
| 1811     | FLIPPED     |
| 1816     | SAME        |
| 1821     | FLIPPED     |
| 1826     | SAME        |
| 1831     | FLIPPED     |
| 1836     | SAME        |

BOLD DIMENSIONS SHOWN ARE TYPICAL AND BASED ON ACTUAL FIELD MEASUREMENTS OF UNIT #1815.

Recorded 21 day of April 1998  
 DOCUMENT # 980007172 3117  
*Patricia A. Woodbridge, Clerk*

PLAT RECORDED IN  
 P.B. NO. 67 PAGE 6 of 24



SURVEYOR'S CERTIFICATE

I, HEREBY CERTIFY THAT TO THE BEST OF MY KNOWLEDGE AND BELIEF, THIS IS A CORRECT AND ACCURATE PLAN AND THAT THIS PLAN IS IN COMPLIANCE WITH THE VIRGINIA CODE ANNOTATED SUBSECTIONS 55-79.58B AND E. I FURTHER CERTIFY THAT ALL UNITS OR PORTIONS THEREOF DEPICTED HEREON HAVE BEEN SUBSTANTIALLY COMPLETED.

*G. T. Wilson, Jr.*  
 G. T. WILSON, JR., C.L.S. DATE 8-1-97

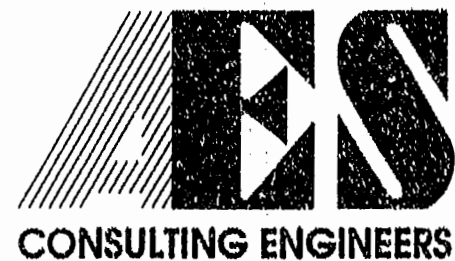
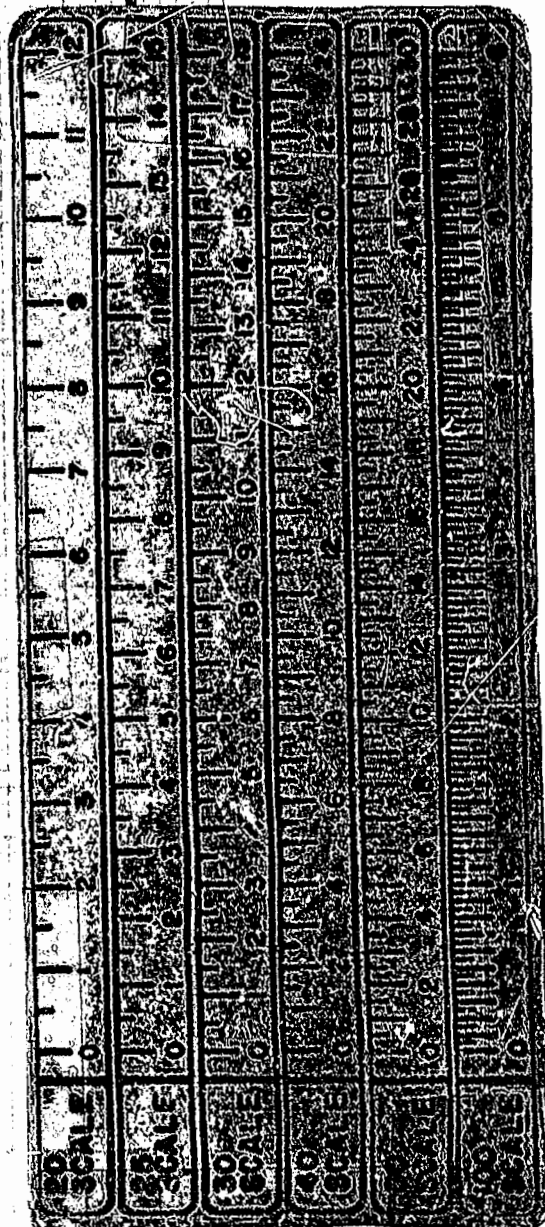

5248 Olde Towne Road, Suite 1  
 Williamsburg, Virginia 23188  
 (804) 253-0040  
 Fax (804) 220-8994

EXHIBIT A-3  
**PLAT OF CONDOMINIUM  
 MANOR CLUB  
 AT FORD'S COLONY  
 PHASE VII**  
 OWNER/DEVELOPER: MARRIOTT OWNERSHIP RESORTS, INC.  
 POWHATAN DISTRICT JAMES CITY COUNTY VIRGINIA

| No. | DATE | REVISION / COMMENT / NOTE | BY |
|-----|------|---------------------------|----|
|     |      |                           |    |
|     |      |                           |    |
|     |      |                           |    |
|     |      |                           |    |

|                        |                |
|------------------------|----------------|
| Designed<br>ADS        | Drawn<br>RMJ   |
| Scale<br>NONE          | Date<br>6/1/97 |
| Project No.<br>7739-CE |                |
| Drawing No.<br>9 of 9  |                |