

NOTES:

1. THE LOWER (HORIZONTAL) BOUNDARY OF EACH UNIT IN BUILDING "G" SHOWN ON THE PLAT AS LOCATED ON PHASE VII IS THE HORIZONTAL PLANE OF THE UPPER SURFACE OF THE FLOOR SLAB OF THE UNIT.
2. THE UPPER (HORIZONTAL) BOUNDARY OF EACH OF THE UNITS IN BUILDING "G" SHOWN ON THE PLAT AS LOCATED ON PHASE VII IS THE HORIZONTAL PLANE (S) OF THE LOWER SURFACE OF THE FLOOR SLAB CONSTITUTING THE CEILING OF THE UNIT; IT BEING UNDERSTOOD THAT THE TEXTURED CEILING COATING IS PART OF THE UNIT.

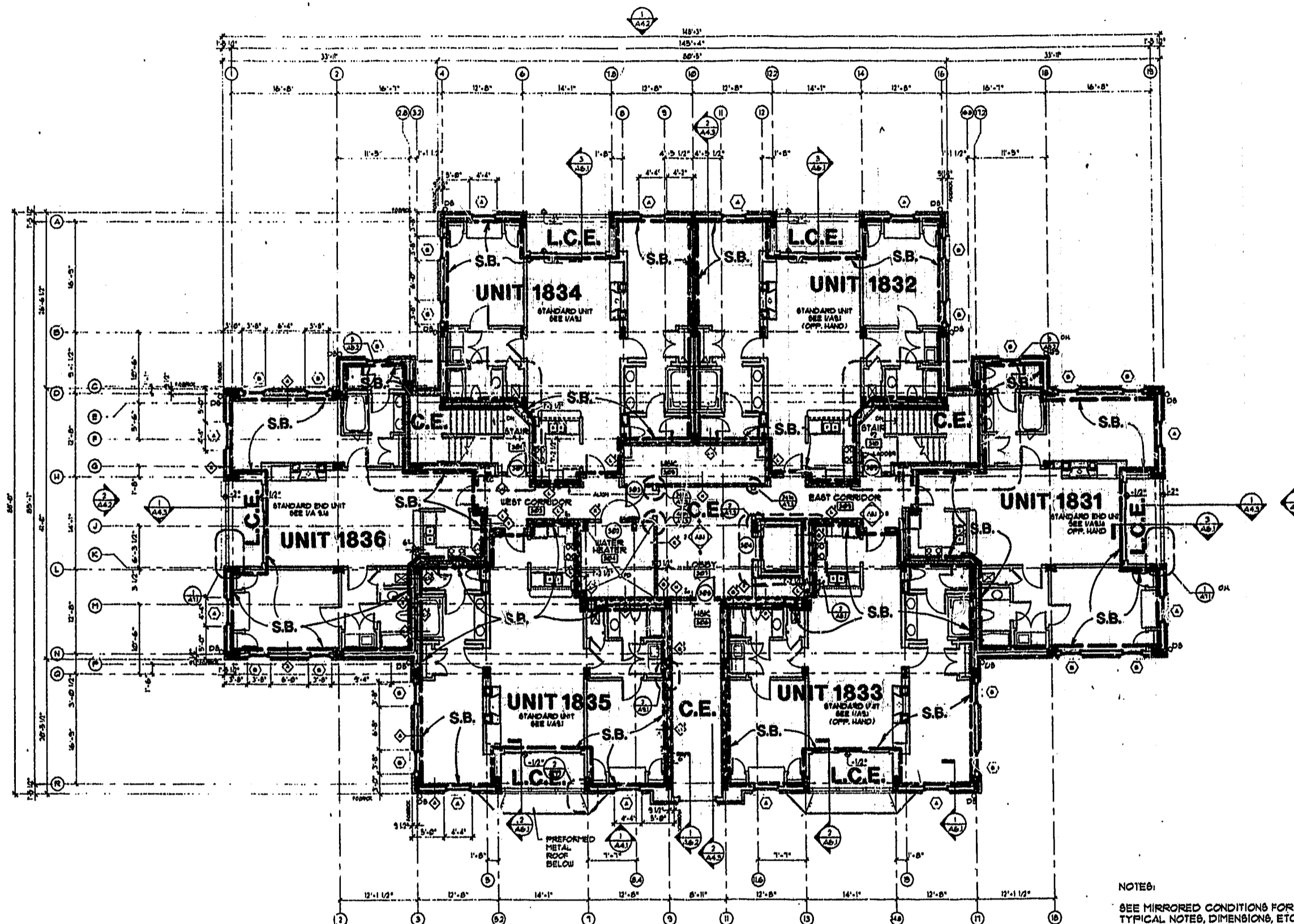

THIRD LEVEL FLOOR PLAN  
UNITS 1831 THRU 1836

LEGEND:

S.B. - SIDE (PERIMETRIC) BOUNDARY  
C.E. - COMMON ELEMENT  
L.C.E. - LIMITED COMMON ELEMENT

NOTE:  
BOLD DIMENSIONS BASED ON ACTUAL FIELD MEASUREMENTS.  
OTHER DATA TAKEN FROM PLANS PER NICHOLS CARTER GRANT ARCHITECTS.

NOTES:  
SEE MIRRORED CONDITIONS FOR  
TYPICAL NOTES, DIMENSIONS, ETC.

PLAT RECORDED IN  
P.B. NO. 69 PAGE 16-24

Recorded 21 day of April 1998  
DOCUMENT # 9800772 3:17PM  
Rory Wadbridge, Clerk

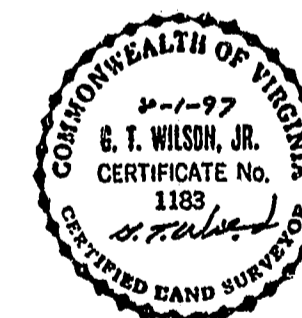

SURVEYOR'S CERTIFICATE

I, HEREBY CERTIFY THAT TO THE BEST OF MY KNOWLEDGE AND BELIEF, THIS IS A CORRECT AND ACCURATE PLAN AND THAT THIS PLAN IS IN COMPLIANCE WITH THE VIRGINIA CODE ANNOTATED SUBSECTIONS 55-79.58B AND E. I FURTHER CERTIFY THAT ALL UNITS OR PORTIONS THEREOF DEPICTED HEREON HAVE BEEN SUBSTANTIALLY COMPLETED.

G. T. WILSON, JR., C.L.S.

8-1-97  
DATE

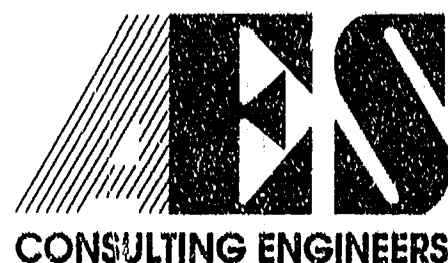

5248 Olde Towne Road, Suite 1  
Williamsburg, Virginia 23188  
(804) 253-0040  
Fax (804) 220-8994

EXHIBIT A-3  
**PLAT OF CONDOMINIUM  
MANOR CLUB  
AT FORD'S COLONY  
PHASE VII**  
OWNER/DEVELOPER: MARRIOTT OWNERSHIP RESORTS, INC.  
POWHATAN DISTRICT JAMES CITY COUNTY VIRGINIA

No.	DATE	REVISION / COMMENT / NOTE	BY

Designed ADS	Drawn RMJ
Scale NOTED	Date 8/1/97
Project No. 7739-CE	
Drawing No. 4 of 9	