

NOTE:  
**BOLD DIMENSIONS** BASED ON ACTUAL FIELD MEASUREMENTS.  
 OTHER DATA TAKEN FROM PLANS PER NICHOLS CARTER GRANT ARCHITECTS.

END UNIT FLOOR PLAN

UNIT NO.	ORIENTATION
1711	FLIPPED
1716	SAME
1721	FLIPPED
1726	SAME
1731	FLIPPED
1736	SAME

**BOLD DIMENSIONS** SHOWN ARE TYPICAL AND BASED ON ACTUAL FIELD MEASUREMENTS OF UNITS.

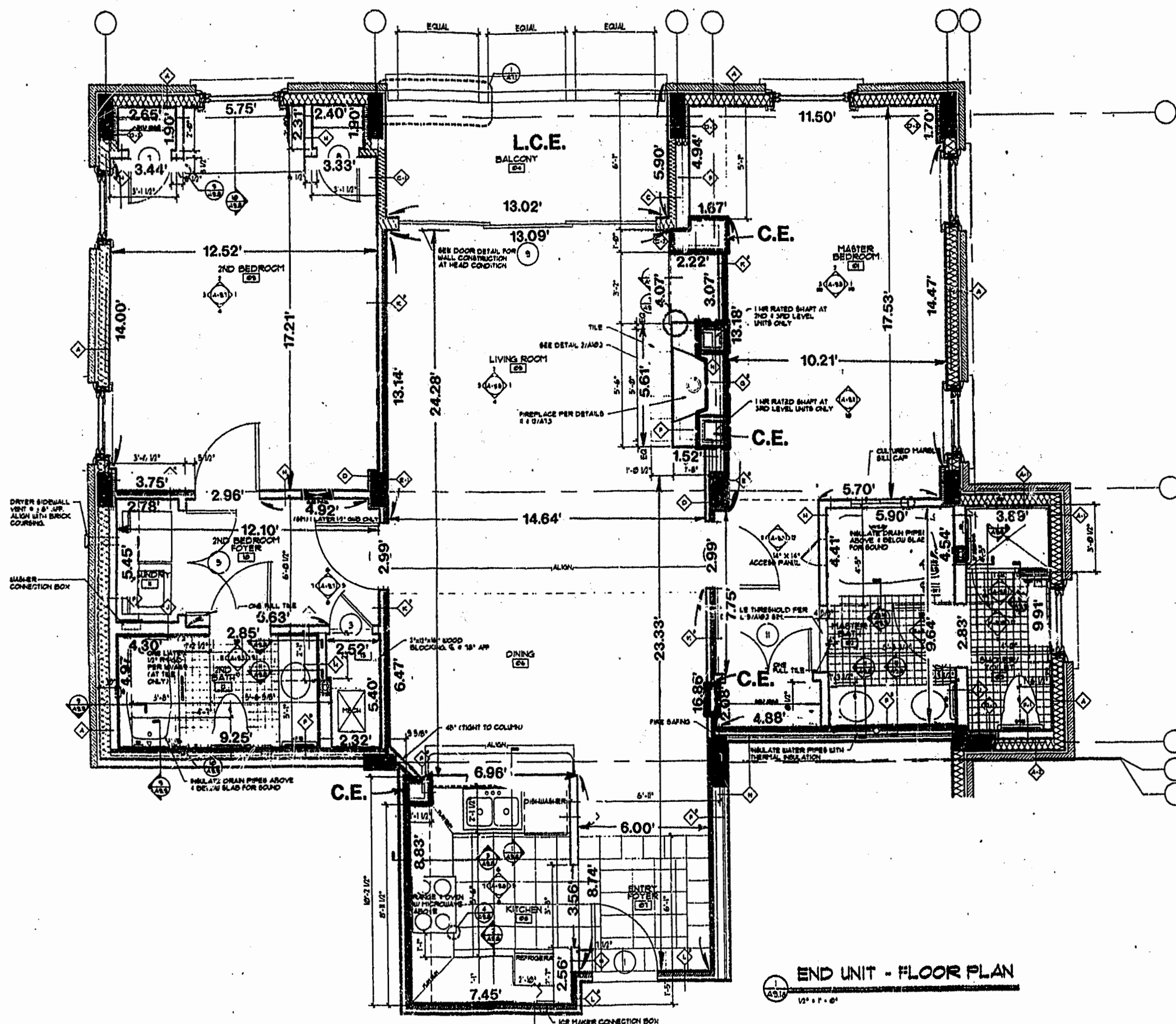

END UNIT - FLOOR PLAN



SURVEYOR'S CERTIFICATE

I, HEREBY CERTIFY THAT TO THE BEST OF MY KNOWLEDGE AND BELIEF, THIS IS A CORRECT AND ACCURATE PLAN AND THAT THIS PLAN IS IN COMPLIANCE WITH THE VIRGINIA CODE ANNOTATED SUBSECTIONS 55-79.58B AND E. I FURTHER CERTIFY THAT ALL UNITS OR PORTIONS THEREOF DEPICTED HEREON HAVE BEEN SUBSTANTIALLY COMPLETED.

1:51pm  
 Recorded 12 day of Dec. 1997  
 DOCUMENT # 970-19646  
*Nicholas S. Grant* Clerk  
*By Claudia H. B... / Wp Clerk*

*G. T. Wilson, Jr.*  
 G. T. WILSON, JR., C.L.S.      DATE 8-1-97

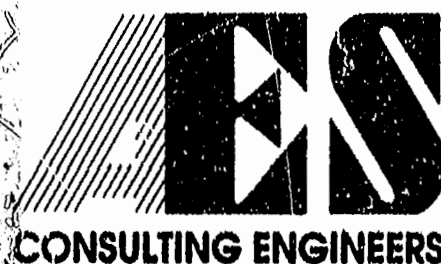

5248 Olde Towne Road, Suite 1  
 Williamsburg, Virginia 23188  
 (804) 253-0040  
 Fax (804) 220-8994

**EXHIBIT A-3**

**PLAT OF CONDOMINIUM  
 MANOR CLUB  
 AT FORD'S COLONY  
 PHASE VI**

OWNER/DEVELOPER: MARRIOTT OWNERSHIP RESORTS, INC.  
 POWHATAN DISTRICT JAMES CITY COUNTY VIRGINIA

No.	DATE	REVISION / COMMENT / NOTE	BY

Designed ADS	Drawn RMJ
Scale NONE	Date 8/1/97
Project No. <b>7739-CE</b>	
Drawing No. <b>10 of 10</b>	