

LOCATION MAP
1" = 4000'

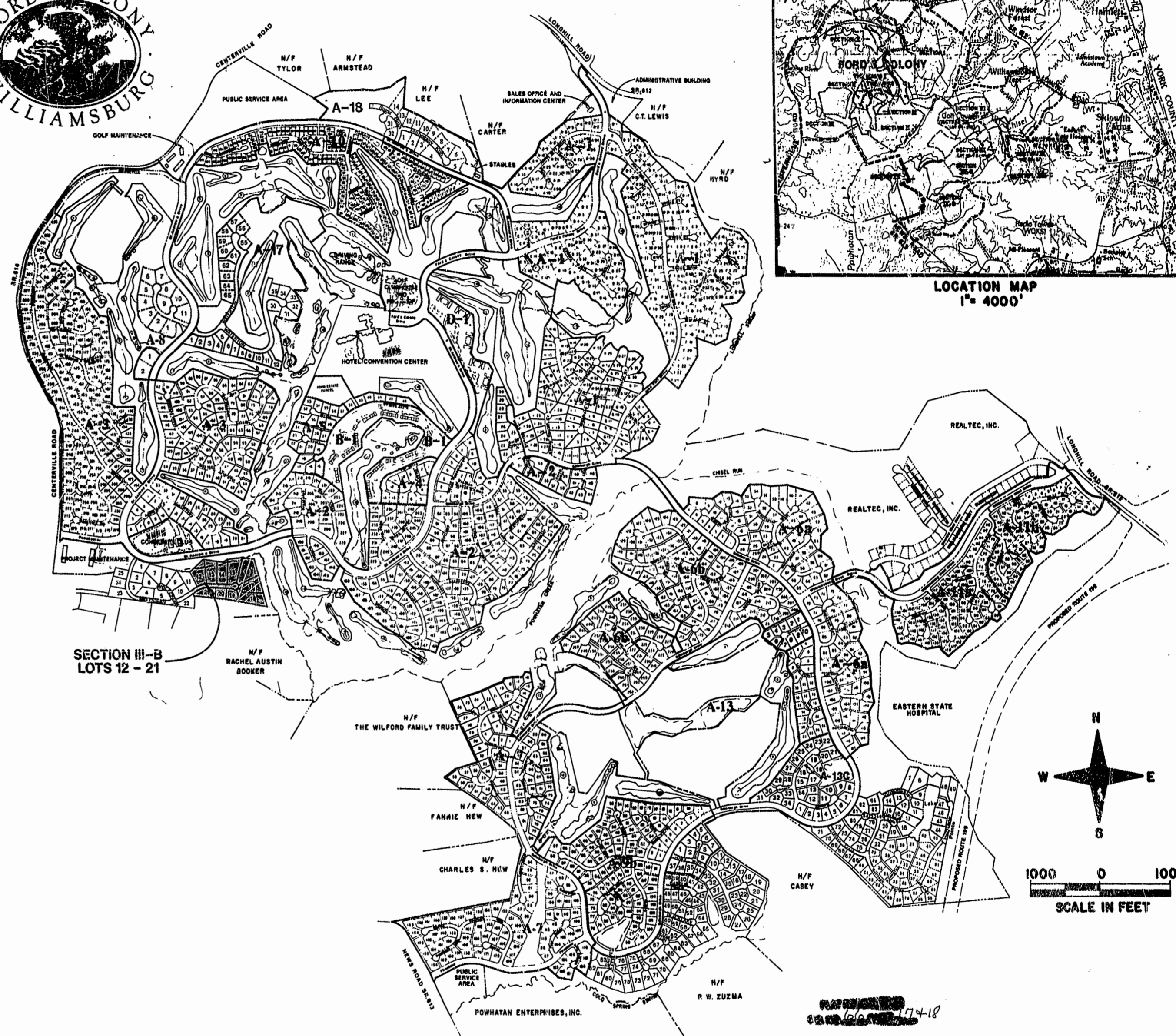

OWNER'S CONSENT AND DEDICATION

THE SUBDIVISION OF LAND SHOWN ON THIS PLAT AND KNOWN AS FORD'S COLONY AT WILLIAMSBURG, SECTION III-B, LOTS 12 - 21 IS WITH THE FREE CONSENT AND IN ACCORDANCE WITH THE DESIRES OF THE UNDERSIGNED OWNERS, PROPRIETORS AND OR TRUSTEES.

[Signature] VP
FOR REALTEC INCORPORATED DATE 1-10-97

CERTIFICATE OF NOTARIZATION

STATE OF VIRGINIA

IN AND FOR THE COUNTY OF JAMES CITY

I, **THOMAS G. PENDLETON**, A NOTARY PUBLIC IN AND FOR THE CITY/COUNTY AND STATE AFORESAID, DO HEREBY CERTIFY THAT THE PERSONS WHOSE NAMES ARE SIGNED TO THE FOREGOING WRITING HAVE ACKNOWLEDGED THE SAME BEFORE ME IN THE CITY/COUNTY AFORESAID, GIVEN UNDER MY NAME THIS 10 DAY OF JAN 1997

[Signature]
SIGNATURE

CERTIFICATION OF SOURCE OF TITLE

TITLE TO THE LAND SHOWN HEREON IS VESTED IN THE NAME OF REALTEC, INCORPORATED AND WAS ACQUIRED FROM RICHARD J. FORD BY DEED DATED SEPTEMBER 13, 1986 SHOWN AS INSTRUMENT #14234 IN THE CLERK'S OFFICE OF THE CIRCUIT COURT IN THE COUNTY OF JAMES CITY.

ENGINEER OR SURVEYOR'S CERTIFICATE

I HEREBY CERTIFY THAT TO THE BEST OF MY KNOWLEDGE OR BELIEF, THIS PLAT COMPLIES WITH ALL OF THE REQUIREMENTS OF THE BOARD OF SUPERVISORS AND ORDINANCES OF THE COUNTY OF JAMES CITY, VIRGINIA, REGARDING THE PLATTING OF SUBDIVISIONS WITHIN THE COUNTY.

[Signature] G. T. WILSON, JR., C.L.S.
DATE 1-7-97

CERTIFICATE OF APPROVAL

THIS SUBDIVISION IS APPROVED BY THE UNDERSIGNED IN ACCORDANCE WITH THE EXISTING SUBDIVISION REGULATIONS AND MAY BE ADMITTED TO RECORD.

[Signature] SUBDIVISION AGENT OF JAMES CITY COUNTY DATE 2/14/97

GENERAL NOTES:

1. PROPERTY IS ZONED RESIDENTIAL PLANNED COMMUNITY, R-4.
2. ALL LOTS ARE TO BE PROVIDED WITH WATER AND SEWER SERVICE BY THE JAMES CITY SERVICE AUTHORITY.
3. ALL STREETS ARE TO BE PRIVATELY OWNED AND MAINTAINED.
4. ALL LOTS ARE WITHIN THE ORIGINAL BOUNDARY SURVEY OF RECORD.
5. FOR THE PURPOSE OF COMPLIANCE WITH BUILDING LOCATIONS REQUIREMENTS PURSUANT TO SECTION 20-218 OF THE JAMES CITY COUNTY ZONING ORDINANCE, BUILDING RESTRICTION LINES, CONSTRUCTION AREA LIMITS, AND SETBACK LINES REFERRED TO THEREIN ARE HEREBY COINCIDENT WITH THE LOT PROPERTY LINES. OWNERS AND BUILDERS ARE REFERRED TO THE "DECLARATION OF PROTECTIVE COVENANTS AND THE SUPPLEMENTAL DECLARATION OF PROTECTIVE COVENANTS, SECTION III-B FORD'S COLONY AT WILLIAMSBURG" FOR ADDITIONAL BUILDING RESTRICTIONS AND REGULATIONS IMPOSED BY THE DEVELOPER AND OR HIS ASSIGNS.

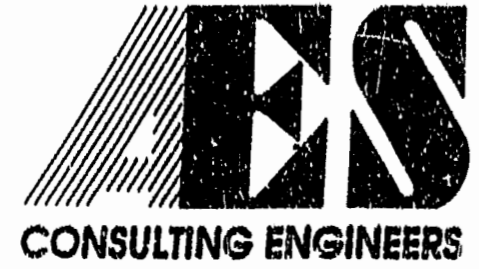
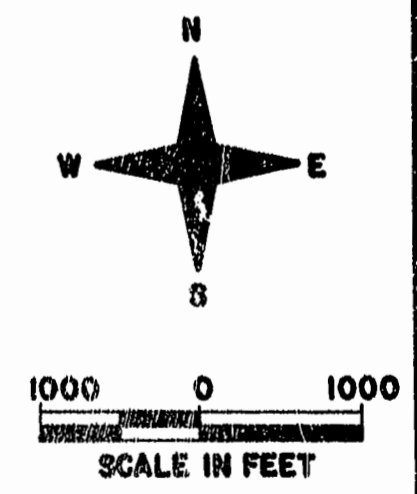
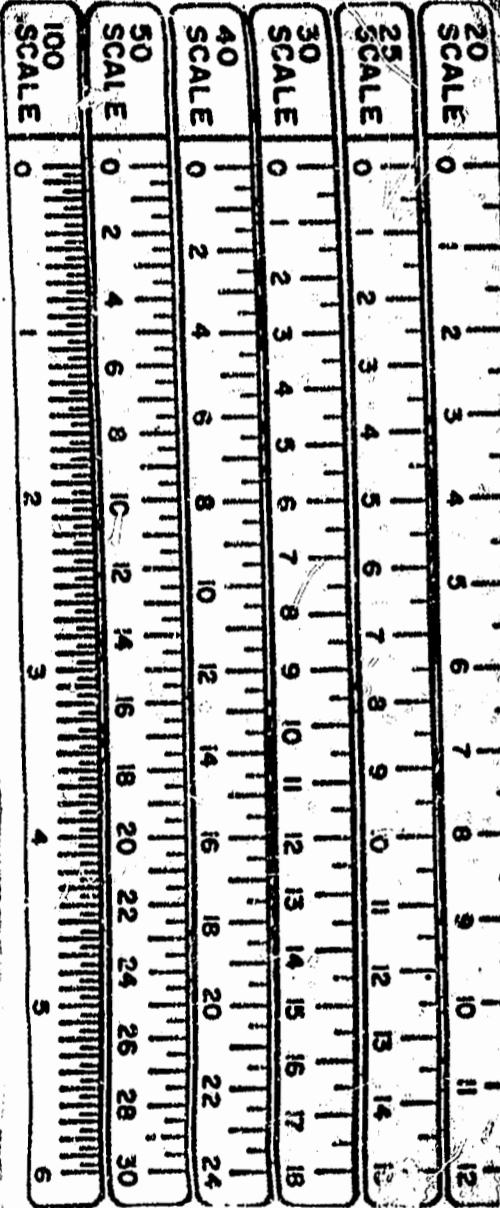

5248 Olde Towne Road, Suite 1
Williamsburg, Virginia 23188
(804) 253-0040
Fax (804) 220-8994

PLAT OF
FORD'S COLONY
@ WILLIAMSBURG
SECTION III-B, LOTS 12 - 21
POWhatan DISTRICT JAMES CITY COUNTY VIRGINIA



DESIGNED	12:53 PM	1/7/97
DRAWN	1/7/97	1/7/97
SCALE	NOTED	1/7/97
PROJECT NO.	5652-3B	
DRAWING NO.	10F 2	
DATE	REVISION / COMMENT / NOTE	BY

DESIGNED	LCA/AES	DRAWN	AES
SCALE	NOTED	DATE	1/7/97
PROJECT NO.	5652-3B	DRAWING NO.	10F 2