

NUMBER	DELTA	RADIUS	ARC LENGTH	TANGENT	CHORD	CHORD BEARING
C1	05°30'54"	1944.86	187.20	93.67	187.13	N 86°24'31" E

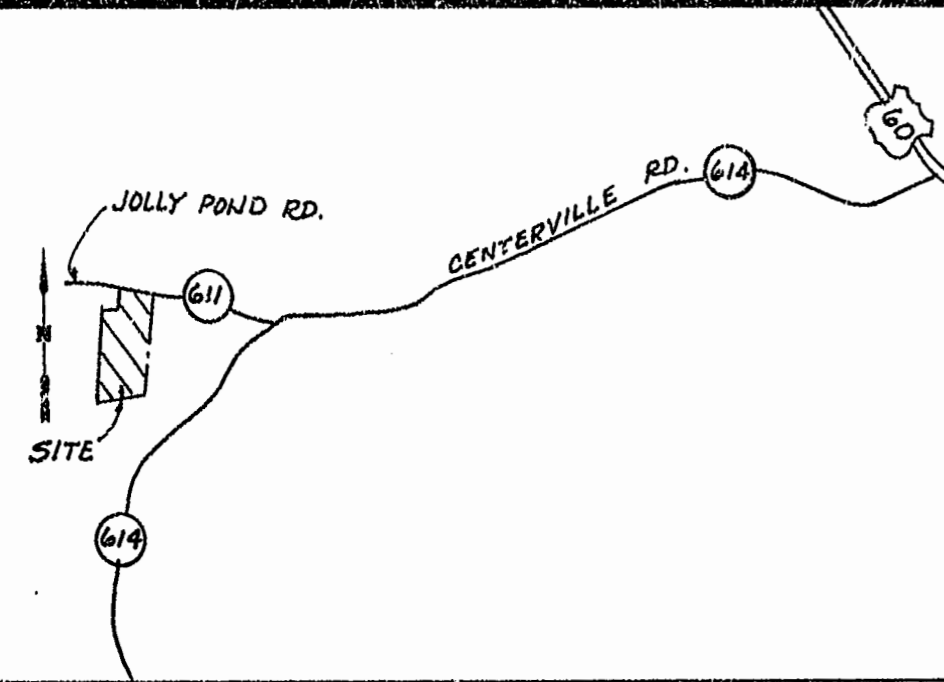

VICINITY MAP 1" = 2000'

OWNER'S CERTIFICATE

THE SUBDIVISION OF LAND SHOWN ON THIS PLAT AND KNOWN AS HIPPLE FAMILY SUBDIVISION IS WITH FREE CONSENT AND IN ACCORDANCE WITH THE DESIRES OF THE UNDERSIGNED OWNERS, PROPRIETORS AND OR TRUSTEES.

1-23-97 Thomas J. Hipple, Jr. DATE NAME
1/23/97 Ann E. Hipple DATE NAME

CERTIFICATE OF NOTARIZATION

STATE OF VIRGINIA
CITY/COUNTY OF James City County, Virginia A NOTARY PUBLIC IN AND FOR THE CITY/COUNTY AND STATE AFORESAID, DO HEREBY CERTIFY THAT THE PERSON WHOSE NAME IS SIGNED TO THE FOREGOING WRITING HAS ACKNOWLEDGED THE SAME BEFORE ME IN THE CITY/COUNTY AFORESAID. GIVEN UNDER MY HAND THIS 23 DAY OF January, 1997. MY COMMISSION EXPIRES December 31, 2000.

CERTIFICATE OF SOURCE OF TITLE

THE PROPERTY SHOWN ON THIS PLAT WAS CONVEYED BY RICHARD CARTER COWLES & JAQUELIN Y COWLES TO THOMAS J. JR. & ANN E. HIPPLE BY DEED DATED 12/26/61 AND RECORDED IN THE OFFICE OF THE CLERK OF CIRCUIT COURT OF THE COUNTY OF JAMES CITY IN DEED BOOK 84, PAGE 21.

ENGINEERS OR SURVEYOR'S CERTIFICATE

I HEREBY CERTIFY THAT TO THE BEST OF MY KNOWLEDGE OR BELIEF, THIS PLAT COMPLIES WITH ALL OF THE REQUIREMENTS OF THE BOARD OF SUPERVISORS AND ORDINANCES OF THE COUNTY OF JAMES CITY, VIRGINIA, REGARDING THE PLATTING OF SUBDIVISIONS WITHIN THE COUNTY.

1-22-97 Thomas C. Sublett DATE THOMAS C. SUBLETT L.S.#1886

CERTIFICATE OF APPROVAL

THIS SUBDIVISION IS APPROVED BY THE UNDERSIGNED IN ACCORDANCE WITH EXISTING SUBDIVISION REGULATIONS AND MAY BE ADMITTED TO RECORD.

1-24-97 Valerie S. ... DATE VIRGINIA DEPARTMENT OF HEALTH
1/24/97 DATE SUBDIVISION AGENT OF JAMES CITY COUNTY

STATE OF VIRGINIA, JAMES CITY COUNTY
IN THE CLERK'S OFFICE OF THE CIRCUIT COURT FOR THE COUNTY OF JAMES CITY THE 27th DAY OF January 1997
THIS MAP WAS PRESENTED AND ADMITTED TO RECORD AS THE LAW DIRECTS IN PLAT BOOK 65 PAGE 95
TESTE BY [Signature] CLERK

- * ZONING DISTRICT : A1
- * BUILDING SETBACK :
FRONT = 50'
REAR = 35'
SIDE = 15'

NOTES:
NEW LOT (PARCEL 4) SERVED BY WELL AND SEPTIC TANK.

Presented 27 day of January 1997
DOCUMENT # 2000185
[Signature] Clerk

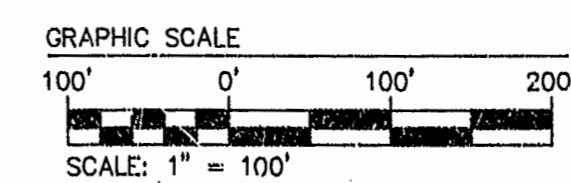
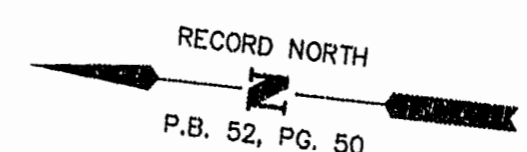

PLAT RECORDED IN
P.B. NO. 65 PAGE 95

COMMISSION NO. 5805
1 OF 1



ENGINEERS • ARCHITECTS • SURVEYORS
INTERIOR DESIGNERS • PLANNERS
P.O. BOX 3505 WILLIAMSBURG, VIRGINIA 23187
(804)253-0673 (804)874-5015

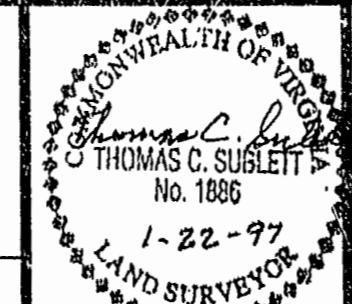

REF.
PB 32; PG. 32-33
PB 52; PG. 50
VDOT PROJ. NO. 0611-047-137, M-501
SHT NO. 7
DB 476; PG. 4
FB 169/11, 141/42 & 118/61

FAMILY SUBDIVISION
HIPPLE FAMILY
OWNER/DEVELOPER:
THOMAS J. JR. & ANN E. HIPPLE
POWHATAN DISTRICT, JAMES CITY COUNTY VIRGINIA

DATE 12/13/96 DESIGNED TCS DRAWN CLJ SCALE 1"=100'

