

NOTE:
BOLD DIMENSIONS BASED ON ACTUAL FIELD MEASUREMENTS.
 OTHER DATA TAKEN FROM PLANS PER NICHOLS CARTER GRANT ARCHITECTS.

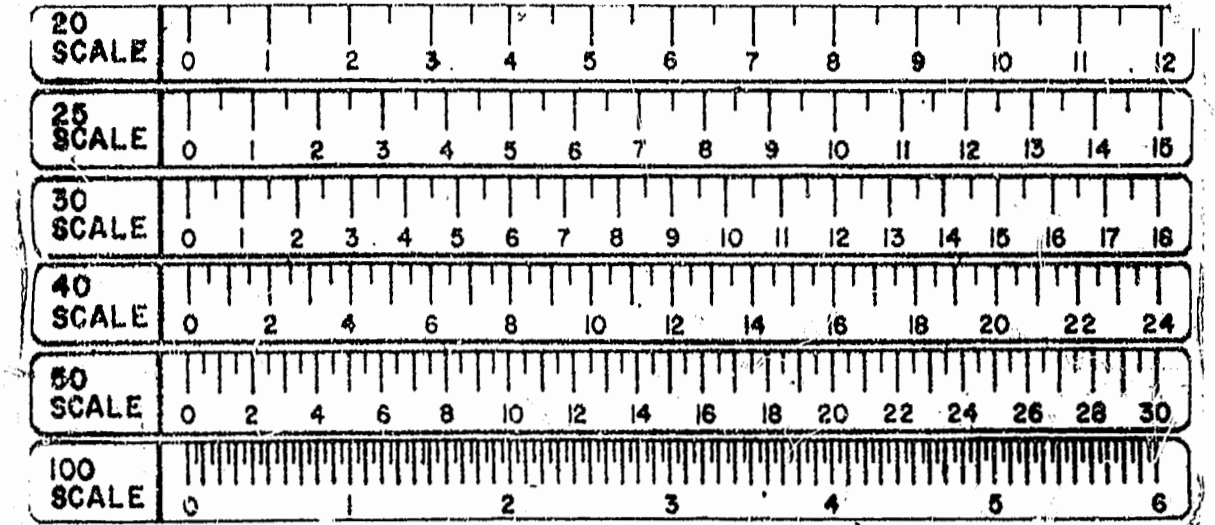

END UNIT FLOOR PLAN

UNIT NO.	ORIENTATION
1611	FLIPPED
1616	SAME
1621	FLIPPED
1626	SAME

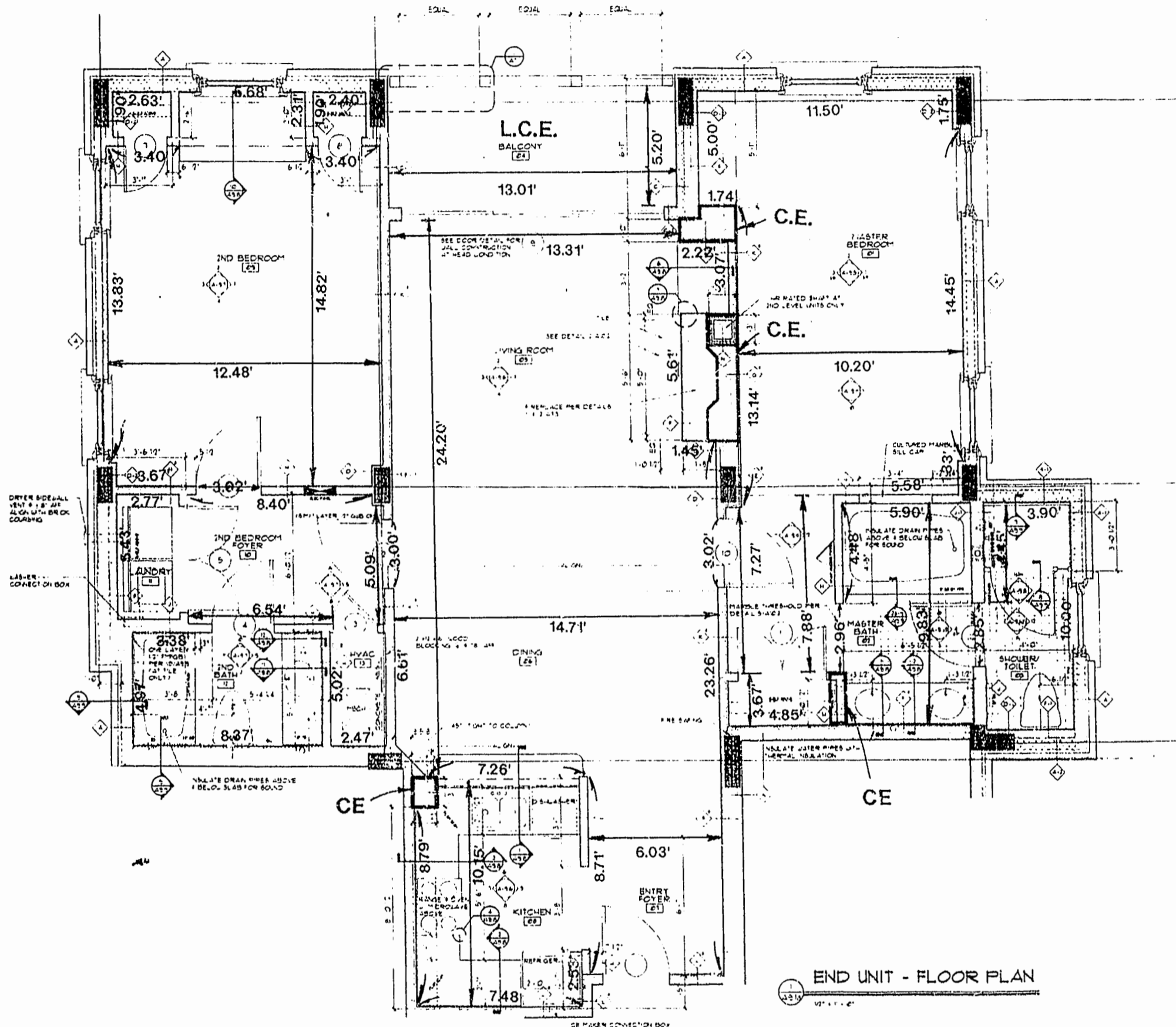

BOLD DIMENSIONS SHOWN ARE TYPICAL AND BASED ON ACTUAL FIELD MEASUREMENTS OF UNITS.



SURVEYOR'S CERTIFICATE

I, HEREBY CERTIFY THAT TO THE BEST OF MY KNOWLEDGE AND BELIEF, THIS IS A CORRECT AND ACCURATE PLAN AND THAT THIS PLAN IS IN COMPLIANCE WITH THE VIRGINIA CODE ANNOTATED SUBSECTIONS 55-79.58B AND E. I FURTHER CERTIFY THAT ALL UNITS OR PORTIONS THEREOF DEPICTED HEREON HAVE BEEN SUBSTANTIALLY COMPLETED.

G. T. Wilson, Jr.
 G. T. WILSON, JR., C.L.S. 2-9-96
 DATE

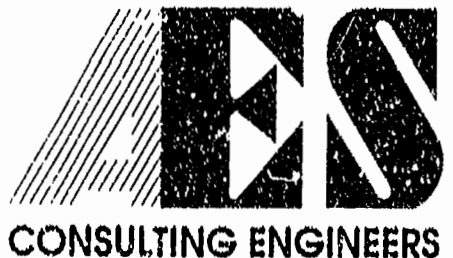

5248 Olde Towne Road, Suite 1
 Williamsburg, Virginia 23188
 (804) 253-0040
 Fax (804) 220-8994

EXHIBIT A-3
**PLAT OF CONDOMINIUM
 MANOR CLUB
 AT FORD'S COLONY
 PHASE V**
 OWNER/DEVELOPER: MARRIOTT OWNERSHIP RESORTS, INC.
 POWHATAN DISTRICT JAMES CITY COUNTY VIRGINIA

No.	DATE	REVISION / COMMENT / NOTE	BY
		3.5.1 Recorded 8 day of July 1996 D.B. No. 796 <i>[Signature]</i>	

Designed	Drawn
NONE	MMR
Scale	Date
NONE	2/9/96
Project No.	
7739 - CE	
Drawing No.	
10 of 10	