

NOTE: BOOK 64 PART 60
 BOLD DIMENSIONS BASED ON ACTUAL FIELD MEASUREMENTS.
 OTHER DATA TAKEN FROM PLANS PER NICHOLS CARTER GRANT ARCHITECTS.

20 SCALE	0 1 2 3 4 5 6 7 8 9 10 11 12
25 SCALE	0 1 2 3 4 5 6 7 8 9 10 11 12 13 14 15
30 SCALE	0 1 2 3 4 5 6 7 8 9 10 11 12 13 14 15 16 17 18
40 SCALE	0 2 4 6 8 10 12 14 16 18 20 22 24
60 SCALE	0 2 4 6 8 10 12 14 16 18 20 22 24 26 28 30
100 SCALE	0 1 2 3 4 5 6

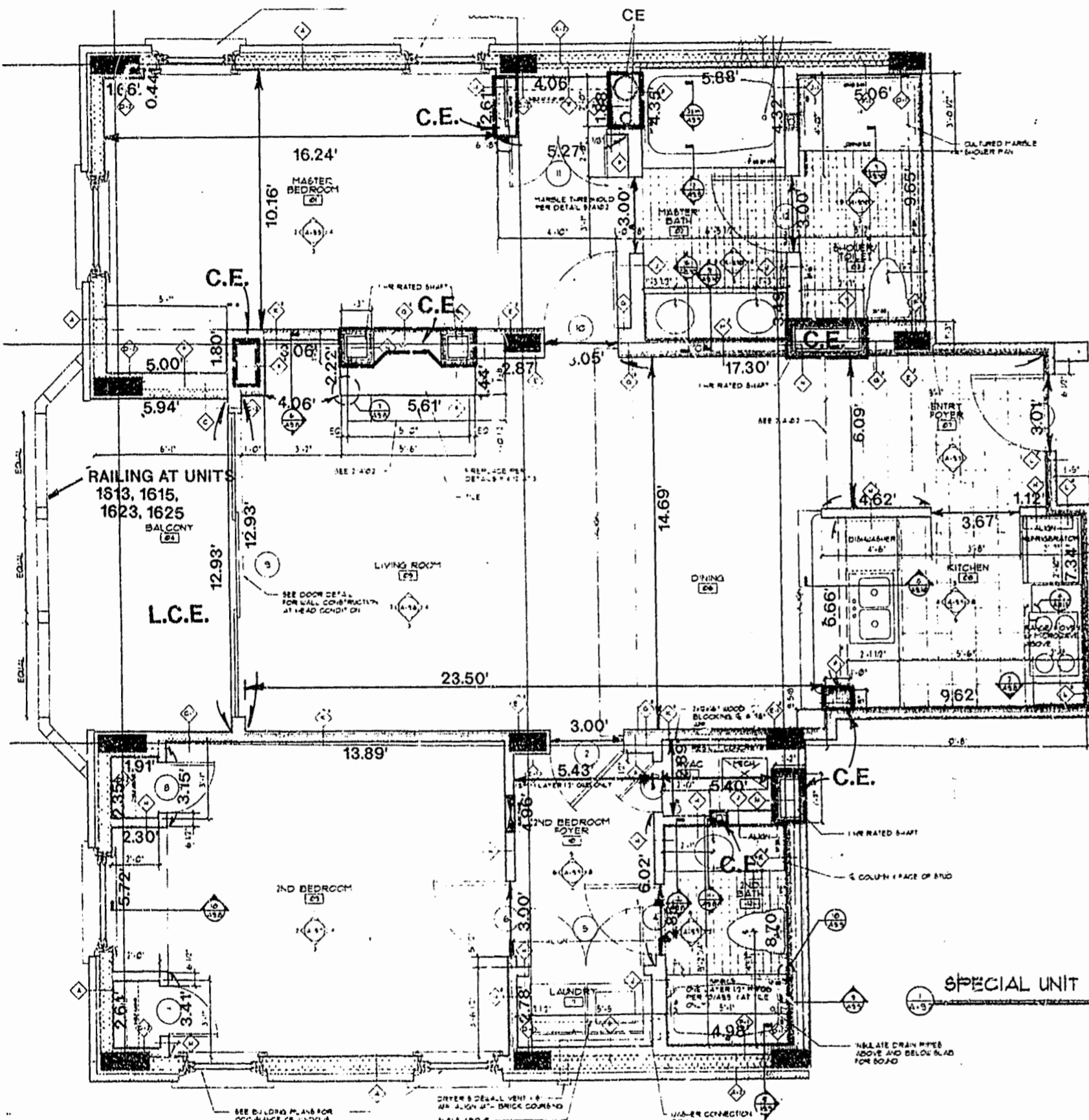

SPECIAL UNIT FLOOR PLAN

UNIT NO. 1615
 ORIENTATION SAME

BOLD DIMENSIONS SHOWN ARE TYPICAL AND BASED ON ACTUAL FIELD MEASUREMENTS OF UNITS.



SURVEYOR'S CERTIFICATE

I, HEREBY CERTIFY THAT TO THE BEST OF MY KNOWLEDGE AND BELIEF, THIS IS A CORRECT AND ACCURATE PLAN AND THAT THIS PLAN IS IN COMPLIANCE WITH THE VIRGINIA CODE ANNOTATED SUBSECTIONS 55-79.58B AND E. I FURTHER CERTIFY THAT ALL UNITS OR PORTIONS THEREOF DEPICTED HEREON HAVE BEEN SUBSTANTIALLY COMPLETED.

G. T. WILSON, JR., C.L.S. DATE 2-9-96

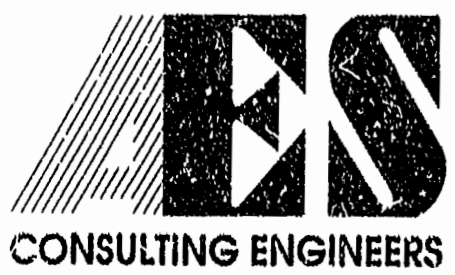

5248 Olde Towne Road, Suite 1
 Williamsburg, Virginia 23188
 (804) 253-0040
 Fax (804) 220-8994

EXHIBIT A-3

**PLAT OF CONDOMINIUM
 MANOR CLUB
 AT FORD'S COLONY
 PHASE V**

OWNER/DEVELOPER: MARRIOTT OWNERSHIP RESORTS, INC.
 POWHATAN DISTRICT JAMES CITY COUNTY VIRGINIA

Recorded	3:57	day of July 1996
D.B. No.	796	BOOK 64 PAGE 60
No. DATE REVISION / COMMENT / NOTE BY		

Designed	Drawn
Scale	Date
NONE	2/9/96
Project No.	
7739-CE	
Drawing No.	
9 of 10	