

MATCH LINE
SEE SHEET 4

GREENSPRINGS PLANTATION RESORT PHASE II

BERKELEY DISTRICT
JAMES CITY COUNTY, VIRGINIA
DATE: OCTOBER 18, 1995 SCALE: 1"=200'
REV: MARCH 1, 1996

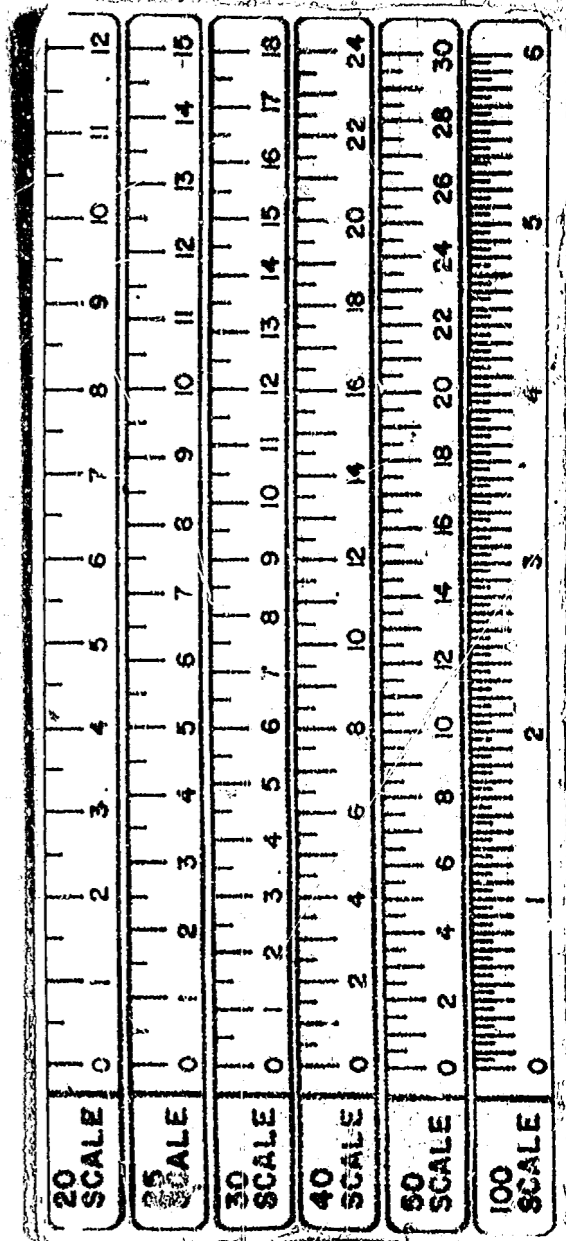
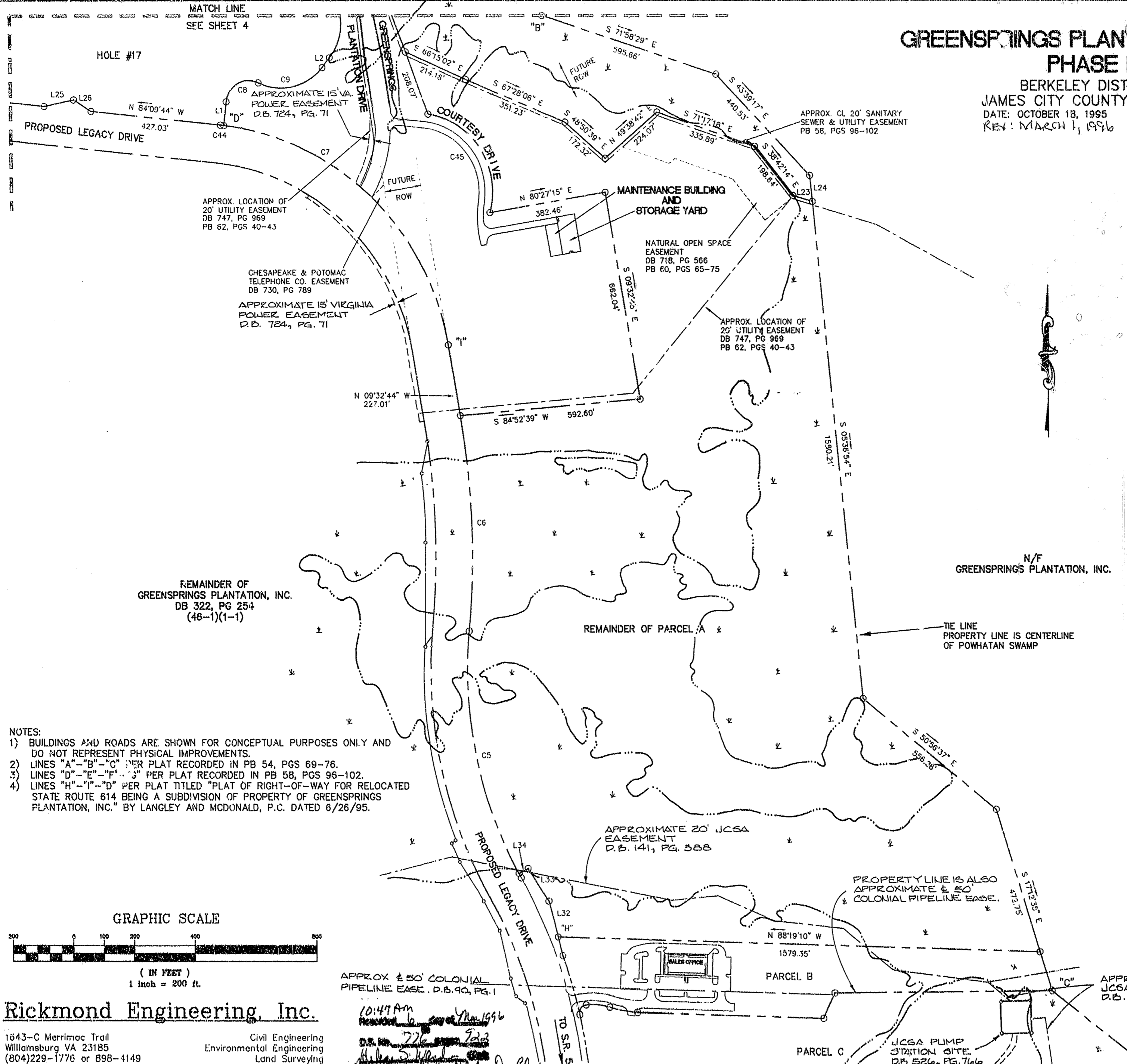

- NOTES:
- 1) BUILDINGS AND ROADS ARE SHOWN FOR CONCEPTUAL PURPOSES ONLY AND DO NOT REPRESENT PHYSICAL IMPROVEMENTS.
 - 2) LINES "A"- "B"- "C" PER PLAT RECORDED IN PB 54, PGS 69-76.
 - 3) LINES "D"- "E"- "F"- "G" PER PLAT RECORDED IN PB 58, PGS 96-102.
 - 4) LINES "H"- "I"- "J" PER PLAT TITLED "PLAT OF RIGHT-OF-WAY FOR RELOCATED STATE ROUTE 614 BEING A SUBDIVISION OF PROPERTY OF GREENSPRINGS PLANTATION, INC." BY LANGLEY AND McDONALD, P.C. DATED 6/26/95.

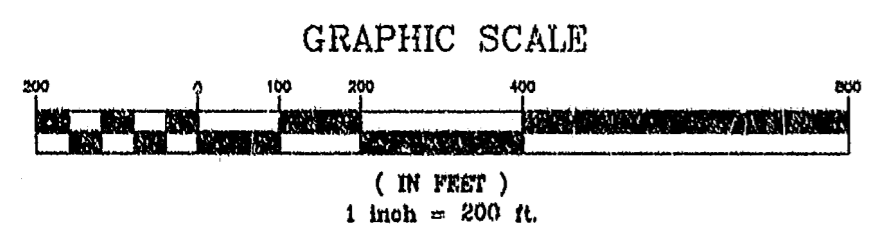

Rickmond Engineering, Inc.

1843-C Merrimac Trail
Williamsburg VA 23185
(804)229-1776 or 898-4149

Civil Engineering
Environmental Engineering
Land Surveying

APPROX. 50' COLONIAL PIPELINE EASE. D.B. 90, PG. 1

10:47 AM
REVISION 6
226
10/27/95
By: [Signature]
Checked: [Signature]

