

GREENSPRINGS PLANTATION RESORT PHASE II

BERKELEY DISTRICT
JAMES CITY COUNTY, VIRGINIA
DATE: OCTOBER 18, 1995 SCALE: 1"=200'

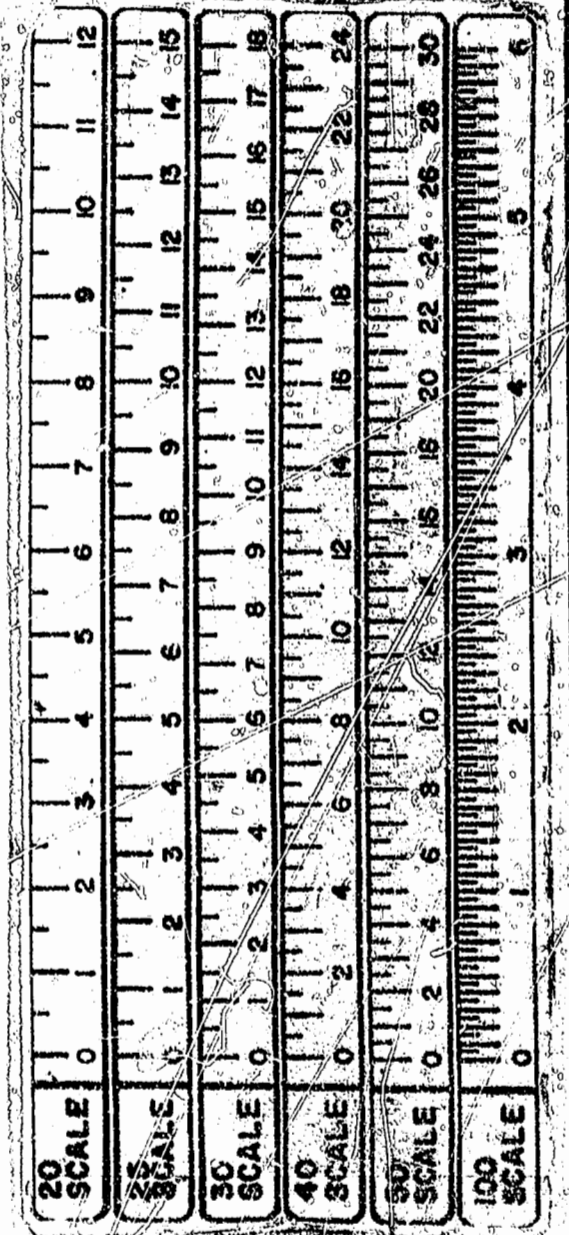

- NOTES:
- 1) BUILDINGS AND ROADS ARE SHOWN FOR CONCEPTUAL PURPOSES ONLY AND DO NOT REPRESENT PHYSICAL IMPROVEMENTS.
 - 2) LINES "A"-"B"-"C" PER PLAT RECORDED IN PB 54, PGS 69-76.
 - 3) LINES "D"-"E"-"F"-"G" PER PLAT RECORDED IN PB 58, PGS 96-102.
 - 4) LINES "H"-"I"-"J" PER PLAT TITLED "PLAT OF RIGHT-OF-WAY FOR RELOCATED STATE ROUTE 614 BEING A SUBDIVISION OF PROPERTY OF GREENSPRINGS PLANTATION, INC." BY LANGLEY AND MCDONALD, P.C. DATED 6/26/95.

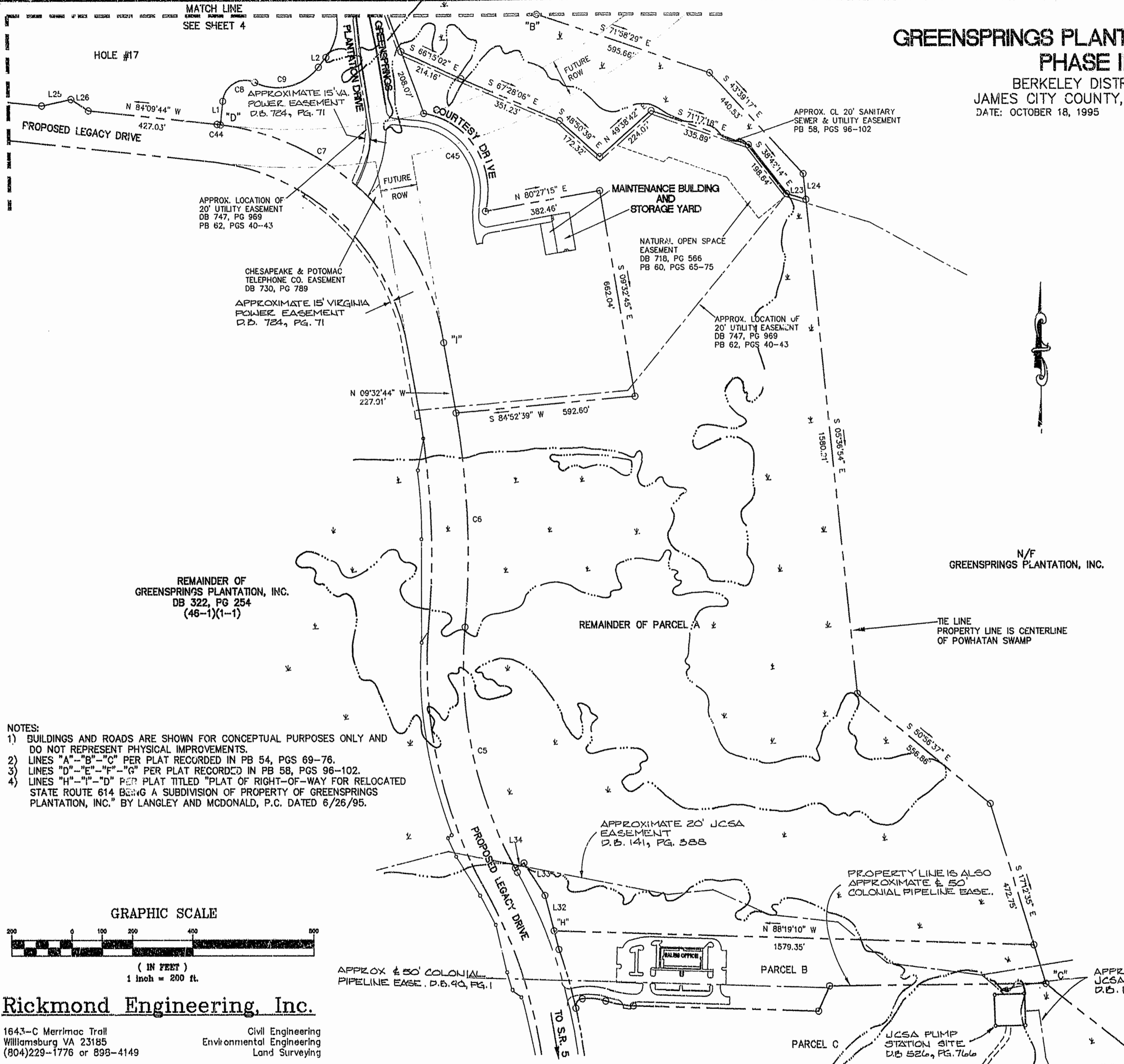
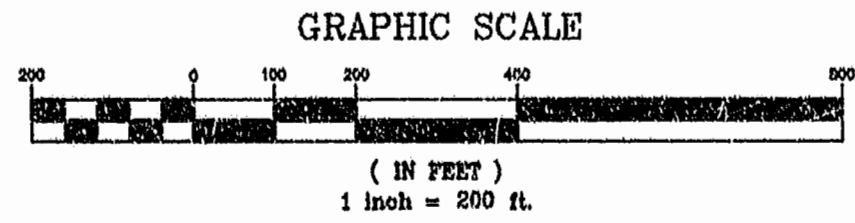

Rickmond Engineering, Inc.

1643-C Merrimac Trail
Williamsburg VA 23185
(804)229-1776 or 898-4149

Civil Engineering
Environmental Engineering
Land Surveying

Recorded 2/24/96
D.B. No. 725
DB 988 430
CIVIL ENGINEER

