

# GREENSPRINGS PLANTATION RESORT PHASE I

BERKELEY DISTRICT  
JAMES CITY COUNTY, VIRGINIA  
DATE: JUNE 1, 1995 SCALE: 1"=200'

REMAINDER OF  
GREENSPRINGS PLANTATION, INC  
DB 322, PG 254  
(46-1)(1-1)

- NOTES:
1. BUILDINGS AND ROADS ARE SHOWN FOR CONCEPTUAL PURPOSE ONLY AND DO NOT REPRESENT PHYSICAL IMPROVEMENTS.
  2. LINES "A"-"F" PER PLAT RECORDED IN PD 54, PGS. 67-76.
  3. LINES "D"-"G" PER PLAT RECORDED IN PD 54, PGS. 96-102.
  4. LINES "H"-"I"-"D" PER PLAT TITLED "PLAT OF RIGHT-OF-WAY FOR RELOCATED STATE ROUTE 164 BEING A SUBDIVISION OF PROPERTY OF GREENSPRINGS PLANTATION, INC. BY LANGLEY AND McDONALD, P.C. DATED 11/26/95"

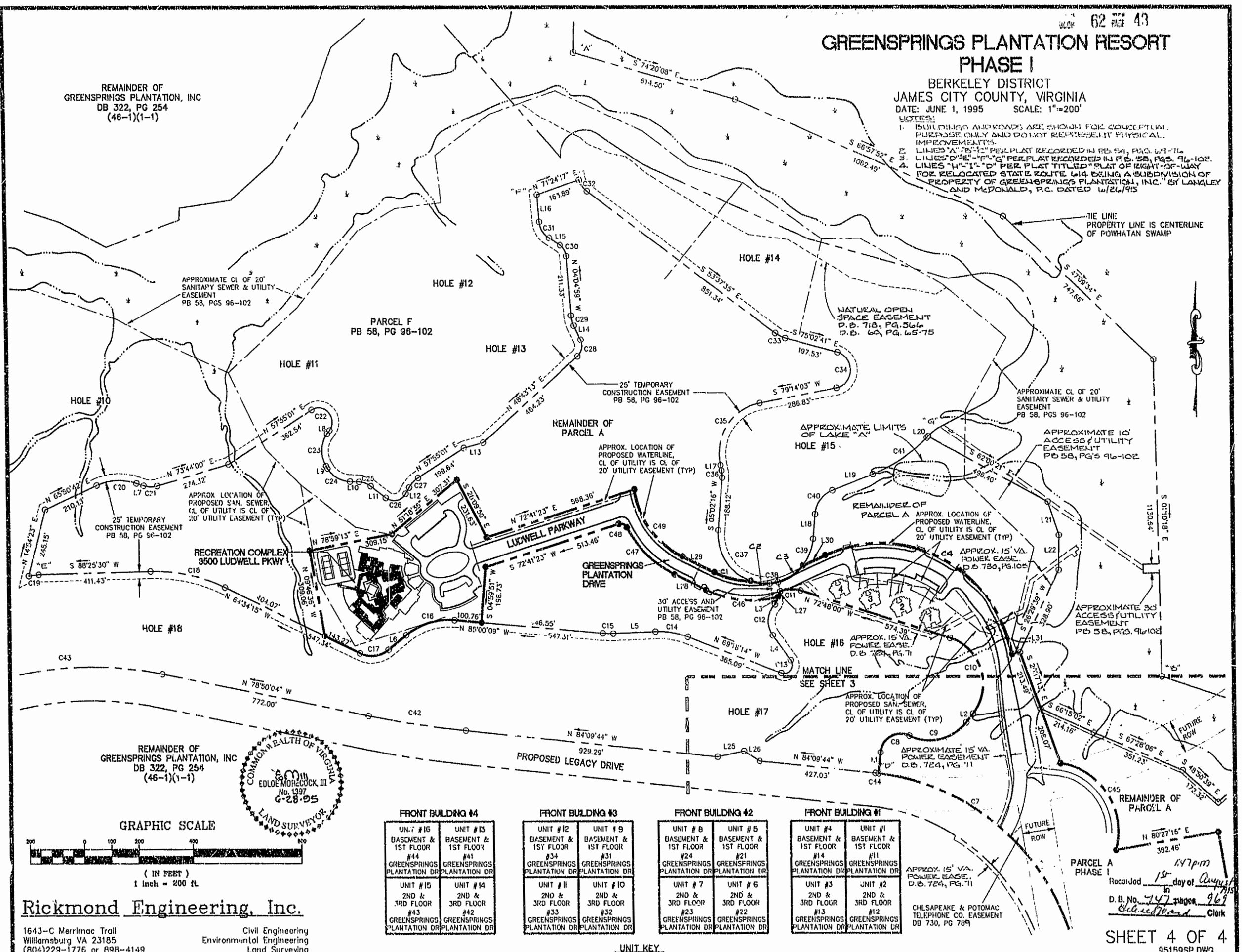

REMAINDER OF  
GREENSPRINGS PLANTATION, INC  
DB 322, PG 254  
(46-1)(1-1)

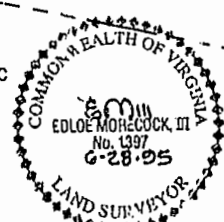

GRAPHIC SCALE

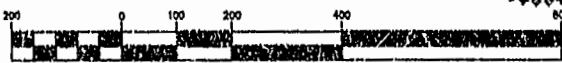

( IN FEET )  
1 inch = 200 ft

**Rickmond Engineering, Inc.**

1643-C Merrimac Trail  
Williamsburg VA 23185  
(804)229-1776 or 898-4149

Civil Engineering  
Environmental Engineering  
Land Surveying

FRONT BUILDING #4		FRONT BUILDING #3		FRONT BUILDING #2		FRONT BUILDING #1	
UNIT #16 BASEMENT & 1ST FLOOR #44 GREENSPRINGS PLANTATION DR	UNIT #13 BASEMENT & 1ST FLOOR #41 GREENSPRINGS PLANTATION DR	UNIT #12 BASEMENT & 1ST FLOOR #34 GREENSPRINGS PLANTATION DR	UNIT #9 BASEMENT & 1ST FLOOR #31 GREENSPRINGS PLANTATION DR	UNIT #8 BASEMENT & 1ST FLOOR #24 GREENSPRINGS PLANTATION DR	UNIT #5 BASEMENT & 1ST FLOOR #21 GREENSPRINGS PLANTATION DR	UNIT #4 BASEMENT & 1ST FLOOR #14 GREENSPRINGS PLANTATION DR	UNIT #1 BASEMENT & 1ST FLOOR #11 GREENSPRINGS PLANTATION DR
UNIT #15 2ND & 3RD FLOOR #43 GREENSPRINGS PLANTATION DR	UNIT #14 2ND & 3RD FLOOR #42 GREENSPRINGS PLANTATION DR	UNIT #11 2ND & 3RD FLOOR #33 GREENSPRINGS PLANTATION DR	UNIT #10 2ND & 3RD FLOOR #32 GREENSPRINGS PLANTATION DR	UNIT #7 2ND & 3RD FLOOR #23 GREENSPRINGS PLANTATION DR	UNIT #6 2ND & 3RD FLOOR #22 GREENSPRINGS PLANTATION DR	UNIT #3 2ND & 3RD FLOOR #13 GREENSPRINGS PLANTATION DR	UNIT #2 2ND & 3RD FLOOR #12 GREENSPRINGS PLANTATION DR

UNIT KEY

SHEET 4 OF 4  
95159SP.DWG

