



OWNER'S CONSENT AND DEDICATION
 THE SUBDIVISION OF LAND SHOWN ON THIS PLAT AND KNOWN AS FORD'S COLONY AT WILLIAMSBURG, SECTION XVI-A, IS WITH THE FREE CONSENT AND IN ACCORDANCE WITH THE DESIRES OF THE UNDERSIGNED OWNERS, PROPRIETORS AND OR TRUSTEES.
 DATE OCT 13, 1993 FOR REALTEC INCORPORATED

CERTIFICATE OF TITLE
 THE PROPERTY SHOWN ON THIS PLAT IS VESTED IN REALTEC INCORPORATED, SUCCESSOR BY MERGER TO FORD COLONY AT WILLIAMSBURG, INC. BY DEED DATED DECEMBER 13, 1986, AND RECORDED IN THE OFFICE OF THE CLERK OF THE CIRCUIT COURT OF THE COUNTY OF JAMES CITY IN DEED BOOK 324, PAGES 394

CERTIFICATE OF NOTARIZATION
 STATE OF VIRGINIA James City County
 CITY/COUNTY OF James City County
 I, STEVEN O. WIGLEY, A NOTARY PUBLIC IN AND FOR THE CITY/COUNTY AND STATE AFORESAID, DO HEREBY CERTIFY THAT THE PERSONS WHOSE NAMES ARE SIGNED TO THE FOREGOING WRITING HAVE ACKNOWLEDGED THE SAME BEFORE ME IN THE CITY/COUNTY AFORESAID, GIVEN UNDER MY HAND THIS 16 DAY OF OCTOBER, 1993.
Steven O. Wigley
 SIGNATURE
 MY COMMISSION EXPIRES MARCH 31, 1997

ENGINEER OF SURVEYOR'S CERTIFICATE
 I HEREBY CERTIFY THAT TO THE BEST OF MY KNOWLEDGE OR BELIEF THIS PLAT COMPLIES WITH ALL OF THE REQUIREMENTS OF THE BOARD OF SURVEYORS AND ORDINANCES OF THE COUNTY OF JAMES CITY, VIRGINIA, REGARDING THE PLATTING OF SUBDIVISIONS WITHIN THE COUNTY.
 DATE OCT 13, 1993 G. T. Wilson, Jr.
 G. T. WILSON, JR. C.E.S.

CERTIFICATE OF APPROVAL
 THIS SUBDIVISION IS APPROVED BY THE UNDERSIGNED IN ACCORDANCE WITH THE EXISTING SUBDIVISION REGULATIONS AND MAY BE SUBMITTED TO RECORD.
 DATE 10-1-93 John Stein
 VIRGINIA DEPARTMENT OF HEALTH
 DATE 10-2 Subdivision Agent of James City County

- GENERAL NOTES:**
1. PROPERTY IS ZONED RESIDENTIAL PLANNED COMMUNITY, R-4.
 2. ALL LOTS ARE TO BE PROVIDED WITH WATER AND SEWER SERVICE BY THE JAMES CITY SERVICE AUTHORITY.
 3. ALL STREETS ARE TO BE PRIVATELY OWNED AND MAINTAINED.
 4. ALL LOTS ARE WITHIN THE ORIGINAL BOUNDARY SURVEY OF RECORD.
 5. FOR THE PURPOSE OF COMPLIANCE WITH THE BUILDING LOCATIONS REQUIREMENTS PURSUANT TO SECTION 20-218 OF THE JAMES CITY COUNTY ZONING ORDINANCE, BUILDING RESTRICTION LINES, CONSTRUCTION AREA LIMITS, AND SETBACK LINES REFERRED TO THEREIN ARE HEREBY COINCIDENT WITH THE LOT PROPERTY LINES. OWNERS AND BUILDERS ARE REFERRED TO THE "DECLARATION OF PROTECTIVE COVENANTS AND THE SUPPLEMENTAL DECLARATION OF PROTECTIVE COVENANTS, SECTION XVI-A, FORD'S COLONY AT WILLIAMSBURG" FOR ADDITIONAL BUILDING RESTRICTIONS AND REGULATIONS IMPOSED BY THE DEVELOPER AND/OR HIS ASSIGNS.

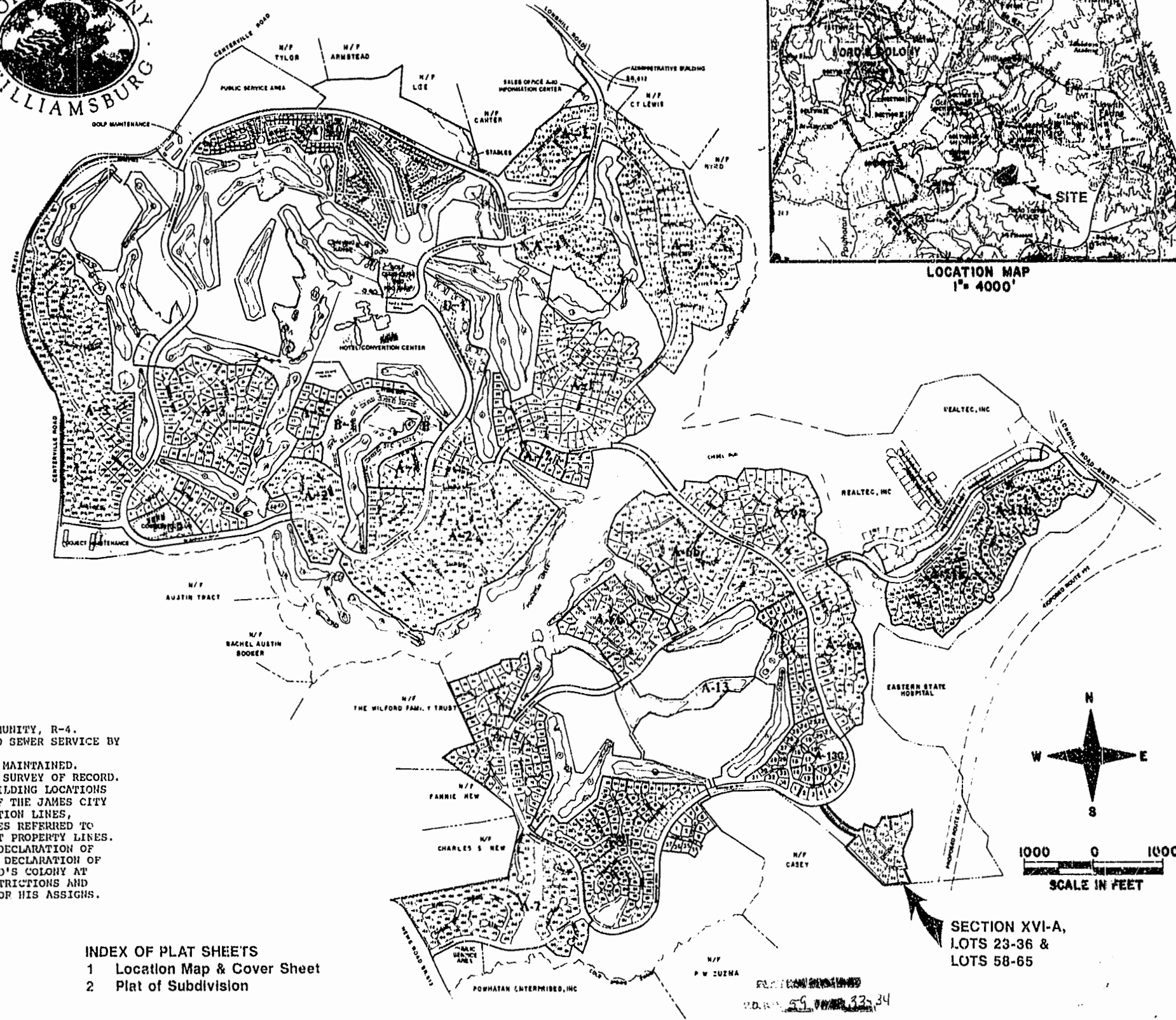

INDEX OF PLAT SHEETS
 1 Location Map & Cover Sheet
 2 Plat of Subdivision

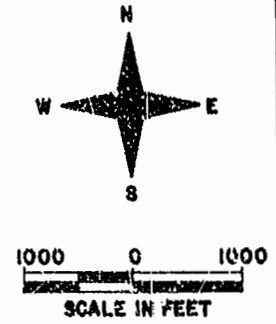

SECTION XVI-A,
 LOTS 23-36 &
 LOTS 58-65

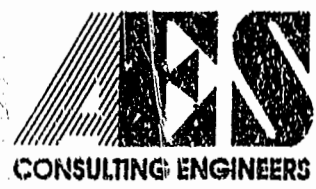

5248 Olde Towne Road, Suite 1
 Williamsburg, Virginia 23188
 (804) 253-0040
 Fax (804) 220-0094

CORRECTED
PLAT OF
FORD'S COLONY
@ WILLIAMSBURG
 SECTION XVI-A, LOTS 23-36 & LOTS 58-65
 BERKELEY DISTRICT JAMES CITY COUNTY VIRGINIA

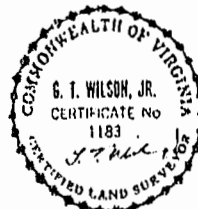

No.	DATE	REVISION / COMMENT / NOTE	BY
1	5/9/94	REVISOR SECTION NUMBER ONLY - 85% TO REC. XVI-A	BTW

Designed	Drawn
LCA/ABF	ERT
Scale	Date
NOTED	OCT. 1993
Project No.	
5652	
Drawing No.	
1 of 2	