

**LEGACY GOLF LINKS
AT GREENSPRINGS** BOOK 58 PAGE 96
BEING A
SUBDIVISION OF PROPERTY OF
GREENSPRINGS PLANTATION, INC.
BERKELEY DISTRICT
JAMES CITY COUNTY, VIRGINIA
FEBRUARY 18, 1994
SCALE: 1"=600'
SHEET 1 OF 7

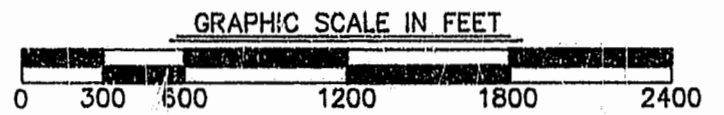

Langley and McDonald, P.C.
Engineers - Surveyors - Planners
Landscape Architects - Environmental Consultants
VIRGINIA BEACH WILLIAMSBURG



SPECIAL FLOOD HAZARD AREAS INUNDATED BY 100-YEAR FLOOD
 □ ZONE A: NO BASE FLOOD ELEVATIONS DETERMINED
 ▨ ZONE AE: BASE FLOOD ELEVATIONS DETERMINED
OTHER FLOOD AREAS
 ▨ ZONE X: AREAS OF 500-YEAR FLOOD, AREAS OF 100-YEAR FLOOD WITH AVERAGE DEPTHS OF LESS THAN 1 FOOT OR WITH DRAINAGE AREAS LESS THAN 1 SQUARE MILE; AND AREAS PROTECTED BY LEVEES FROM 100-YEAR FLOOD.
 □ ZONE X: AREAS DETERMINED TO BE OUTSIDE 500-YEAR FLOOD-PLAIN.

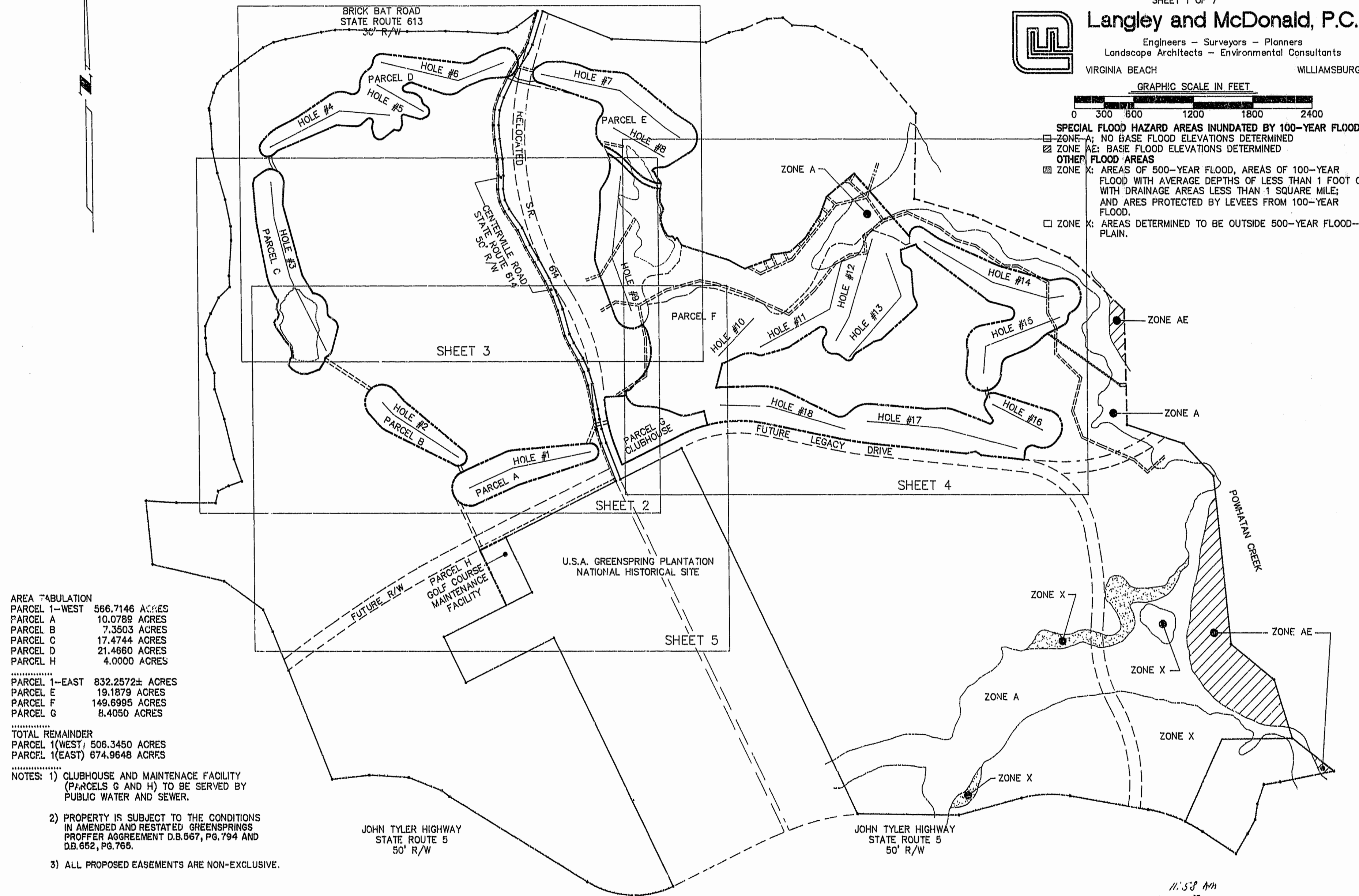

AREA TABULATION

PARCEL 1--WEST	566.7146 ACRES
PARCEL A	10.0789 ACRES
PARCEL B	7.3503 ACRES
PARCEL C	17.4744 ACRES
PARCEL D	21.4660 ACRES
PARCEL H	4.0000 ACRES

PARCEL 1--EAST	832.2572± ACRES
PARCEL E	19.1879 ACRES
PARCEL F	149.6995 ACRES
PARCEL G	8.4050 ACRES

TOTAL REMAINDER
 PARCEL 1(WEST) 506.3450 ACRES
 PARCEL 1(EAST) 674.9648 ACRES

- NOTES:**
- 1) CLUBHOUSE AND MAINTENANCE FACILITY (PARCELS G AND H) TO BE SERVED BY PUBLIC WATER AND SEWER.
 - 2) PROPERTY IS SUBJECT TO THE CONDITIONS IN AMENDED AND RESTATED GREENSPRINGS PROFFER AGREEMENT D.B.567, PG.794 AND D.B.652, PG.765.
 - 3) ALL PROPOSED EASEMENTS ARE NON-EXCLUSIVE.

FILED RECORDED IN
P.B. NO. 58 PAGE 96-102

11:58 AM
 Recorded 24 day of March 1994
 D.B. No. 58 PAGE 96-102
 By *[Signature]* Clerk
 By *[Signature]* Dep. Clerk