

WE HEREBY CERTIFY THAT THE ABOVE ADDED TO THE ORIGINAL PERMITS UNDER AND IN ACCORDANCE WITH THE CODES AND REGULATIONS OF THE CITY OF WILLIAMSBURG, VIRGINIA, AS AMENDED. ALL STRUCTURE ARE COMPLETE.

AEB CONSULTING ENGINEERS
 BY: *[Signature]*
 G. T. WILSON, JR., C.E.

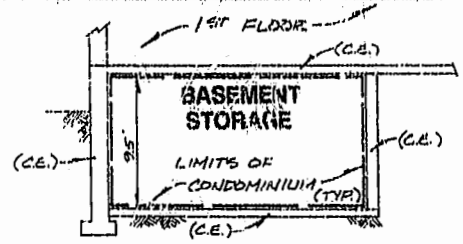

SECTION 8
 SCALE: 1" = 8'

AREA TABULATION - BASEMENT

BASEMENT STORAGE	372.40 SQ. FT.±
COMMON ELEMENT (C.E.) - WALLS, CHIMNEY & UTILITY ROOMS	2928.00 SQ. FT.±
CRAWL SPACE	3107.16 SQ. FT.±
TOTAL AREA BASEMENT	7505.56 SQ. FT.±

(C.E.) = COMMON ELEMENT

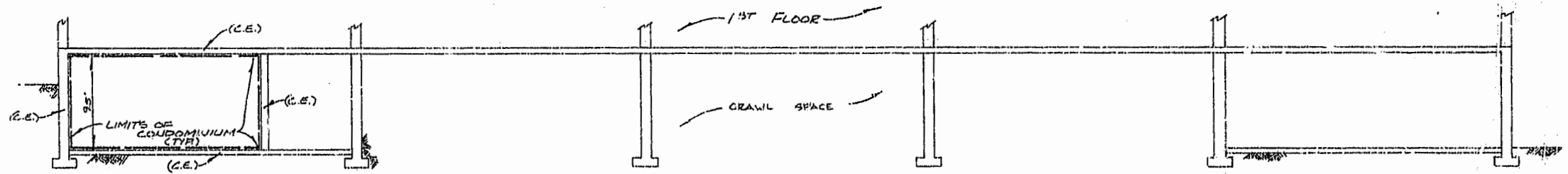

SECTION 7
 SCALE: 1" = 8'

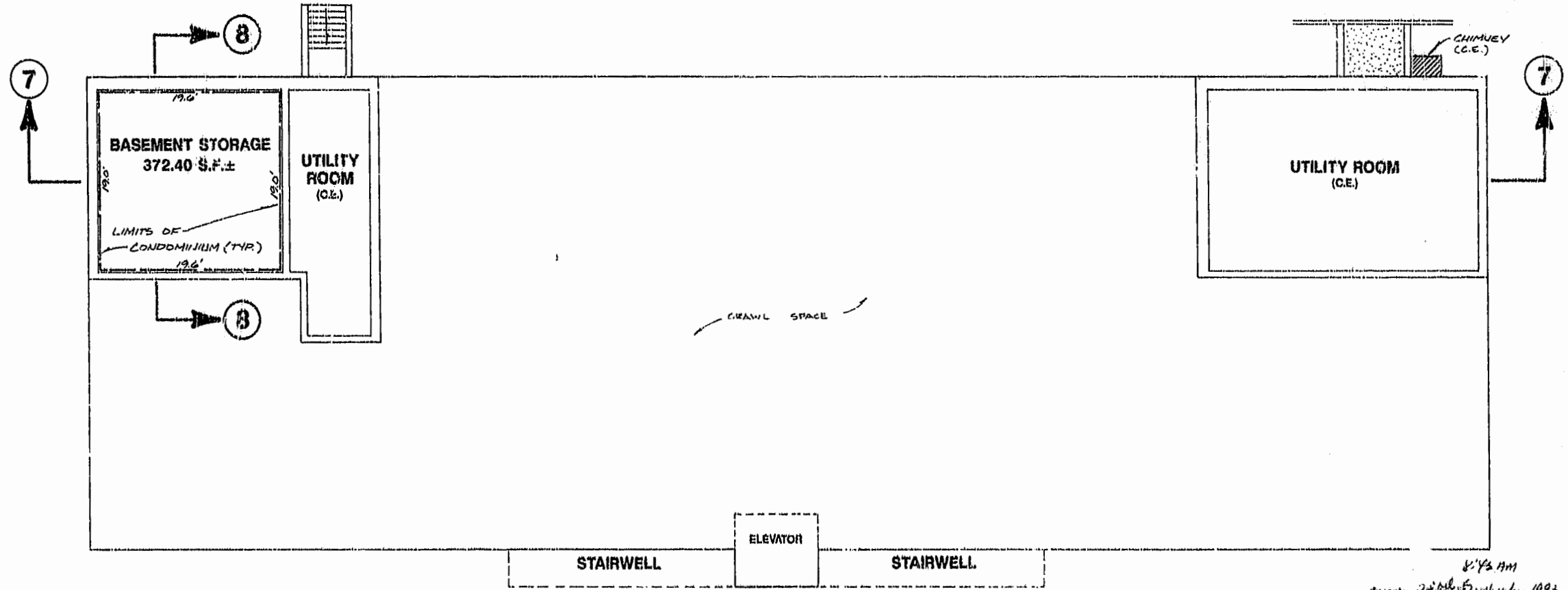

PLAN VIEW - BASEMENT
 SCALE: 1" = 8'

8 1/2 AM
 Revision of 11/23/91
 Drawing 105
[Signature] Clerk

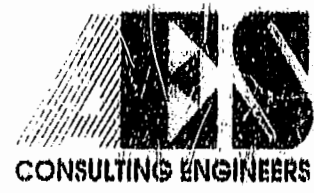

5248 Old Towne Road, Suite 1
 Williamsburg, Virginia 23188
 (804) 253-0040
 Fax (804) 220-8004

EXHIBIT B
WILLIAMSBURG PROFESSIONAL CENTRE CONDOMINIUMS
 OWNER/DEVELOPER: ALVIN P. ANDERSON, TRUSTEE
 CITY OF WILLIAMSBURG, VIRGINIA



NO.	DATE	REVISION / COMMENT / NOTE	BY

Designed AEB	Drawn RWE
Scale NOTED	Date 11/23/91
Project No. 7240	
Drawing No. 4 OF 4	