

POWHATAN CROSSING - SECTION III

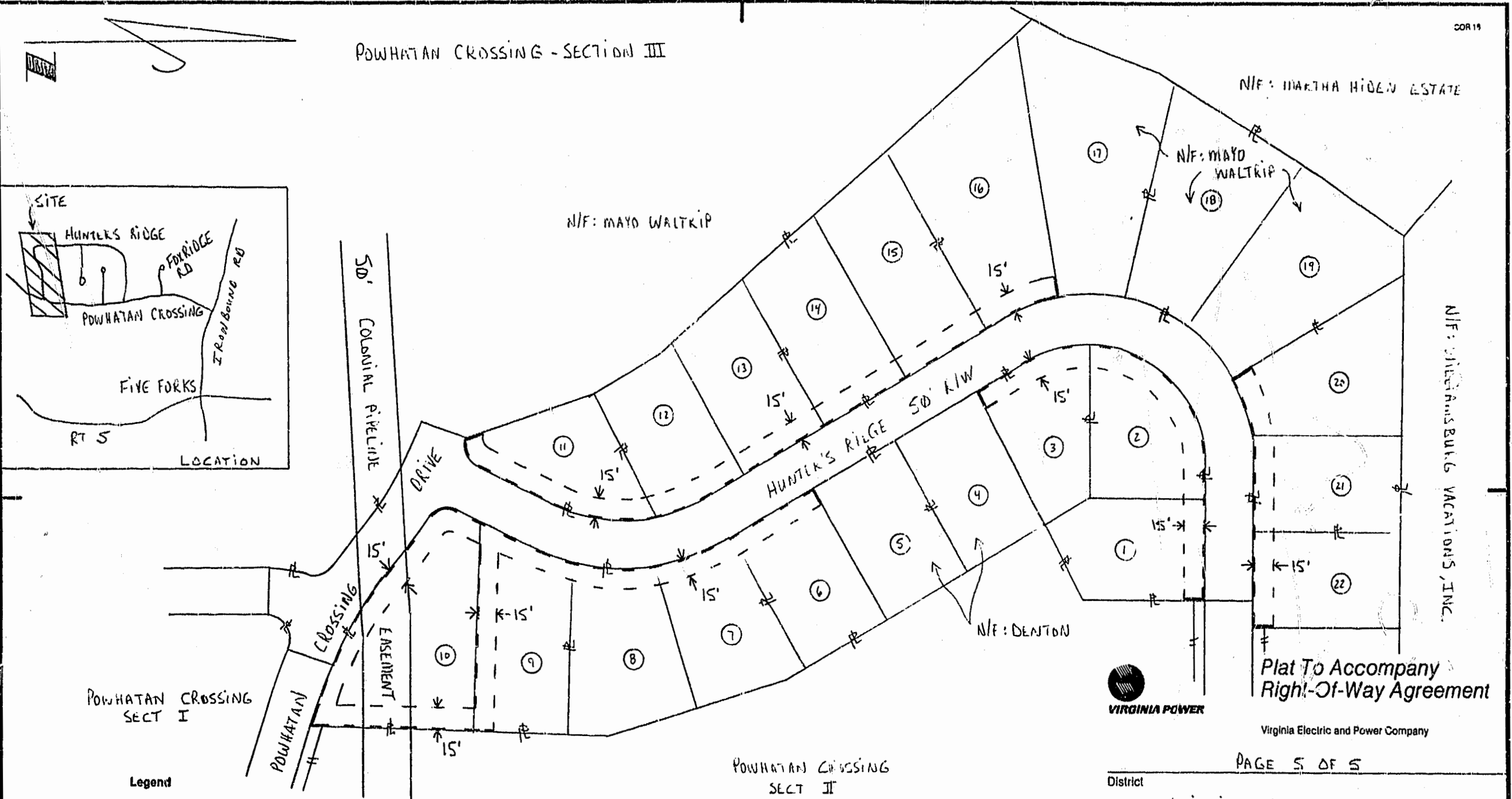
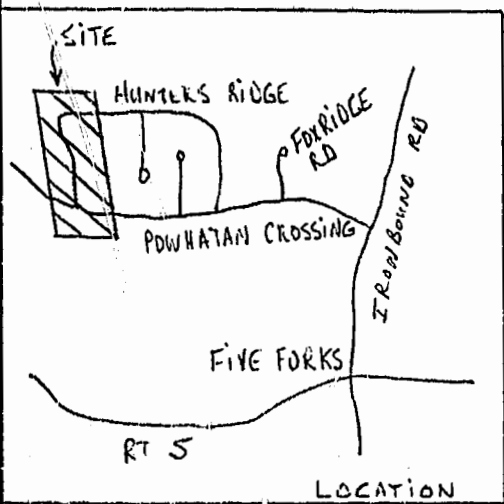

POWHATAN CROSSING SECT I

POWHATAN CROSSING SECT II

Legend

- Location Of Boundary Line Of Designated Right-of-Way 15' IN WIDTH.
- EXISTING VA POWER EASEMENT



Plat To Accompany Right-Of-Way Agreement

Virginia Electric and Power Company

PAGE 5 OF 5

District	WILLIAMSBURG UNDERGROUND		
District-Township-Borough	County-City	State	
Office	BERKELEY	JAMES CITY	VA.
Estimate Number	WILLIAMSBURG	Plat Number 28-93-0121	
	78-308-00080	Grid Number M1736	
Date	8-9-93	By <i>Michael W. Jones</i>	

RIGHT-OF-WAY ON PROPERTY OF:
 POWHATAN CROSSING, INC.
 C. LEWIS WALTRIP II, PRESIDENT
 OWNER'S INITIALS _____

11:08 Am
 Recorded ²⁷⁴ day of August, 1993
 in pages 498
 D & N 637
Debra M. ... Clerk