

NOTE: THE 12 PERIMETER LANDSCAPE POLES ALONG NORTHWEST & SOUTHWEST PROPERTY LINES CONTAIN AT LEAST 1 TREE SPECIES AT EACH END. THE TREES SHALL BE PLANTED IN 2" PINE MULCH BEDS. THE SPECIES OF PLANTS SHALL BE IDENTIFIED TO THE PROPERTY OWNER OR DEVELOPER PRIOR TO INSTALLATION. OWNER OR DEVELOPER AGREES TO MAINTAIN EACH SPECIES THAT IS REMOVED OR DAMAGED THROUGH NEGLIGENCE WITH ONE THAT MEETS THE MINIMUM HEIGHT REQUIREMENT.

NOTE: THE AREA SURROUNDING BLDG. 1, 2 & 3 IS HADED W/ MIXED PINES & HARDWOODS OF VARYING DIAMETERS.

NOTE: ALL IMPROVEMENTS FROM EXTERIOR WALLS OF BUILDING TO PROPERTY LINES ARE TO BE KNOWN AS COMMON ELEMENTS (INCLUDING CURBS & CUTTER, PAVING, SIDEWALKS, LANDSCAPING, ETC.)

NOTE: UNDERGROUND UTILITIES SERVING ADJACENT PROPERTIES ARE TO BE RECORDED AS BLANKET EASEMENTS

NOTE: ALL PAVED TRAVELWAYS & PARKING AREAS ARE TO BE RECORDED AS CROSS EASEMENTS FOR INGRESS AND EGRESS ON ADJACENT PROPERTIES

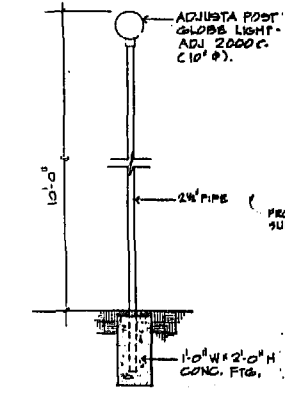
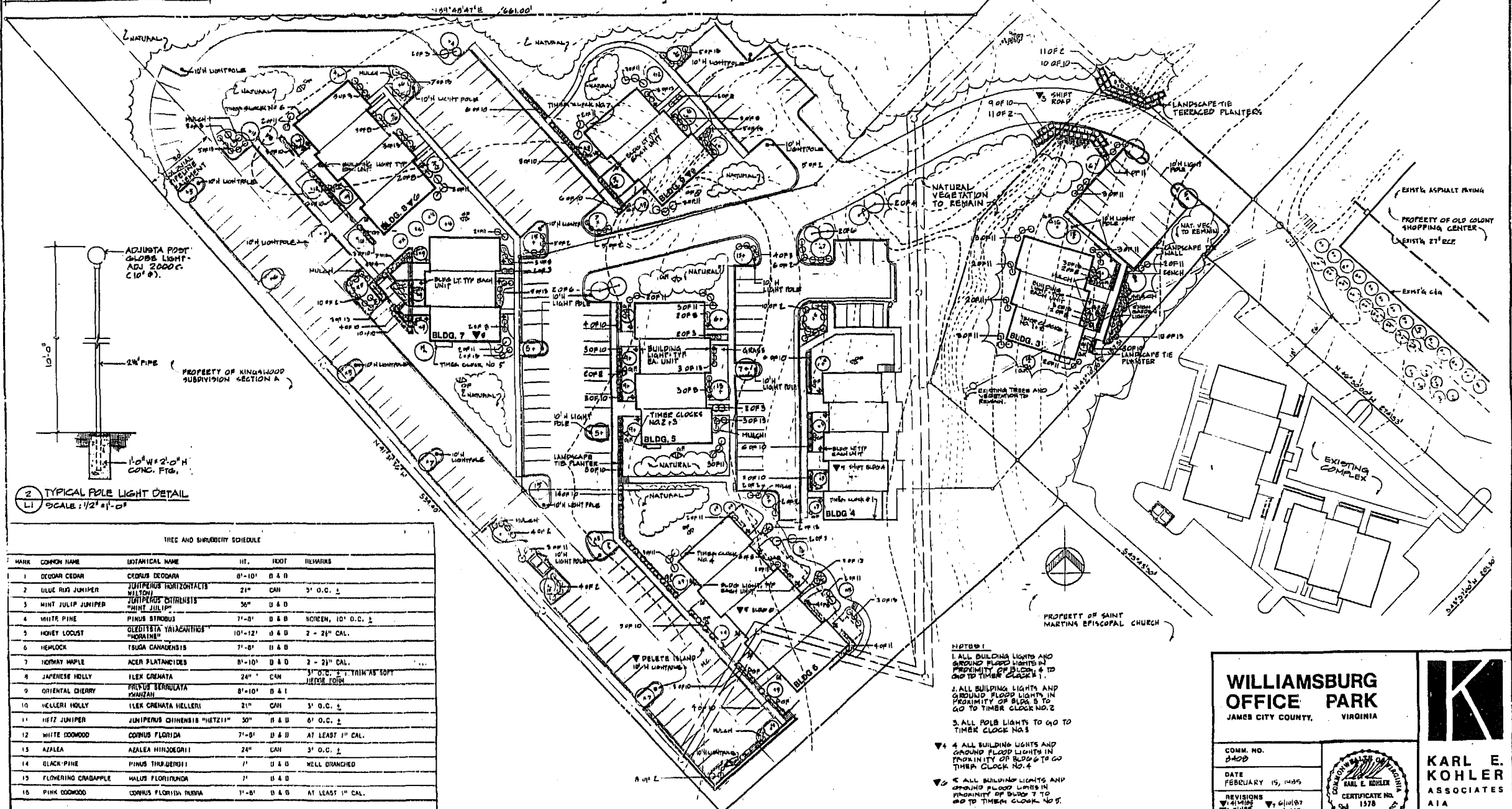

2 TYPICAL POLE LIGHT DETAIL  
L1 SCALE: 1/2" = 1'-0"

TREE AND SHRUBBURY SCHEDULE

MARK	COMMON NAME	BOTANICAL NAME	HGT.	TRUNK	REMARKS
1	DECOR CEDAR	CEDRUS DEODARA	8'-10'	D & B	
2	BLUE RING JUNIPER	JUNIPERUS HORIZONTALIS WILSONI	21"	CAH	3' O.C. ±
3	MINT JULIP JUNIPER	JUNIPERUS CHINENSIS "MINT JULIP"	50"	D & B	
4	WHITE PINE	PINUS STROBUS	7'-8'	D & B	SCREEN, 10' O.C. ±
5	HONEY LOCUST	GLYCOSTYA VARIAGANTICA "HONEYLOCUST"	10'-12'	D & B	2 - 2 1/2" CAL.
6	HEMLOCK	TSUGA CANADENSIS	7'-8'	D & B	
7	NORWAY MAPLE	ACER PLATANOIDES	8'-10'	D & B	2 - 2 1/2" CAL.
8	JAPANESE HOLLY	ILEX CREMATA	24"	CAH	3' O.C. ±. TRIM AS SOFT HERB. FORM
9	ORIENTAL CHERRY	PRUNUS PENSILVANICA "ORIENTAL CHERRY"	8'-10'	D & B	
10	HELLERI HOLLY	ILEX CREMATA HELLERI	21"	CAH	3' O.C. ±
11	HETZ JUNIPER	JUNIPERUS CHINENSIS "HETZ11"	30"	D & B	6' O.C. ±
12	WHITE DOGWOOD	CORNUS FLORIDA	7'-8'	D & B	AT LEAST 1" CAL.
13	AZALEA	AZALEA HINDOORII	24"	CAH	3' O.C. ±
14	BLACK PINE	PINUS STRAUBERII	7'	D & B	WELL BRANCHED
15	FLOWERING CRABAPPLE	MALUS FLORIBUNDA	7'	D & B	
16	PINK DOGWOOD	CORNUS FLORIDA PURPA	7'-8'	D & B	AT LEAST 1" CAL.

- LANDSCAPE NOTES:
- ALL CURBS TO BE PLANTED IN 2" PINE MULCH BEDS.
  - ALL DISTURBED AREAS TO BE SOO UNLESS OTHERWISE NOTED.
  - THIS SHEET IS INTENDED FOR LANDSCAPE USE ONLY.

THESE PLANS ARE ACCURATE & ARE IN COMPLIANCE WITH SECTION 88-79.88 CODE OF VIRGINIA, AS AMENDED

1 LANDSCAPING & LIGHTING PLAN  
L1 SCALE: 1" = 1'-0"

- NOTES:
- ALL BUILDING LIGHTS AND GROUND FLOOD LIGHTS IN PROXIMITY OF BLDG. 1 TO GO TO TIMBER CLOCK NO. 1
  - ALL BUILDING LIGHTS AND GROUND FLOOD LIGHTS IN PROXIMITY OF BLDG. 2 TO GO TO TIMBER CLOCK NO. 2
  - ALL POLE LIGHTS TO GO TO TIMBER CLOCK NO. 3
  - ALL BUILDING LIGHTS AND GROUND FLOOD LIGHTS IN PROXIMITY OF BLDG. 3 TO GO TO TIMBER CLOCK NO. 4
  - ALL BUILDING LIGHTS AND GROUND FLOOD LIGHTS IN PROXIMITY OF BLDG. 4 TO GO TO TIMBER CLOCK NO. 5
  - ALL BUILDING LIGHTS AND GROUND FLOOD LIGHTS IN PROXIMITY OF BLDG. 5 TO GO TO TIMBER CLOCK NO. 6
  - ALL BUILDING LIGHTS AND GROUND FLOOD LIGHTS IN PROXIMITY OF BLDG. 6 TO GO TO TIMBER CLOCK NO. 7

**WILLIAMSBURG OFFICE PARK**  
JAMES CITY COUNTY, VIRGINIA

COMM. NO. 8400

DATE FEBRUARY 15, 1989

REVISIONS:  
 1/11/89 7/6/1987  
 2/11/89 7/8/1987  
 3/11/89 7/8/1987  
 4/11/89 7/10/1989  
 5/11/89 7/11/89

THIS DRAWING IS THE PROPERTY OF KARL E. KOHLER ASSOCIATES, ARCHITECTS, AND IS NOT TO BE REPRODUCED OR USED FOR ANY PROJECT, IN WHOLE OR IN PART, WITHOUT THEIR EXPRESS WRITTEN PERMISSION.

**LANDSCAPING & LIGHTING PLAN**

**KARL E. KOHLER ASSOCIATES AIA ARCHITECTS**  
300 MAPLE AVENUE, WEST VIRGINIA, VIRGINIA 22800  
PHONE: (703) 281-0301  
PHONE: (703) 281-7870

**L1**

Recorded 131 Day of August 1989

485  
Helene Sward Clerk