

LCE = LIMITED COMMON ELEMENT

WE HEREBY CERTIFY THAT WE HAVE REVIEWED ALL OF THE UNITS OR PORTIONS THEREOF AND DO FURTHER CERTIFY THAT THESE PLANS ARE ACCURATE AND THEY COMPLY WITH SECTION 55-79.58 (B) OF THE CODE OF VIRGINIA AS AMENDED. ALL STRUCTURES ARE SUBSTANTIALLY COMPLETE.

AES, a professional corporation

Paul Small
PAUL C. SMALL, P.E., C.L.S.

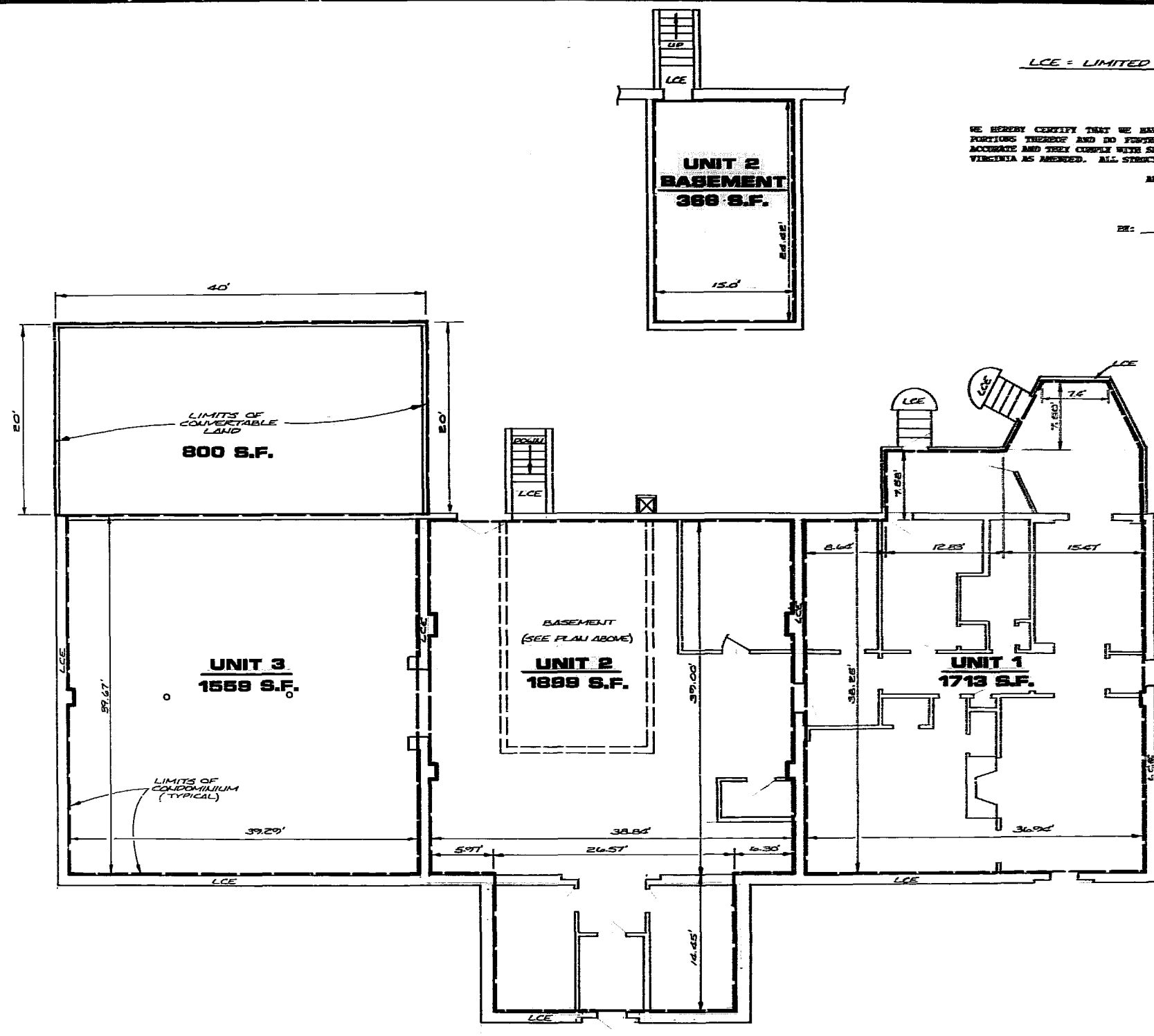

PLAN VIEW
SCALE: 1/8" = 1'-0"



AES, a professional corporation
5248 Olde Towne Road, Suite 1
Williamsburg, Virginia 23185
(804) 253-0040
Engineering, Planning, Surveying

**CONDOMINIUM PLAT
OF
WHITEHALL
UNITS 1, 2, & 3**
OWNER/DEVELOPER: MILLER PROPERTIES
JAMES CITY COUNTY VIRGINIA

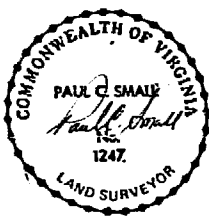

No.	DATE	REVISION / COMMENT / NOTE	BY

Designed	Drawn
Scale	Date
NOTED	JULY 28, 2009
Project No. 7043	
Drawing No. 2 of 3	

