

**ARCHITECT'S CERTIFICATE**

I HEREBY CERTIFY THAT TO THE BEST OF MY KNOWLEDGE AND BELIEF THAT CONSTRUCTION OF THE UNITS DEPICTED HEREON IS SUBSTANTIALLY COMPLETED AND THAT THIS PLAN IS ACCURATE, CORRECT IN COMPLIANCE WITH THE PROVISIONS OF SUBSECTION 55-79.5B (B), VA CODE ANNO. (1979 CUM SUPP.) GIVEN UNDER MY HAND THIS \_\_\_\_\_ DAY OF \_\_\_\_\_

STATE CERTIFIED ARCHITECT

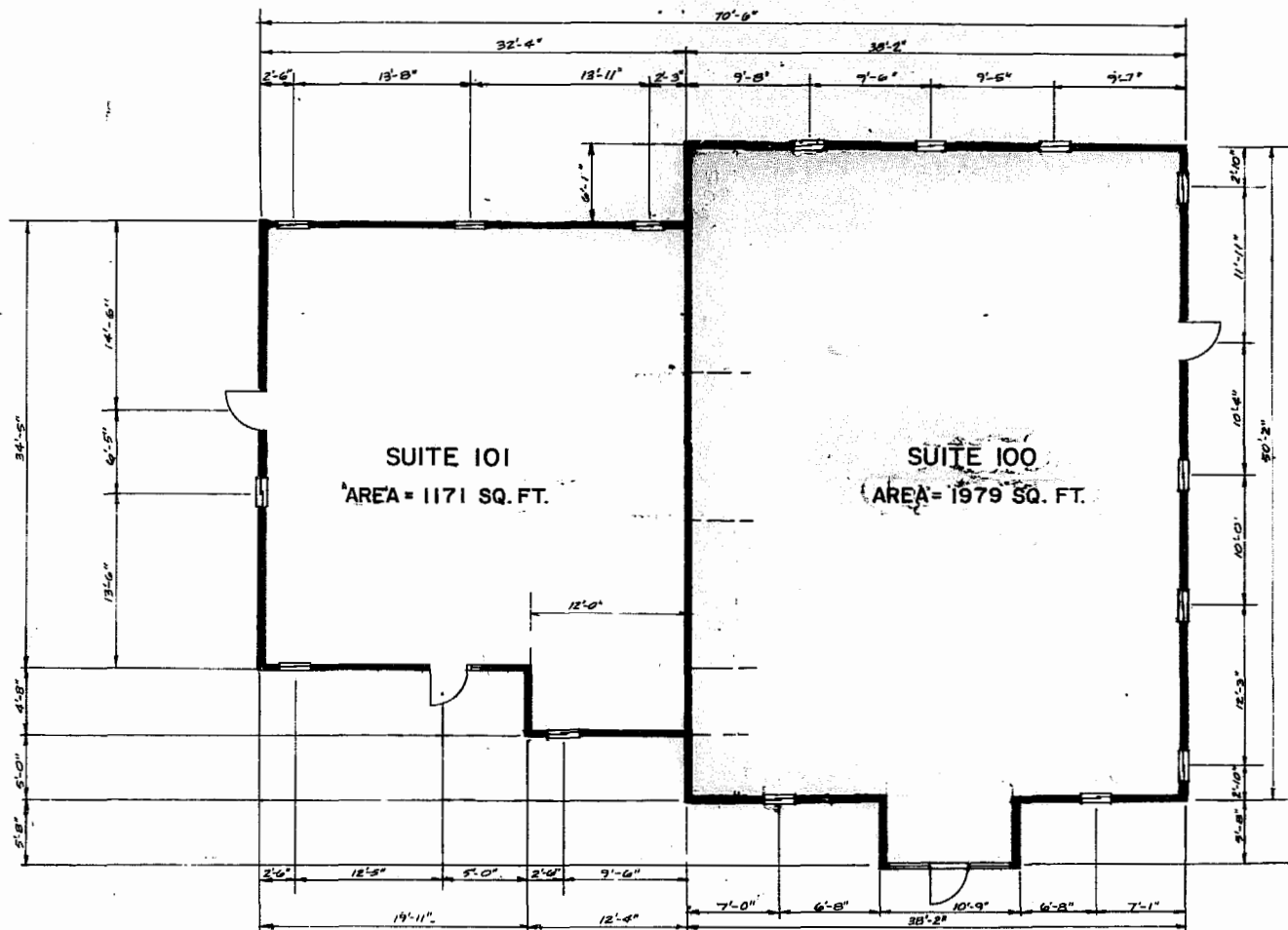

PHASE II  
**CHARTERTOWNE PROFESSIONAL CENTER**  
 BUSCH CORPORATE CENTER  
 JAMES CITY COUNTY, VIRGINIA

**OFFICE BUILDING 245**

**FLOOR PLAN**  
 1/8" = 1'-0"

3:51 p.m.  
 Recorded 23rd day of February, 1989  
 in 416  
 D.B. No. 416  
 Release Clerk

**LANGLEY & McDONALD**  
 CONSULTING ENGINEERS · PLANNERS · SURVEYORS  
 VIRGINIA BEACH & WILLIAMSBURG, VIRGINIA

**CARO · MONROE · LIANG**  
 ARCHITECTS

