

NOTE: THE 10' FEET LANDSCAPE STRIP ALONG THE ADJACENT SOUTHWEST PROPERTY LINES CONTAINS ALL LIGHTS TO BE INSTALLED. THE TREE TRUNKS SHALL BE PLANTED IN THE MIDDLE OF THE STRIP OR PLANTED IN A VARIETY OF SPACING. UNLESS OTHERWISE NOTED, ALL TREES SHALL BE PLANTED TO MEET REQUIREMENT. ALL TREES THAT IS REMOVED OR DAMAGED SHALL BE REPLACED WITH ONE THAT MEETS THE MINIMUM HEIGHT REQUIREMENT.

NOTE: THE AREA SURROUNDING BLDGS 7, 8, 9 IS HAUNDED W/ 1" RED PINES & WAKINWOODS OF VARYING DIAMETERS.

NOTE: ALL IMPROVEMENTS FROM EXTERIOR WALLS OF BUILDING TO PROPERTY LINES ARE TO BE KNOWN AS COMMON ELEMENTS (INCLUDING CURB & GUTTER, PAVING, SIDEWALKS, LANDSCAPING, ETC.)

NOTE: UNDERGROUND UTILITIES SERVING ADJACENT PROPERTIES ARE TO BE RECORDED AS BLANKET EASEMENTS

NOTE: ALL PAVED TRAVELWAYS & PARKING AREAS ARE TO BE RECORDED AS CROSS EASEMENTS FOR INGRESS AND EGRESS ON ADJACENT PROPERTIES

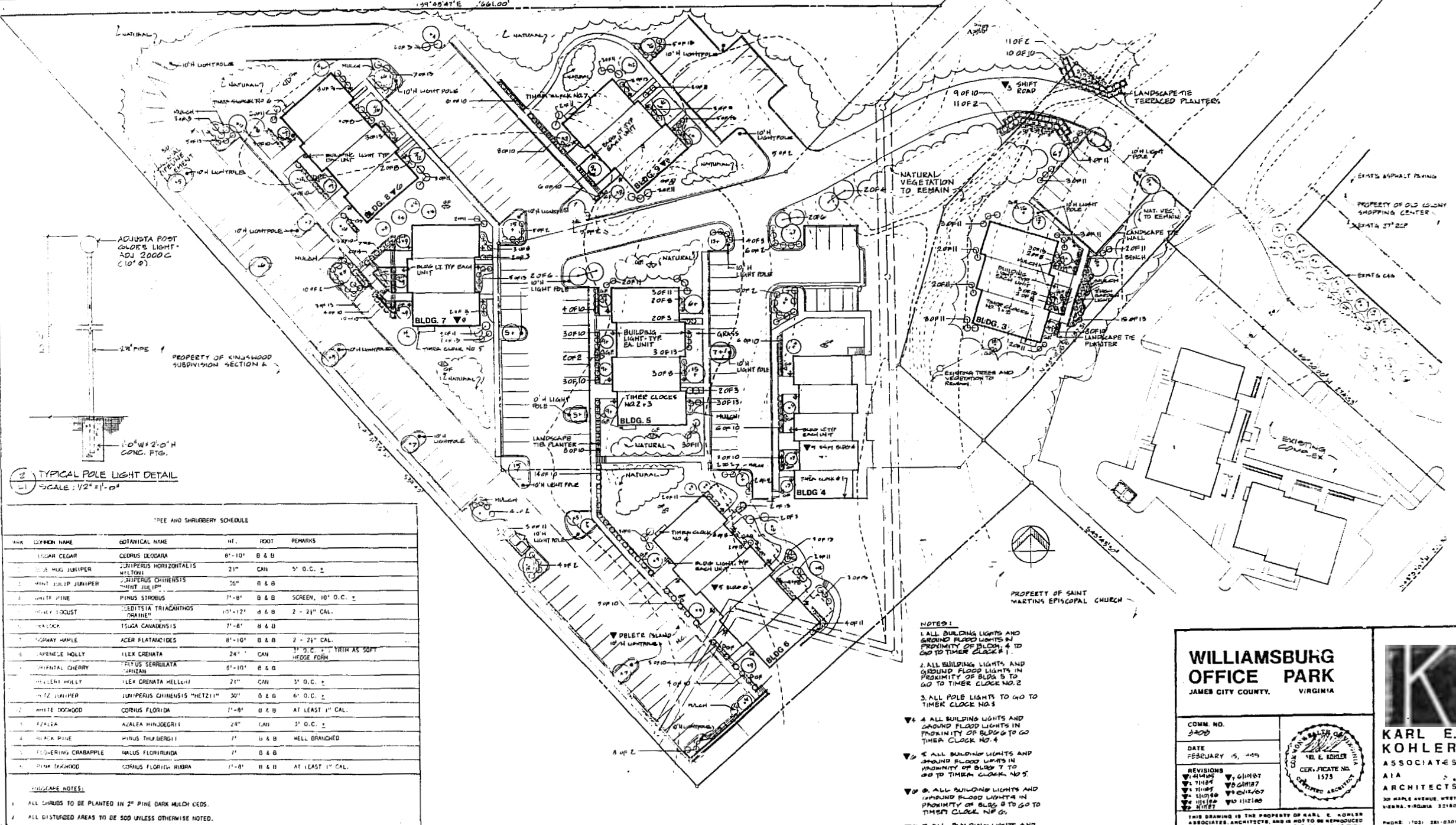

2 TYPICAL POLE LIGHT DETAIL  
SCALE: 1/2" = 1'-0"

TREE AND SHRUBBERY SCHEDULE

MARK	COMMON NAME	BOTANICAL NAME	HT.	FOOT	REMARKS
1	SUGAR CEDAR	CEDRUS CEDARA	8'-10'	B & B	
2	BLUE HOG JUNIPER	JUNIPERUS HORIZONTALIS	21"	CAN	5' O.C. ±
3	MINT JULEP JUNIPER	JUNIPERUS CHINENSIS	35"	B & B	
4	WHITE PINE	PINUS STROBUS	7'-8'	B & B	SCREEN, 10' O.C. ±
5	HONEY LOCUST	LEDISTIA TRIACANTHOS 'ORANGE'	10'-12'	d & B	2 - 21" CAL.
6	REARLOCK	ISOGA CANADENSIS	7'-8'	B & B	
7	ROADWAY MAPLE	ACER FLATLANDICES	8'-10'	B & B	2 - 21" CAL.
8	JAPANESE HOLLY	ILEX CRENATA	24"	CAN	3" O.C. ±; TRIM AS SOFT HEDGE FORM
9	ORIENTAL CHERRY	PALUS SERRULATA 'JANZAN'	8'-10'	B & B	
10	HOLLER HULLY	ILEX CRENATA HELLERII	21"	CAN	3' O.C. ±
11	WITZ JUNIPER	JUNIPERUS CHINENSIS 'WITZII'	30"	B & B	6' O.C. ±
12	WHITE DOGWOOD	CORNUS FLORIDA	7'-8'	B & B	AT LEAST 1" CAL.
13	AZALEA	AZALEA HINDJERGII	24"	CAN	3' O.C. ±
14	BLACK PINE	PINUS THURBERGII	7'	B & B	WELL BRANCHED
15	FLOWERING CRABAPPLE	MALUS FLORIFLORIDA	7'	B & B	
16	PINK DOGWOOD	CORNUS FLORIDA RUBRA	7'-8'	B & B	AT LEAST 1" CAL.

LANDSCAPE NOTES:  
 1. ALL SHRUBS TO BE PLANTED IN 2" PINE DARK MULCH DECS.  
 2. ALL DISTURBED AREAS TO BE SOO UNLESS OTHERWISE NOTED.  
 3. THIS SHEET IS INTENDED FOR LANDSCAPE USE ONLY.

THESE PLANS ARE ACCURATE & ARE IN COMPLIANCE WITH SECTION 55-70.58 CODE OF VIRGINIA, AS AMENDED  
 LANDSCAPING & LIGHTING PLAN  
 SCALE: 1" = 30'-0"

- NOTES:
- ALL BUILDING LIGHTS AND GROUND FLOOD LIGHTS IN PROXIMITY OF BLDG. 4 TO GO TO TIMER CLOCK NO. 1.
  - ALL BUILDING LIGHTS AND GROUND FLOOD LIGHTS IN PROXIMITY OF BLDG. 5 TO GO TO TIMER CLOCK NO. 2.
  - ALL POLE LIGHTS TO GO TO TIMER CLOCK NO. 3.
  - ALL BUILDING LIGHTS AND GROUND FLOOD LIGHTS IN PROXIMITY OF BLDG. 6 TO GO TO TIMER CLOCK NO. 4.
  - ALL BUILDING LIGHTS AND GROUND FLOOD LIGHTS IN PROXIMITY OF BLDG. 7 TO GO TO TIMER CLOCK NO. 5.
  - ALL BUILDING LIGHTS AND GROUND FLOOD LIGHTS IN PROXIMITY OF BLDG. 8 TO GO TO TIMER CLOCK NO. 6.
  - ALL BUILDING LIGHTS AND GROUND FLOOD LIGHTS IN PROXIMITY OF BLDG. 9 TO GO TO TIMER CLOCK NO. 7.

**WILLIAMSBURG OFFICE PARK**  
JAMES CITY COUNTY, VIRGINIA

COMM. NO. 3400 DATE FEBRUARY 15, 1985	
REVISIONS: 1. 4/11/85 2. 5/1/85 3. 5/1/85 4. 5/1/85 5. 5/1/85	

**KARL E. KOHLER ASSOCIATES AIA ARCHITECTS**  
 30 MAPLE AVENUE, WEST VIRGINIA, VIRGINIA 22180  
 PHONE (703) 281-0301  
 PHONE (703) 281-1870

**LANDSCAPING & LIGHTING PLAN**