

JAMESTOWN ROAD

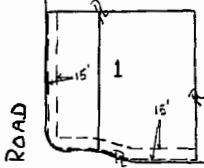

NIF WALSINGHAM ACADEMY, INC.

YORKSHIRE DRIVE

"THE WOODS"

OWNER  
BMT ASSOCIATES  
MERLE E. BOWLDS GEN. PARTNER



Plat To Accompany  
Right-Of-Way Agreement

Virginia Electric and Power Company

1 of 2

Legend

- Location Of Boundary Line Of Designated Right-of-Way
- == INDICATES PROPERTY LINE IS BOUNDARY OF RIGHT-OF-WAY

Recorded 21<sup>st</sup> day of July, 1988

D. B. No. 84 in pages 707

Robert Ward Clerk  
By: David C. Hart Depld

|                           |                     |            |                       |
|---------------------------|---------------------|------------|-----------------------|
| District                  | 1 of 2              |            |                       |
| <u>WILLIAMSBURG</u>       |                     |            |                       |
| District-Township-Borough | County-City         | State      |                       |
| <u>WILLIAMSBURG</u>       | <u>WILLIAMSBURG</u> | <u>VA.</u> |                       |
| Office                    | Plat Number         |            |                       |
| <u>WILLIAMSBURG</u>       | <u>28 88 0162</u>   |            |                       |
| Estimate Number           | Grid Number         |            |                       |
| <u>28 807 00146</u>       | <u>M1836</u>        |            |                       |
| Date                      | <u>7-20-1988</u>    | By         | <u>Robert C. Hart</u> |

NO 0256910  
Rev. A

