

CURVE DATA TABLE

CURVE NO.	DELTA	RADIUS	TANGENT	L'NGTH	CHORD BRG.
2	10°56'02"	1411.89'	135.13'	9.44'	S 86°51'08"E
3	10°24'24"	2893.01'	263.46'	525.46'	N 82°36'30"E

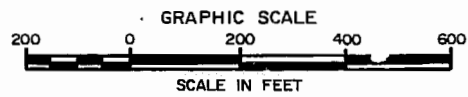
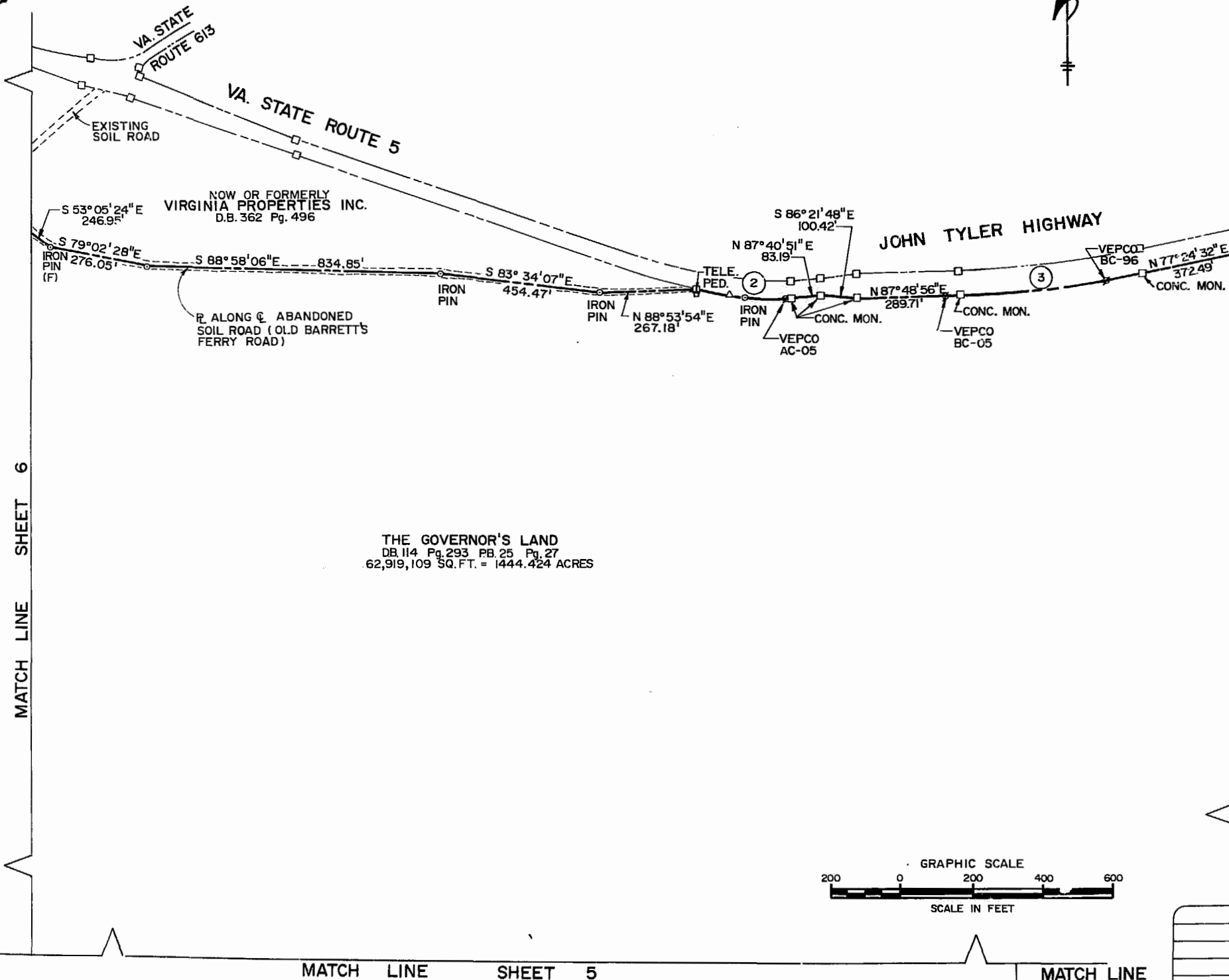

BENGTSON, DeBELL, ELKIN & TITUS, LTD.
ENGINEERS • SURVEYORS • PLANNERS • LANDSCAPE ARCHITECTS
104 BUSINESS PARK DRIVE, SUITE 203, VIRGINIA BEACH, VIRGINIA 23462
(804) 480-3368 (804) 877-5387

OFFICE LOCATIONS
• ANNE ARUNDEL COUNTY, MARYLAND
• HENRICO COUNTY, VIRGINIA
• PRINCE WILLIAM COUNTY, VIRGINIA
• VIRGINIA BEACH, VIRGINIA
• YORK COUNTY, VIRGINIA



BOUNDARY SURVEY
OF
THE GOVERNOR'S LAND
Located in James City County, Virginia
REFERENCE: DEED BOOK 114, PAGE 293
PLAT BOOK 25, PAGE 27

DATE:	08 JULY 1988
SCALE:	1" = 200'
DESIGNER:	W.K.
DRAWN:	B.W.
CHECK:	CHECK:
JOB NO.:	VB07572000
P.R. NO.:	
SHEET:	4 OF 10
FILE NO.:	

REVISIONS	DATE

T. A. 300-585-3332