

LEGEND

- IRON PIPE
- MANHOLE (M.H.)
- CLEANOUT (C.O.)
- FIRE HYDRANT (FH)
- W — WATER LINE
- SAN — SANITARY SEWER
- N/F NOW OR FORMERLY
- ⊠ ROCK BARRIER
- ▨ CONCRETE
- — — PROPERTY LINE
- — — SWALE

I HEREBY CERTIFY THAT THE SURVEY OF THE PROPERTY SHOWN HEREON WAS PERFORMED BY ME AT THE DIRECTION OF THE OWNER AND THAT THE TITLE LINES AND PHYSICAL IMPROVEMENTS ARE CORRECT AS SHOWN.

Charles R. Osborne
CERTIFIED LAND SURVEYOR

11/23/87
DATE

REVISED MARCH 9, 1988: UTILITY EASEMENTS TO BE DEDICATED TO JAMES CITY SERVICE AUTHORITY ADDED. AS-BUILT SEWER AND WATER DATA ADDED.



PHYSICAL SURVEY
OF
BERKELEY COMMONS SHOPPING CENTER
STANDING IN THE NAME OF
ALMAC LIMITED PARTNERSHIP
NOVEMBER 23, 1987 JAMES CITY COUNTY, VIRGINIA

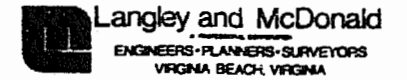

N/F WILLIAMSBURG MEMORIAL PARK INC.

N70°48'00"E 800.00'

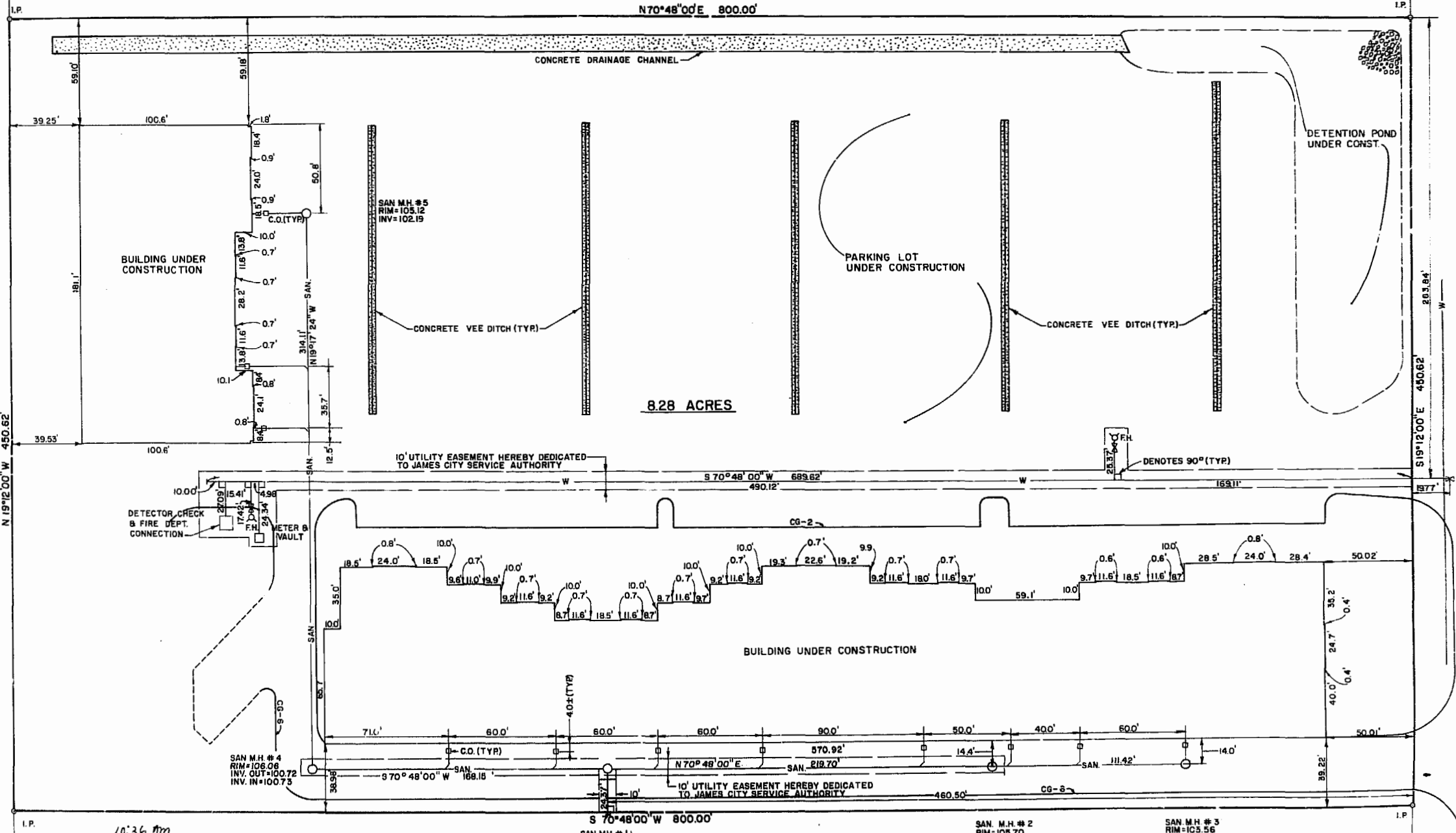

6.28 ACRES

N/F WILLIAMSBURG MEMORIAL PARK INC.

U.S. ROUTE 60 (160' R/W)

TO WILLIAMSBURG

10:36 am
Charles R. Osborne
11/23/87
W. S. Ward

N/F SVEIN J. LASSEN, TRUSTEE

SAN M.H. #1
RIM=108.29
INV.=100.07 W
INV.=100.11 E
INV.=100.089

SAN M.H. #2
RIM=108.70
INV. OUT=100.80
INV. IN=100.84

SAN M.H. #3
RIM=103.56
INV.=101.60

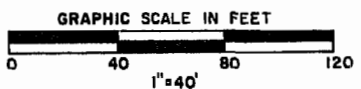

DUBINERS RECORDS CORPORATION

P.B.4 P. 70