

**SOURCE OF TITLE:**

TITLE TO PARCEL "A" WAS GRANTED BY DEED DATED JANUARY 19, 1972 AND RECORDED IN DEED BOOK 134, PAGE 758.  
 TITLE TO PARCEL "B" WAS GRANTED BY DEED DATED JULY 13, 1966 AND RECORDED IN DEED BOOK 108, PAGE 617 AT THE WILLIAMSBURG/JAMES CITY COUNTY COURTHOUSE AS REQUIRED BY LAW.

**NOTE: I HEREBY CERTIFY THE RESIDUE LANDS OF JAMES M. & VIOLA E. ANDERSON CREATED BY THIS BOUNDARY LINE ADJUSTMENT DOES NOT CREATE A SUBSTANDARD LOT, PARCEL OR TRACT OF LAND AND ARE IN ACCORDANCE WITH THE PROVISIONS OF THE SUBDIVISION ORDINANCE OF THE COUNTY OF JAMES CITY, VIRGINIA.**

SIGNED: Roger B. Spearman  
 DATE: JAN. 25, 1988

VICINITY MAP - SCALE: 1" = 2000'

**STATE OF VIRGINIA, COUNTY OF JAMES CITY:**

I, **RONALD W. EADE**, A NOTARY PUBLIC, DO HEREBY CERTIFY THAT THE PERSON(S) WHOSE NAME(S) IS (ARE) SIGNED TO THE WRITING BELOW HAS ACKNOWLEDGED THE SAME BEFORE ME IN MY COUNTY AFORESAID.

GIVEN UNDER MY HAND THIS 25<sup>TH</sup> DAY OF JANUARY, 1988.

SIGNED: Ronald W. Eade

MY COMMISSION EXPIRES: AUGUST 28, 1989

**OWNER'S CONSENT:**

THIS PLAT/PLAN IS WITH THE FREE CONSENT AND IN ACCORDANCE WITH THE WISHES AND DESIRES OF THE UNDERSIGNED OWNER(S).

James M. Anderson  
Viola E. Anderson

**CERTIFICATE OF APPROVAL:**

THIS PLAT/PLAN IS APPROVED BY THE UNDERSIGNED WITH EXISTING RELATIONS AND MAY BE COMMITTED TO RECORD.

AGENT OF APPROVING BODY: [Signature] DATE: 1/27/88

HEALTH OFFICER: \_\_\_\_\_ DATE: \_\_\_\_\_

HIGHWAY DEPARTMENT: \_\_\_\_\_ DATE: \_\_\_\_\_

**SURVEYOR'S CERTIFICATE:**

I HEREBY CERTIFY TO THE BEST OF MY KNOWLEDGE AND BELIEF THAT ALL THE REQUIREMENTS FOR THE PLATTING OF SUBDIVISIONS IN THE COUNTY OF JAMES CITY HAVE BEEN COMPLIED WITH.

ALSO, THAT THIS PLAT IS CORRECT AND COMPLIES WITH THE MINIMUM STANDARDS ESTABLISHED BY THE VIRGINIA STATE BOARD OF ARCHITECTS, PROFESSIONAL ENGINEERS, LAND SURVEYORS, AND CERTIFIED LANDSCAPE ARCHITECTS.

GIVEN UNDER MY HAND THIS 22ND DAY OF JAN. 1988.

**NOTE: RESIDUE OF PARCEL "A"**  
 SEE PLAT BOOK 29,  
 PAGE 17 & 18.

ISLAND OWNED BY  
JOHN R. BURCHAM  
 890.27'

**PARCEL "A"**  
 AREA NOW  
 351,666.5  $\phi$   
 OR 8.073 ACRES  
 FORMERLY  
 378,826.9  $\phi$   
 OR 8.697 ACRES  
 TAX MAP 12-1-1-18

**NEW PARCEL "B"**  
 43,963.1  $\phi$   
 OR  
 1.010 ACRES

**PARCEL "B-1"**  
 27,160.5  $\phi$   
 OR  
 0.624 ACRES

**PARCEL "B"**  
 16,822.6  $\phi$   
 OR 0.386 ACRES  
 (08 108, P. 622)  
 TAX MAP 12-1-1-19

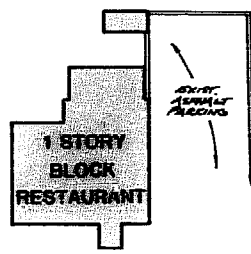

U. S. ROUTE #60 RICHMOND ROAD

**BOUNDARY LINE ADJUSTMENT**  
 ON PROPERTIES STANDING IN THE NAMES OF  
**JAMES M. & VIOLA E. ANDERSON**

LOCATED  
 JAMES CITY COUNTY, VIRGINIA

SCALE: 1" = 40'

DATE: JAN. 22, 1988



PREPARED BY  
**SPEARMAN & ASSOC., INC. - LAND SURVEYING**  
 P.O. BOX # 1244

WILLIAMSBURG, VIRGINIA - 23187  
 (804) 566 - 1310



3:19 p.m. Jan 1988  
 [Handwritten notes and signatures]