

**FIRST FLOOR**

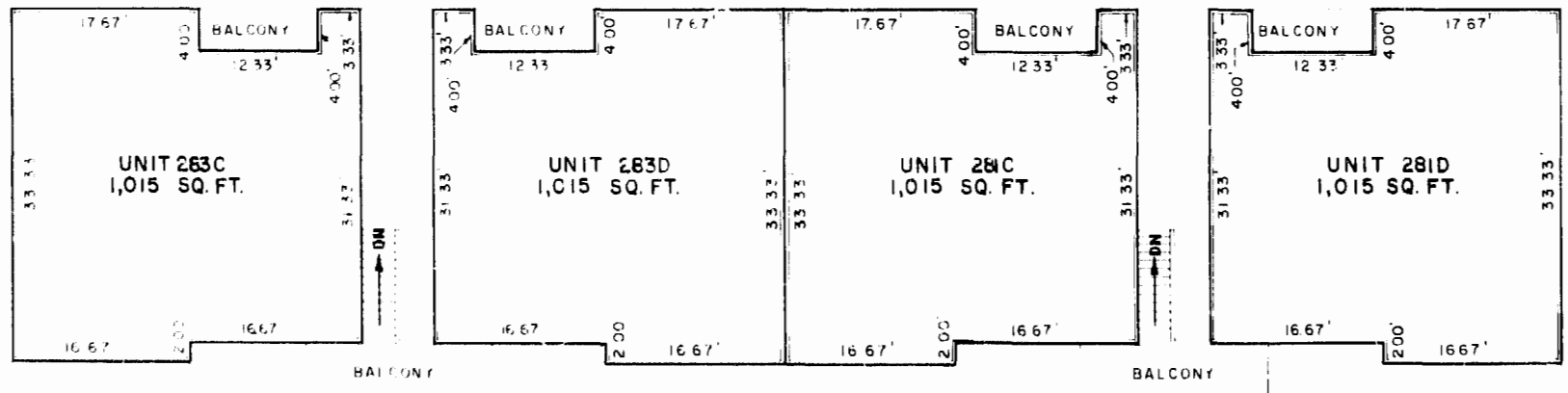

**SECOND FLOOR**

**BUILDING No. 283**

**BUILDING No. 281**

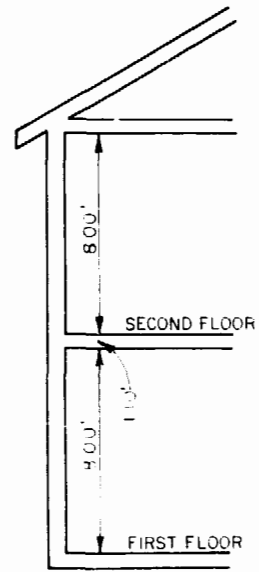

**BUILDING ELEVATIONS**  
N.T.S.

FOR FINISHED FLOOR ELEVATION OF PARTICULAR BUILDING SEE SHEET 1

CONDOMINIUM PLAN  
OF  
**BUILDING No.281 & BUILDING No.283**  
PATRIOT LANE CONDOMINIUM

WILLIAMSBURG VIRGINIA  
SCALE 1" = 10' NOVEMBER 11, 1987

MILLER-FOX-STEPHENSON PC  
ENGINEERS-SURVEYORS-PLANNERS  
204 GRAYSON ROAD, VIRGINIA BEACH, VA 23462

**CERTIFICATION:**  
"I, THE UNDERSIGNED ENGINEER HEREBY CERTIFY THAT THIS PLAN IS ACCURATE AND COMPLIES WITH SECTION 55-79.58(b) OF THE CODE OF VIRGINIA AND ALL UNITS DEPICTED HEREON HAVE BEEN SUBSTANTIALLY COMPLETED."

SIGNED: *[Signature]* DATE: *5/16/87*

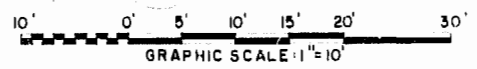

NOTE DIMENSIONS SHOWN ARE ON FINISHED SURFACES AND MAY VARY ± 2"  
DIMENSIONS SHOWN BASED ON ARCHITECTURAL PLANS PROVIDED BY THE DEVELOPER

