

NOTE:

ALL IMPROVEMENTS FROM EXTERIOR WALLS OF BUILDING TO PROPERTY LINES ARE TO BE KNOWN AS COMMON ELEMENTS (INCLUDING CURB & GUTTER, PAVING, SIDEWALKS, LANDSCAPING, ETC.)

NOTE:

UNDERGROUND UTILITIES SERVING ADJACENT PROPERTIES ARE TO BE RECORDED AS CROSS EASEMENTS FOR INGRESS AND EGRESS ON ADJACENT PROPERTIES

NOTE:

ALL PAVED TRAVELWAYS & PARKING AREAS ARE TO BE RECORDED AS CROSS EASEMENTS FOR INGRESS AND EGRESS ON ADJACENT PROPERTIES

NOTE: 2' MIN. OF COVER SHALL BE MAINTAINED OVER SEWER LINE

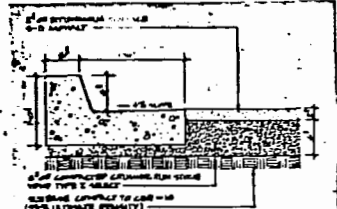

2 CURB & GUTTER AND PAVING DETAILS
SCALE: N.T.S.

TABLE 1: SUMMARY OF BUILDING DATA

Building No.	Area (sq. ft.)	Volume (cu. ft.)	Height (ft.)	Notes
Building No. 6	11,322	10,258	30	
Building No. 7	7,400	6,144	23	
Building No. 8	9,900	7,987	32	
Building No. 9	7,400	6,144	23	

TABLE 2: PROPOSED CONCRETE

Building No.	Foundation	Slab	Other
Building No. 6	3,740	1,210	1,210
Building No. 7	2,470	820	820
Building No. 8	3,110	1,030	1,030
Building No. 9	2,470	820	820

THESE PLANS ARE ACCURATE & ARE IN COMPLIANCE WITH SECTION 55-79.58 CODE OF VIRGINIA, AS AMENDED



1 SITE & GRADING PLAN
SCALE: 1" = 50'-0"

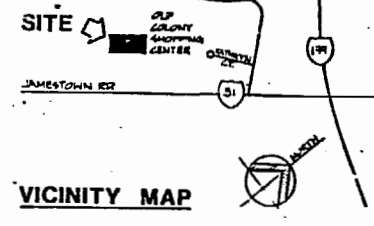
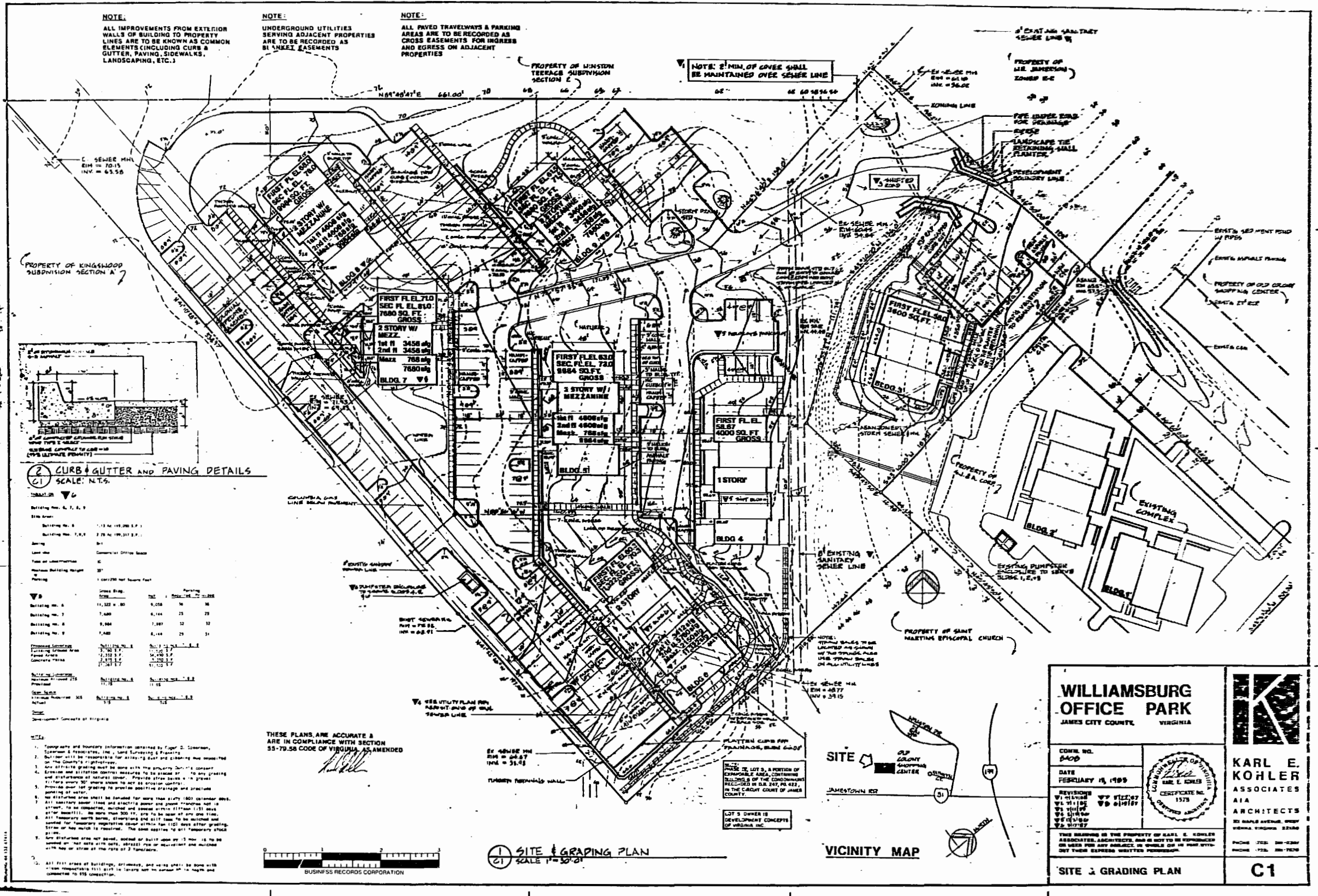

VICINITY MAP

WILLIAMSBURG OFFICE PARK
JAMES CITY COUNTY, VIRGINIA

CONTRACT NO. 8408
DATE: FEBRUARY 15, 1989

REVISIONS:
 W1 11/88
 W2 11/88
 W3 11/88
 W4 11/88
 W5 11/88
 W6 11/88

THIS DRAWING IS THE PROPERTY OF KARL E. KOHLER ASSOCIATES, ARCHITECTS, and is NOT TO BE REPRODUCED OR USED FOR ANY PURPOSE, IN WHOLE OR IN PART WITHOUT THEIR EXPRESS WRITTEN PERMISSION.

KARL E. KOHLER ASSOCIATES
AIA ARCHITECTS
800 BATTLE AVENUE, SUITE 22100
VIRGINIA BEACH, VIRGINIA 23462
PHONE: (757) 381-2300
FAX: (757) 381-7670

C1