

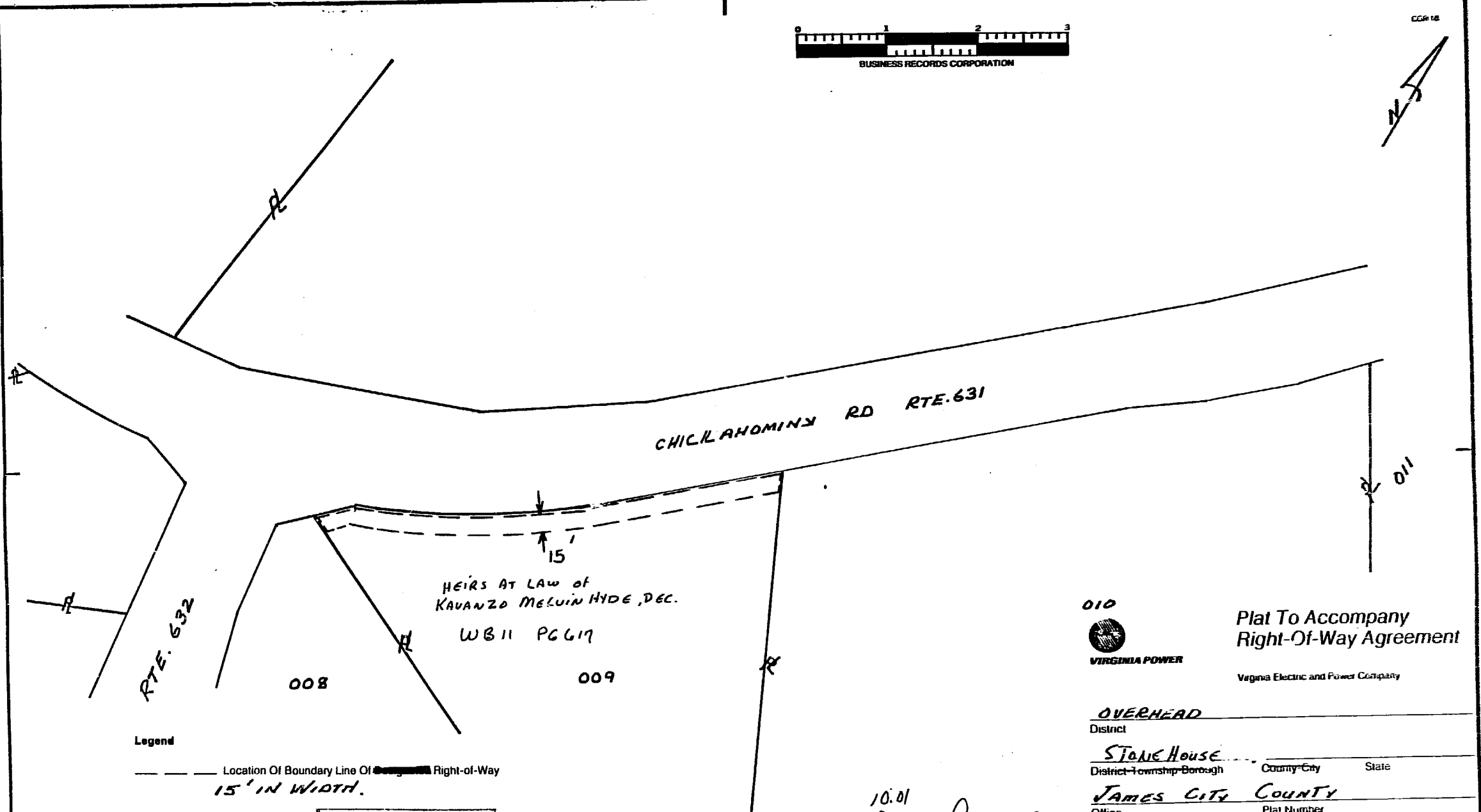

CGR 18



**Legend**

----- Location Of Boundary Line Of ~~Property~~ Right-of-Way  
15' IN WIDTH.

OWNER'S INITIALS  
*[Handwritten Signature]*

010



VIRGINIA POWER

**Plat To Accompany  
Right-Of-Way Agreement**

Virginia Electric and Power Company

**OVERHEAD**

District	STONE HOUSE	
District-Township-Borough	County-City	State
Office	JAMES CITY COUNTY	
Estimate Number	Plat Number	
2804469000	28-87-0008	
Date	Grd Number	
7-13-87	711640	
	By	<i>[Handwritten Signature]</i>

10.01  
Recorded *2644* day of *August* 1987  
in *732*  
B. B. No. *359* *732*  
*Halasa C. Ward* Clerk  
*By Dawn B. Hart* Dep. Clerk