

WINDSOR ESTATES
N/F POYNTER

WINDSOR FOREST
SECTION 15

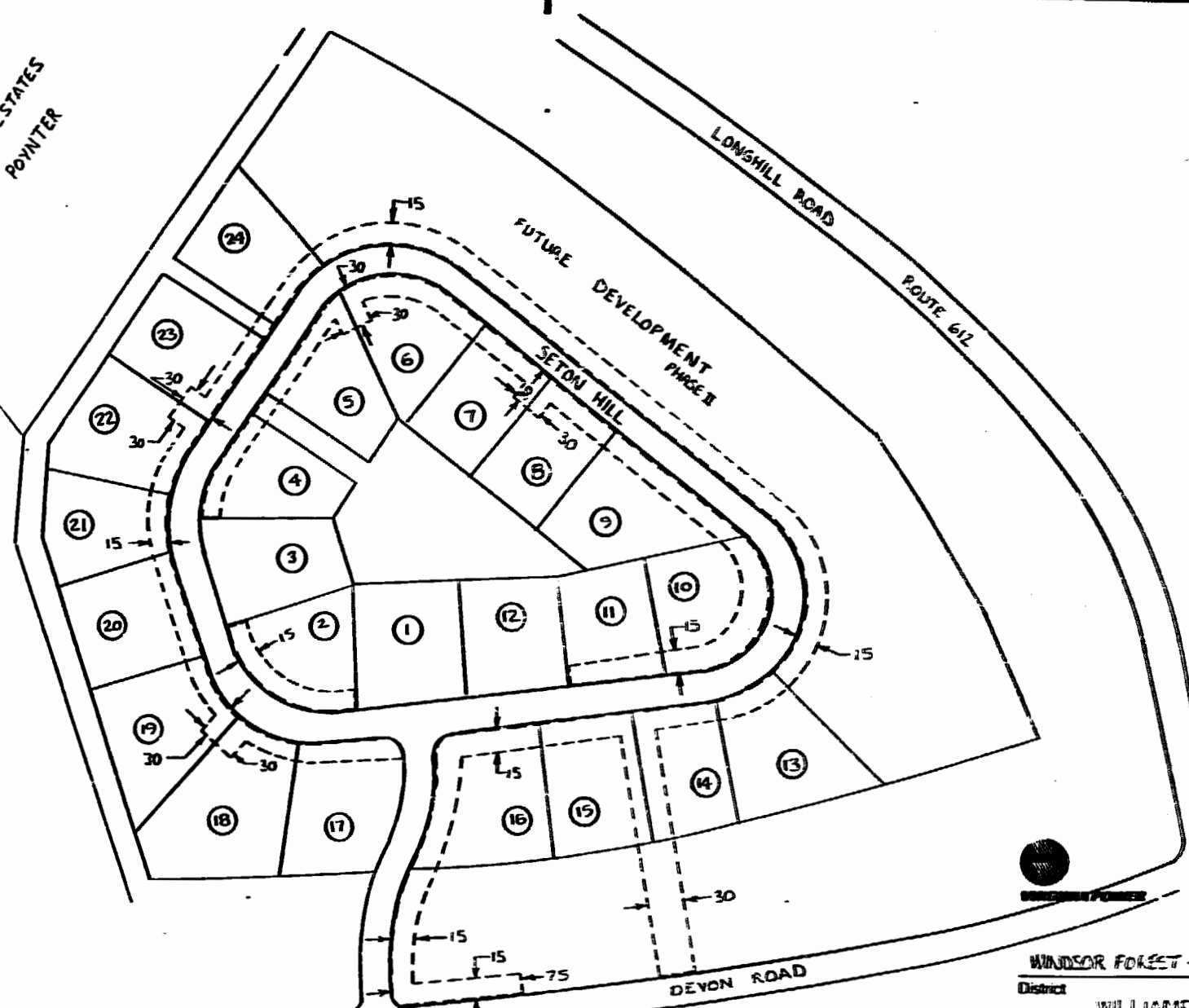

**Plat To Accompany
Right-Of-Way Agreement**

Virginia Electric and Power Company
UNDERGROUND

WINDSOR FOREST - SECTION 17 - PHASE I

District	WILLIAMSEURG	
District-Township-Borough	County-City	State
BERKLEY	JAMES CITY	VIRGINIA

Office	Plat Number
WILLIAMSEURG	R/W 25-86-6077

Estimate Number	Grid Number
28-344566-00	M1735

Date 2-3-87 By Robert K. Keplert

- Legend**
- Location Of Boundary Line Of Designated Right-of-Way WIDTHS AS SHOWN
 - INDICATES PROPERTY LINE IS RIGHT-OF-WAY BOUNDARY

OWNER: HERITAGE DEVELOPMENT CO.

Robert S. Hornsby
President

1:25 p.m.
Recorded 24th day of March 1987
D. B. No. 335 page 206
Released Under Court Order
By Dawn R. Travis, Dep. Clerk

WINDSOR WAY
WINDSOR FOREST
SECTION 16

