

COR 15

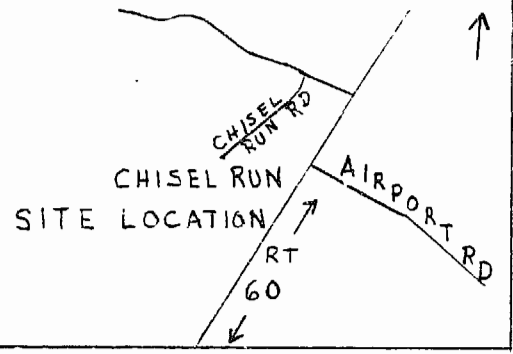

N/F  
KING & QUEEN CORP.

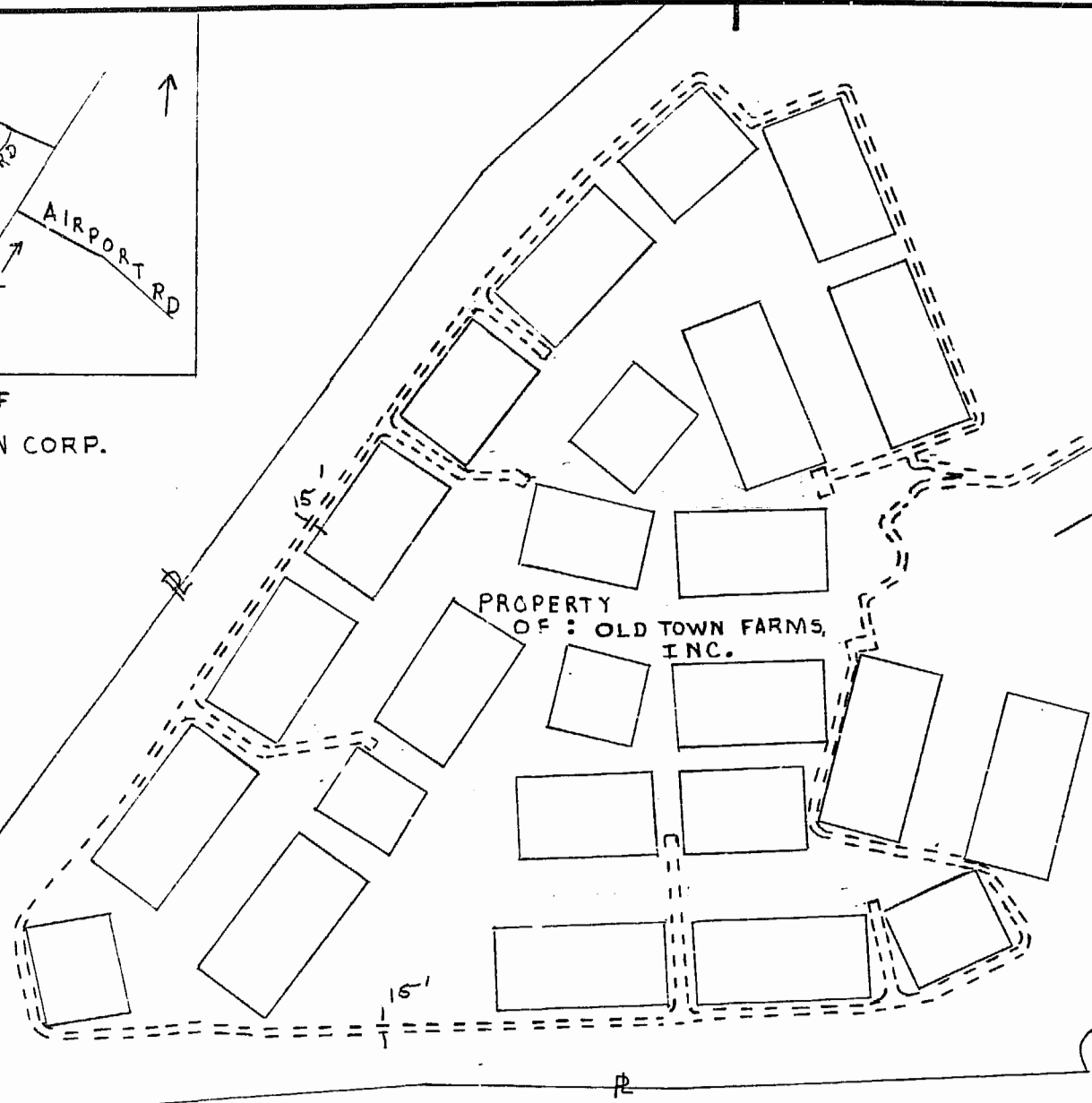

NOTES: ALL UNDERGROUND RIGHT-OF-WAY 15 FT WIDE AND SET 5 FT MIN FROM EXISTING INDIVIDUAL PROPERTY LINES



Plat To Accompany Right-Of-Way Agreement

Virginia Electric and Power Company

LEGEND --- Location Of Boundary Line Of Designated Right-of-Way 15' IN WIDTH.

WILLIAMSBURG		
District		
JAMES CITY COUNTY		VIRGINIA
District-Township-Borough	County-City	State
WILLIAMSBURG 28-87-0040		
Office		Plat Number
28-044331-00		M1838
Estimate Number		Grid Number
1/30/87	Robert M Lane	
Date	By	

11:16 Am.  
Recorded 1944 day of February, 1987 N/F  
in THOMAS D. MAHONE &  
B. B. No. 330 pages 841 J. WARBURTON  
Hester Swanson Clerk

No 97556910 Rev A

