

WENGER LAND TRUST
237/85

CHESAPEAKE
CORPORATION
OF VIRGINIA

REMAINDER ALABAMA CO

WENGER LAND
TRUST

REMAINDER ALABAMA CO.

CHESAPEAKE
CORPORATION
OF VIRGINIA

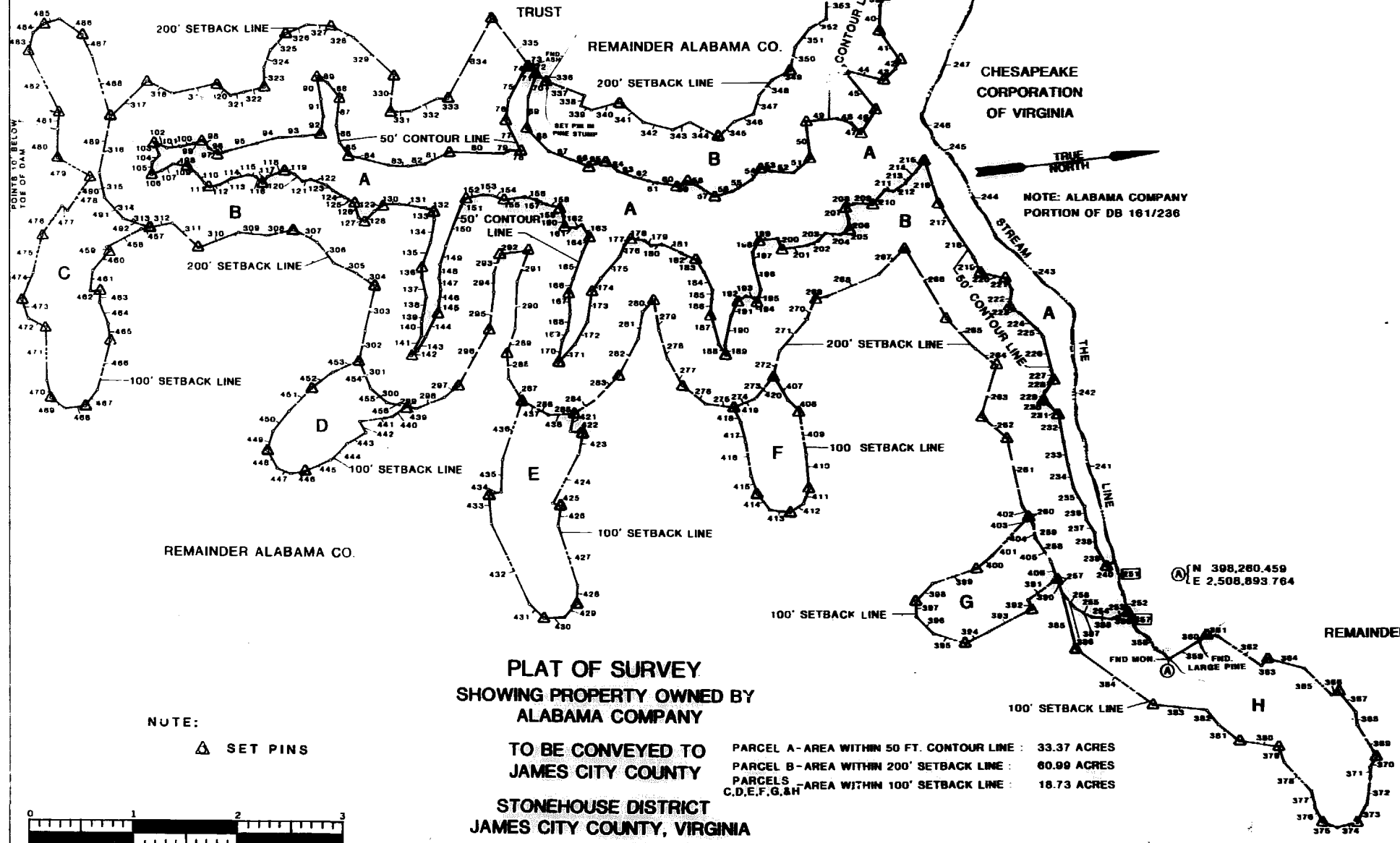

NOTE: ALABAMA COMPANY
PORTION OF DB 161/236

N 398,260.459
E 2,508,893.764

1221 p.m.
1444 Oct. 1976
317 139
Helene Stewart

**PLAT OF SURVEY
SHOWING PROPERTY OWNED BY
ALABAMA COMPANY**

**TO BE CONVEYED TO
JAMES CITY COUNTY
STONEHOUSE DISTRICT
JAMES CITY COUNTY, VIRGINIA**

PARCEL A - AREA WITHIN 50 FT. CONTOUR LINE : 33.37 ACRES
PARCEL B - AREA WITHIN 200' SETBACK LINE : 60.99 ACRES
PARCELS C, D, E, F, G, & H - AREA WITHIN 100' SETBACK LINE : 18.73 ACRES

NOTE:
▲ SET PINS



APPROVED TO SHOW		DATE	
BY		DATE	
BUCHART-BORN, INC. Consulting Engineers & Planners			
<small>INCORPORATED IN VIRGINIA</small> <small>1000 N. BRIDGES BLVD., SUITE 100, RICHMOND, VA 23220</small> <small>PHONE: (804) 353-1100</small>			
NO. 1	DATE 1/15/76	SCALE 1" = 200'	SHEET 1 OF 2